



A303 Section 1

For TM arrangements see drawing 100378.ENU.GEN-TM122 details H and G.

EASTBOUND CLOSURE A345 - A338

(Countess to Parkhouse)

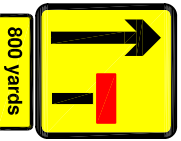
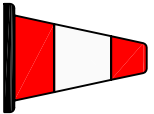
Diversion Route Symbol	Action Points	Contents of Shed - Sign shed at Countess roundabout
	Step 1:- Open flap sign A303 EB MP 132/3	 2 x Road closed 1 x Road closed ahead 1 x Diversion 1 x Diverted traffic 1 x Diversion ends 20 x cones 750mm
	Step 2:- Open flap sign A303 EB MP 131/5	
	Step 3:- Open flap sign A303 EB MP 131/0	
	Step 4:- Open flap sign A303 EB MP 130/9 (double flaps; ensure correct symbol is shown)	
	Step 5:- Open flap sign A303 EB MP 130/8 (double flaps; ensure correct symbol is shown)	
	Step 6:- Open flap sign A345 SB towards Amesbury at Woodhenge	
	Step 7:- Open flap sign A345 NB Countess roundabout (ensure correct symbol is shown)	
	Step 8:- Open flap sign on Porton Road, Solstice Park.	
		
MP 131/2	MP 130/4	MP 129/6

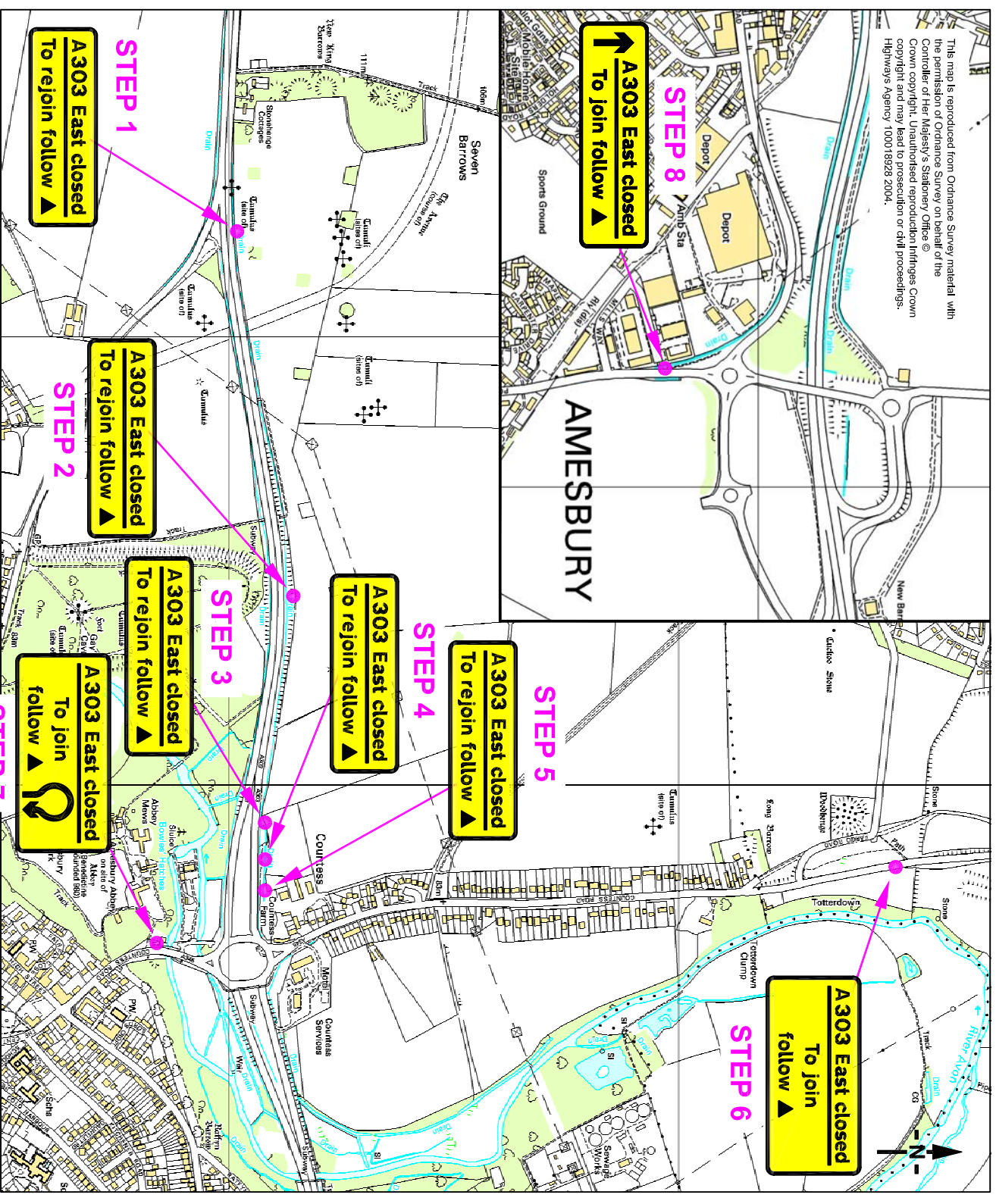
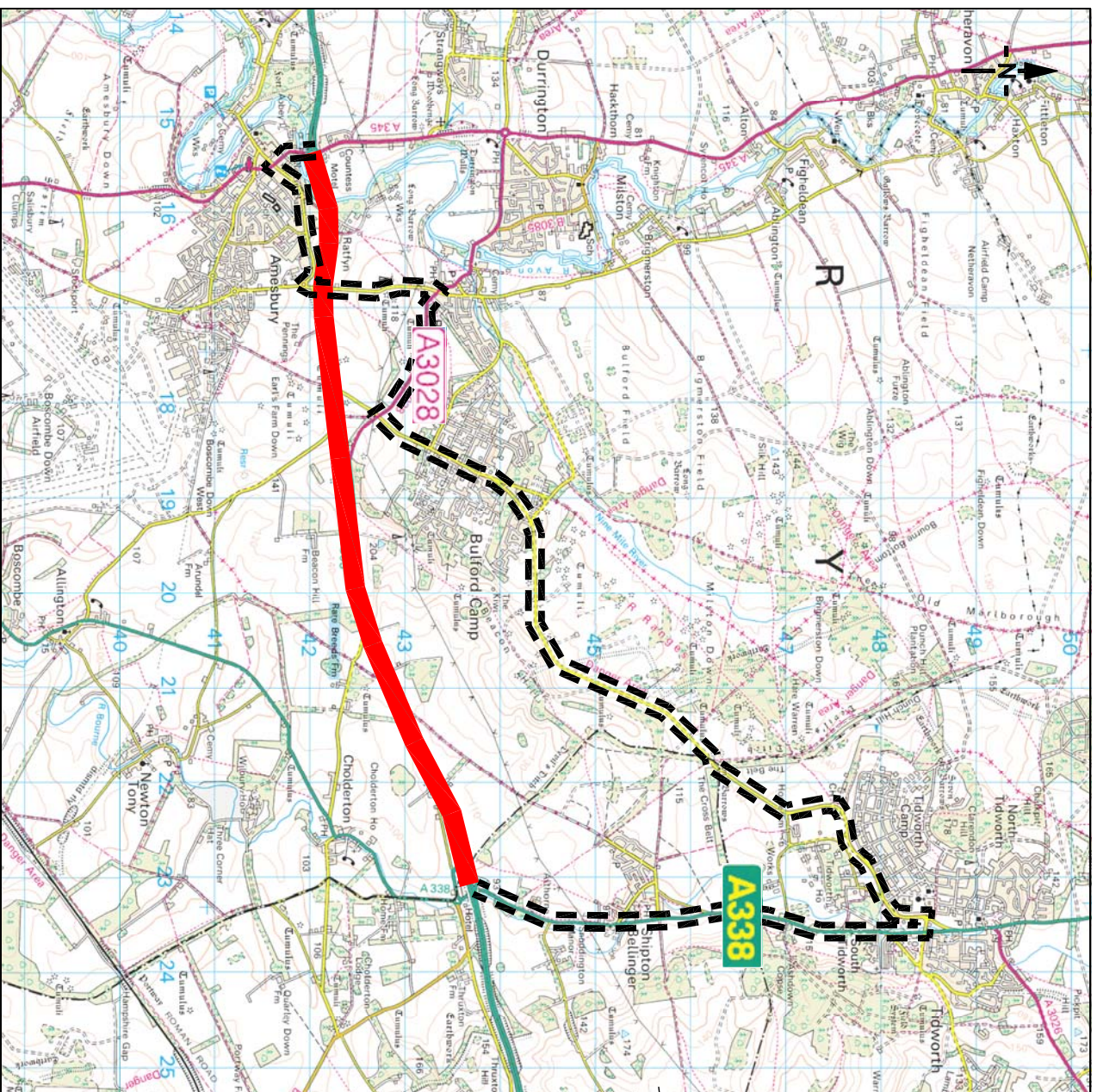

A3

This route has been agreed as the preferred option by the following parties during 2008.
Highways Agency, BMM, Hampshire County Council and Wiltshire County Council.