

Deposit of Statement and Plan

Section 31(6), Highways Act 1980

To Hampshire County Council:

- 1 Hampshire County Council is and has been since 28 April 1972 and 14 June 1972 the owner within the meaning of the above section of the land known as Land adjoining Swanmore Primary School, Church Road, Swanmore more particularly delineated on the plan no. E/5/206/A accompanying this statement and thereon shown coloured in pink.
- 2 I am Nigel Winston Whiteman, Principal Land Agent, and have authority to deal with land ownership matters on behalf of the Hampshire County Council.
- 3 The aforementioned land lies in the Parish of Swanmore.
- 4 The ways coloured purple on the said plan have been dedicated as footpaths.
- 5 No other ways over the land have been dedicated as highways.
- 6 The deposit shall comprise this statement and accompanying plan.

Signed:

.....
for and on behalf of Hampshire County Council

Name (landowner): Hampshire County Council

Address: The Estates Practice
The Castle
Winchester
SO23 9DS

Date:

28th October 1999

Signed (witness):

Name (witness):

S.W. CUMMINGS

Address:

Aberlady 24 Hoe Lane
North Baddesley Hants SO52 9NH

Occupation:

Building Surveyor.

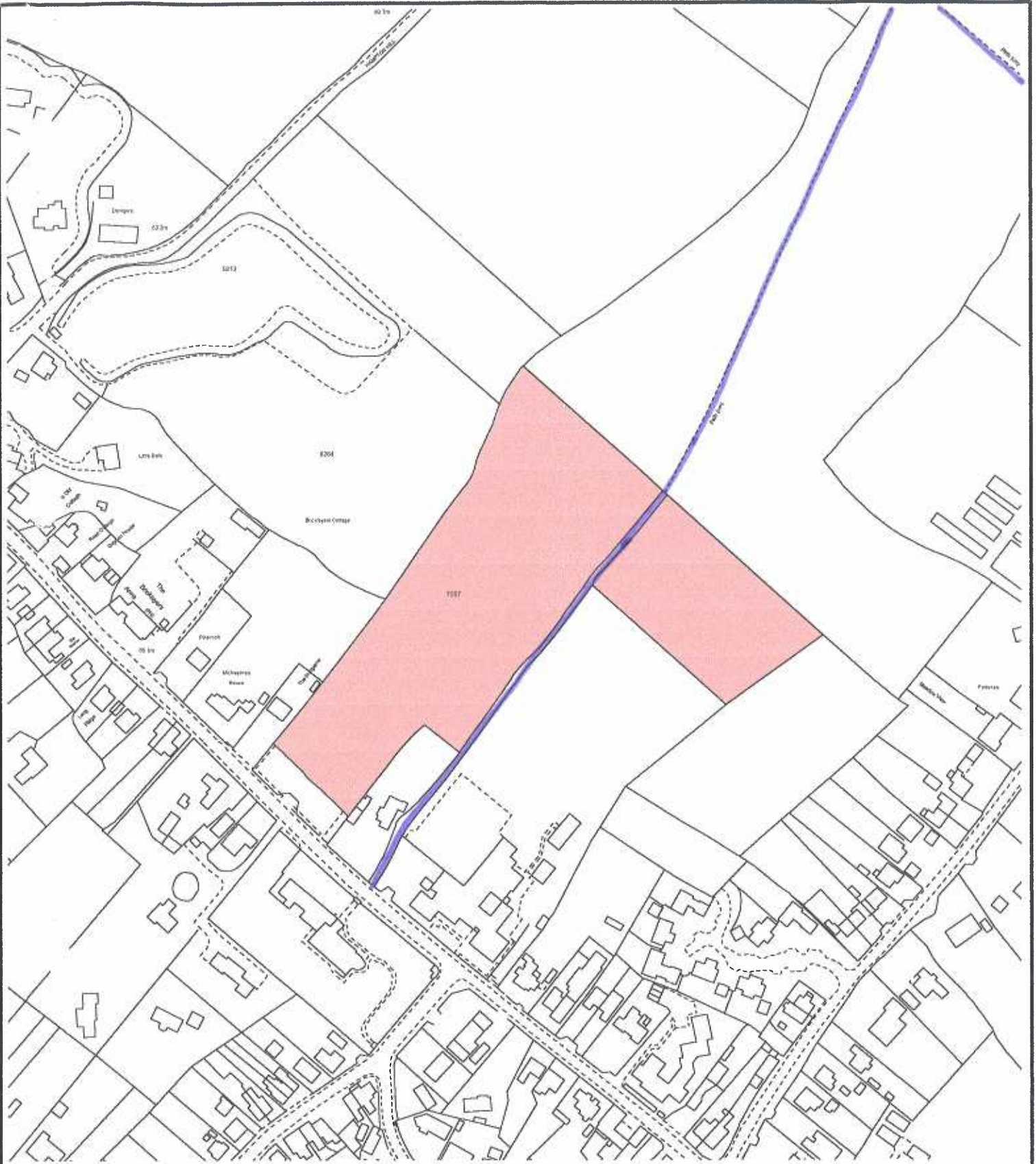

**LAND ADJOINING
SWANMORE PRIMARY SCHOOL
CHURCH ROAD SWANMORE**

PLAN No.
E / 5 / 206 / A

DATE
NOVEMBER 1998

SCALE
1:2500

OS No.
SU 5616
SU 5716

Reproduced from or based upon
Ordnance Survey Mapping with the
permission of the Controller
of Her Majesty's Stationary office
© Crown Copyright
Unauthorised reproduction infringes
Crown copyright and may lead to
Prosecution or civil proceedings
Hampshire County Council 076651



Hampshire County Council

PROPERTY, BUSINESS
AND REGULATORY

ESTATES PRACTICE