

Wildlife and Countryside Act 1981

The Hampshire National Parks and Access to the Countryside Act 1949  
Section 33 Second Review of the Definitive Map and Statement  
(Dated 1st January 1964)

To: **The Director of Recreation and Heritage**  
of: Hampshire County Council  
Mottisfont Court  
High Street  
Winchester  
Hampshire  
SO23 8ZF

I/We [name of applicant(s)]: Margaret Taylor  
of [address of applicant(s)]: 31 Christchurch Rd  
Winchester SO23 9SY

hereby apply for an Order under Section 53(2) of the Wildlife and Countryside Act 1981  
modifying the definitive Map and statement for the area by:- [delete where appropriate]

~~• deleting the footpath / bridleway / restricted byway / byway open to all traffic  
from .....  
to.....~~

or

• ~~adding~~ the footpath / bridleway / ~~restricted~~ byway / ~~byway~~ open to all traffic  
from the end of S Bridge Road  
to Garnier Road carpark via St Catherine Hill

or

• ~~upgrading/downgrading~~  
to a footpath / bridleway / restricted byway / byway open to all traffic  
~~the footpath / bridleway / restricted byway / byway open to all traffic~~  
from .....  
to.....

or

• ~~varying/adding~~ to the particulars relating to the footpath / bridleway /  
restricted byway / byway open to all traffic  
from .....  
to.....  
by providing that .....

and shown on the map annexed hereto.

I/We attach copies of the following documentary evidence (including statements of witnesses) in support of this application:

- List of documents
- ① Copy of definitive map on which is marked the stile, gates, interpretation boards, built steps and the location of the misthaze all of which define the route of the footpath.
  - ② Scanned image from aerial photograph from 'Millennium Map' xyz mapping 2000
  - ③ Image 2006 getmapping.com.
  - ④ ~~Witness form~~ witness form
  - ⑤ Image 1947 aerial photography Source Hampshire Archives office

- Names of Witnesses
- |                         |                   |
|-------------------------|-------------------|
| Maggie Taylor           | Charlotte Adamson |
| Iain Patton             | Ruth Holyer       |
| Jo Pennington           | Sandra Lox        |
| <del>Witness form</del> | Clynn Lawrence    |
| Tessa Leiden            | Juliet Deacock    |
| Karen Bradford          | Sally Louder      |
| Ian Bemdge              | Jamie Heard.      |
| Joanna Page             | Barbara Meir      |

Angus Breiman and Amanda Tutlett are understood to have returned witness forms directly to the Rights of Way Section

Dated ..... 16th April ..... 20.07

Sign 

NOTE – PLEASE SUBMIT A MAP WITH THIS APPLICATION THAT CLEARLY SHOWS THE CLAIMED ROUTE.

Please mark the route(s) you have used on the map.

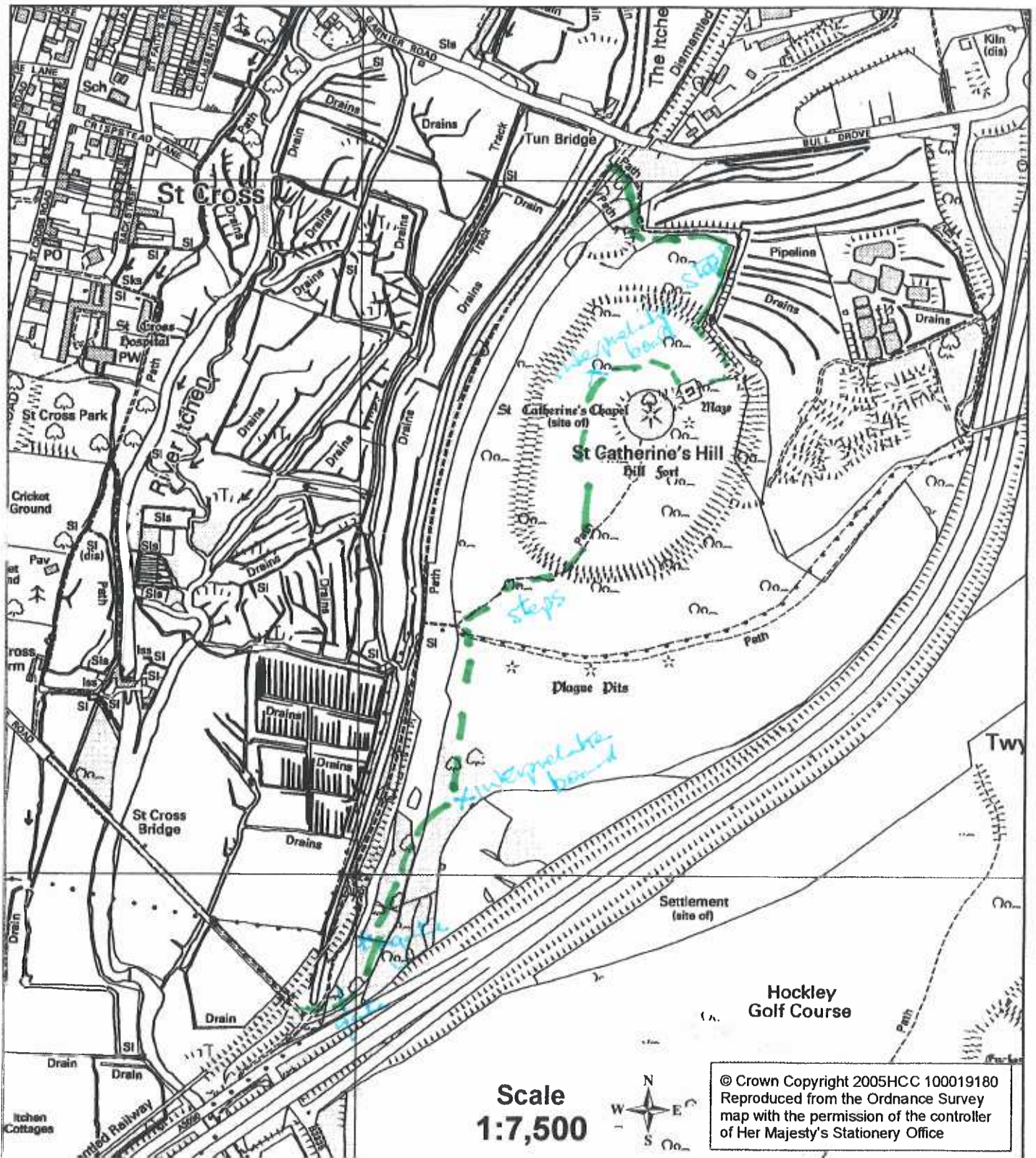

Signed ...

..... Dated 15/4/07

Wildlife and Countryside Act 1981

The Hampshire National Parks and Access to the Countryside Act 1949  
Section 33 Second Review of the Definitive Map and Statement  
(Dated 1st January 1964)

Certificate of Service of Notice of Application for Modification Order

To: **The Director of Recreation and Heritage**  
of: Hampshire County Council  
Mottisfont Court  
High Street  
Winchester  
Hampshire  
SO23 8ZF

I/We [name of applicant(s)]

Margaret Taylor

of [address of applicant(s)]

31 Christchurch Road

Winchester

SO23 9SY

hereby certify that the requirements of paragraph 2 of Schedule 14 to the Wildlife and Countryside Act 1981 have been complied with.

16th April

2007

Name and address of landowner(s)

Warden & fellows of Winchester College  
Winchester College  
Winchester  
Hampshire SO23 9NA