

1.0	PARISH	Steep
2.0	HUNDRED	East Meon
3.0	NGR	474600 125300
4.0	GEOLOGY	Gault

5.0 SITE CONTEXT (Map 2)

Steep is 2km north of Petersfield's centre, just below the heights of the Downlands (west) as they give way to the Weald. Residual woodland patches are plentiful in this parish. The church of All Saints faces north onto the west / east Church Road and at a loop in the road where it drops dramatically into the valley of the River Rother at Sheet. The margins of Church Road are characterised by C20 housing though beyond these to the north there is fine mixed woodland. The western boundary of the churchyard is defined by a footpath, once a road, that descends into Petersfield.

6.0 PLAN TYPE & DESCRIPTION (Maps 3, 4 & 5)

Church & farms

6.1 *Church & farms* The 1839 Tithe Map shows the church of All Saints in the company of Church Farm (*c.* 200m south-west) and the house known as Restalls (C16 / 17, and formerly known as Church House). Restalls is in the adjacent plot to the east of the churchyard (Map 3); Church Cottage, just to the west, was the Tithe barn and it is shown as such on the Tithe Map. Also nearby was the late Medieval Steep Farm (*c.* 350m north-east). The site of Church Farm is now occupied by the campus of Bedales School.

6.1.2 The evidence of the Tithe Map indicates that Steep was an area of dispersed settlement. Place-names indicate that it was a heavily wooded area: Ashford Farm, Lythe Farm, Elmwood House, Bushy Hill, Aldersnapp Farm, Burntash Farm *etc.* Many of the farms would have been established as assarts, individual and independent holdings. Nucleation would have been unlikely in an area such as this and there is no evidence of it. Site inspection revealed no evidence of desertion or shrinkage but only of features associated with the churchyard and erstwhile field boundaries. It is likely then that the church, Church Farm and Steep Farm are situated in former woodland clearings.

6.2 *Site visit condition:* hazy sun; some light rain (26.4.99)

7.0 ARCHAEOLOGICAL POTENTIAL (Map 4)

7.1 *AsAP*

The area of potential is limited to the church and its immediate context *i.e.* the grounds of Restalls and Church Cottage and an extension into the property immediately east of the churchyard. The construction of Bedales School has diminished the archaeological value of the Church farm site. In an area of well spread individual farmhouses it is difficult to identify meaningful areas of potential. Many of the farmhouses are at least

C16 but with possible earlier origins.

7.2 *AsHAP*

This is limited to the churchyard as shown on Map 5.

8.0 CHURCH & CHURCHYARD

All Saints

- C9 (Saxon) cross shaft; perhaps marks the location of a preaching place prior to the building of the church;
- present church is 1140 or earlier;
- c. 1180 south aisle;
- c. 1200 north doorway & north aisle wall;
- C13 chancel;
- late C13 font;
- C12 & C13 south doorway;
- C15 north door;
- 1875 bell turret;
- Medieval wall paintings - faint traces on some pillars of the north arcade.

Local traditions assert strong links between the churches at Steep and Froxfield Green. In fact, they are linked by the old road that passes on the west of Steep church. Both churches were once within the large Episcopal estate of East Meon where they served as chapels of ease dependent upon the mother church.

9.0 BUILDINGS (Map 4)

PRN	Details	Dates	Grade
*	Mansion (flats), Adhurst St Mary	1858	II
*	Mansion: stables, coach house & archway north of	1858	II
*	Aldersnapp Farmhouse	C19, 20	II
*	The Old Farmhouse, Dunhill	C16, 1820, C19	II
*	The Old Farmhouse: granary 30m north of	C18	II
*	Gardner's Farm	C16, 19, 20	II
*	Soal Farmhouse	C16, 20	II
*	Vine Cottage (Dunannie Cottage)	C17, 19, 20	II
*	Ashford Manor, Ashford: coach house at	C19, 20	II
*	Ashford Manor: kitchen & garden wall east from coach house	early C19	II
*	Beescott, Ashford	C17, 20	II
*	Berryfield (Berryfield Cottage), Ashford	1820, C20	II
*	Ashford Chace (former barn): gateway to	C18, 1912	II
*	The Gatehouse, Ashford	C19, 20	II
*	Ashford Chace, Ashford	1912	II
*	Little Ashford Farmhouse, Ashford	C17, 19	II

*	Burnt Ash Farmhouse, Bowyer's Common	C16, 17, 18, 20	II
*	Burnt Ash Farmhouse: barn 30m south of	C18	II
*	Tankedale Farmhouse	C16, 17, 19, 20	II
*	Row Cottage, Church Road	early C20	II
*	69 Little Hawstead, Church Road	1902	II
*	69 Little Hawstead: apple store 15m south of	1902	II
79	Bedale's Memorial Library (Bedale's New Hall & Memorial Library), Lupton Hall, Church Road		I
*	Parish Church of All Saints, Church Road	C12, 13, 14, 1838 1875	II*
*	Table tomb 17m north-east of All Saints	early C19	II
*	104 (Restalls) Church Road	C17, 1905	II
*	1 & 2 Kettlesbrook Cottages, Harrow La.	C17, 19	II
*	Five Oaks, Steep	1913, 1935	II
*	Lythe Farmhouse, Lythe Lane	C18, 19	
II			
*	Lythe Farmhouse: barn 10m north-east of	C18	II
*	Greenlands, Park Lane	C17, 18, 20	II
*	Coldhayes (mansion), Steep Marsh	1869	II*
14637	Steep Farmhouse	C16, 17, 18	II
*	Coldhayes: stables 30m north of	1869	II
*	Steep Marsh Farmhouse, Steep Marsh	C17, 18 20	II
*	The Red House, Strand Road	C17, 19, 20	II
*	The Red House: stables 20m north of	early C19	II

10.0 SMR DATA SW 474200 124800, 475000 125700 NE (Map 4)

SU 72 NW No.

20	474580 125300	Medieval. Parish Church (see 8.0).
100	474550 125550	Romano-British. Pottery finds; 28 sherds.

10.2 Hampshire Romano-British Settlements survey

<i>Hants No.</i>	<i>NGR</i>	<i>Parish</i>	<i>NAR / NMR Nos</i>
None listed.			

10.3 Scheduled Ancient Monuments (SAMs)

<i>SAM No.</i>	<i>NGR</i>	<i>Site</i>
None.		

11.0 ADDITIONAL SITES / FEATURES (Map 4)

1	474615 125305	Mound in churchyard of unknown date and purpose. Possibly the stub of the former south boundary.
2	474510 125320	Remains of linear boundary represented on the Tithe Map of 1839.
3	474555 125315	Remains of linear boundary represented on the Tithe Map

of		1839.
4	474600 125320	Remains of linear boundary represented on the Tithe Map of 1839.
5	474568 125290	Point on former road / track to Petersfield now represented as a footpath.

12.0 CARTOGRAPHIC SOURCES

- Tithe Map 21M65/F7/222/2 (1839 / 1842)
- GSGB 300 Alresford
- OS 1: 2500 SW 474200 124800, NR 475000 125700
- OS 1: 25000 Pathfinder 1265 (SU 62/72), Petersfield & the Meon Valley.

13.0 BIBLIOGRAPHY

- HTS 6: 301-309
- VCH 3: 77-81

14.0 PRIMARY HISTORIC SOURCES

14.1 Domesday Book

Not mentioned. Possibly included in East Meon.

14.2 Subsidy Rolls

1334		£3.14.7	
1524	<i>1st survey</i>	£0.14.0	(9 taxpayers)
	<i>2nd survey</i>	Not listed.	

14.3 Manorial Documents

Manors recorded: Steep; Ambersham (AD 963); More; Ashford.

14.4 Hearth Tax 1665

148 hearths chargeable (51 houses)
30 hearths not chargeable (24 houses). Total: 75 houses.

15.0 PLACE NAME

C12 *Stepe*; c. 1200 *Stupe*; c. 1230 *la Stiepe*. OE *stiepe* 'steep place'. There is quite a steep drop from the downland to the Weald here (Coates, 1989: 155).

16.0 PHOTOGRAPHS

17.0 OTHER PROJECT ELEMENTS

17.1 Pre-Conquest Charters

None.

17.2 Other parish settlements include:

<i>Name</i>	<i>MSP no.</i>	<i>Map ref.</i>	<i>First recorded</i>
Adhurst	2125	475400 124800	1504
Aldersnape Farm /			

Winters	2301	472900 124200	1248
Ashford / Chace	2302	474200 126600	959
Dunhill Farm	2303	473900 124900	1288
Forcombe	2304		1245
Soal Wood (Farm)	1049	472800 124600	1320
Westmark Farm	2129	476700 124200	1504

17.3 Enclosures

Parliamentary:

<i>NEP no.</i>	<i>Act</i>	<i>Order</i>	<i>Award</i>	<i>Details</i>
None.				

Formal Agreements:

<i>NEP no.</i>	<i>Agreement</i>	<i>Award</i>	<i>Details</i>
None.			

17.4 Commons & Greens (residual)

None.

18.0 ILLUSTRATIONS

- 1 Map 1: Parish location (not to scale)
- 2 Map 2: Settlement location at 1: 25000
- 3 Map 3: 1839 Tithe Map transcribed at 1: 2500 reduced to 71%
- 4 Map 4: Development & archaeological features at 1: 2500 reduced to 71%
- 5 Map 5: Areas of archaeological potential at 1: 2500 reduced to 71%.

**THE ANCIENT PARISHES
AND CHAPELRIES OF
HAMPSHIRE**

1. EASTROP
2. ELDON
3. EWHURST
4. FOXCOTT
5. MAPLEDURWELL
6. NATELEY SCURES
7. NEW ALRESFORD
8. SWARRATON
9. WESTON CORBETT
10. WEST WOULDHAM
11. WINNALL
12. WINSLADE

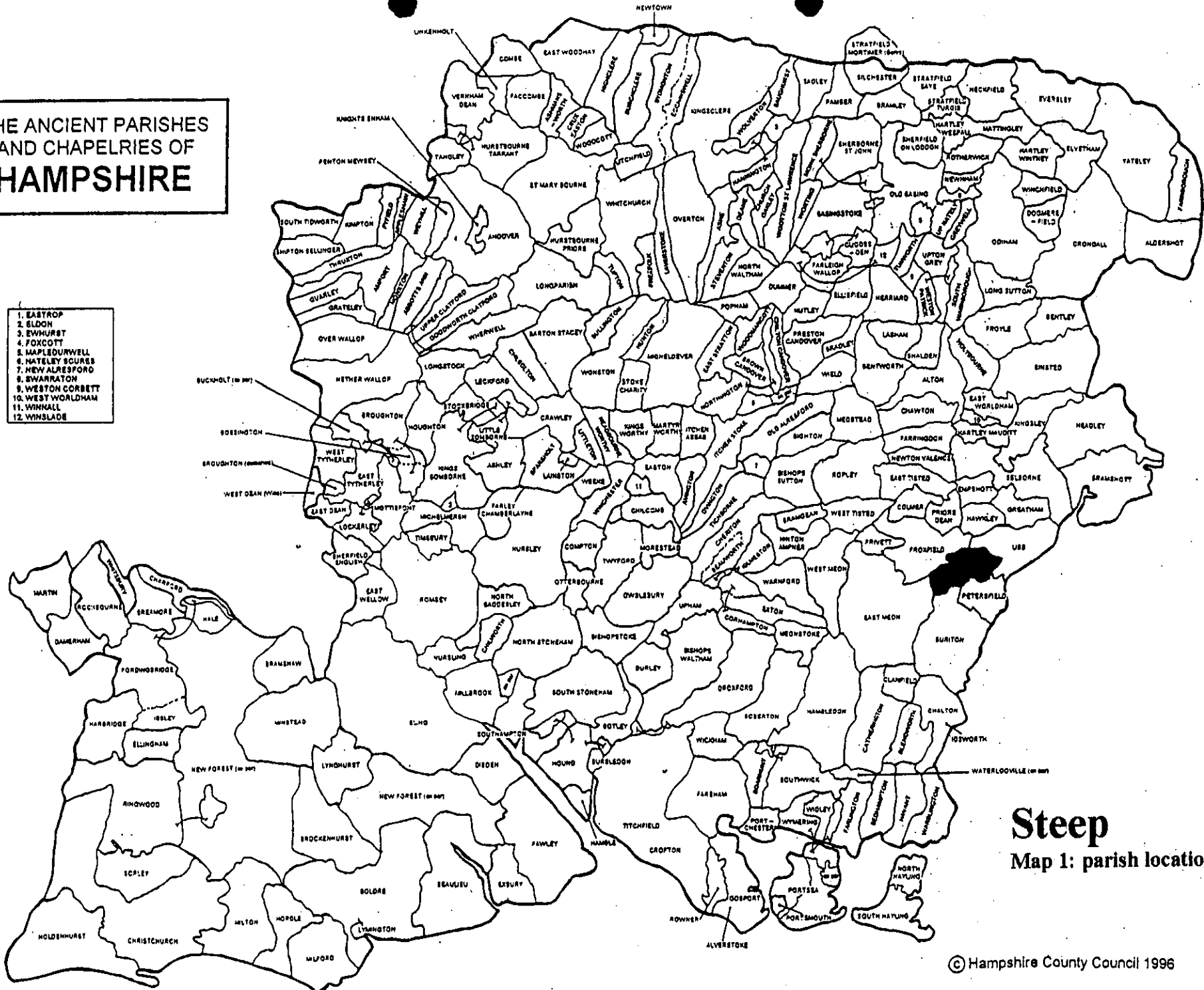

Steep
Map 1: parish location

Steep

Map 2: general location



Reproduced from the Ordnance Survey map with the permission of the Controller of Her Majesty's Stationery Office
 © Crown Copyright

29

28

27

26

25

24

Steep

Map 3: transcribed from the
Tithe Map of 1839

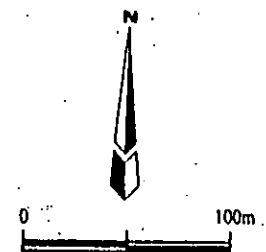
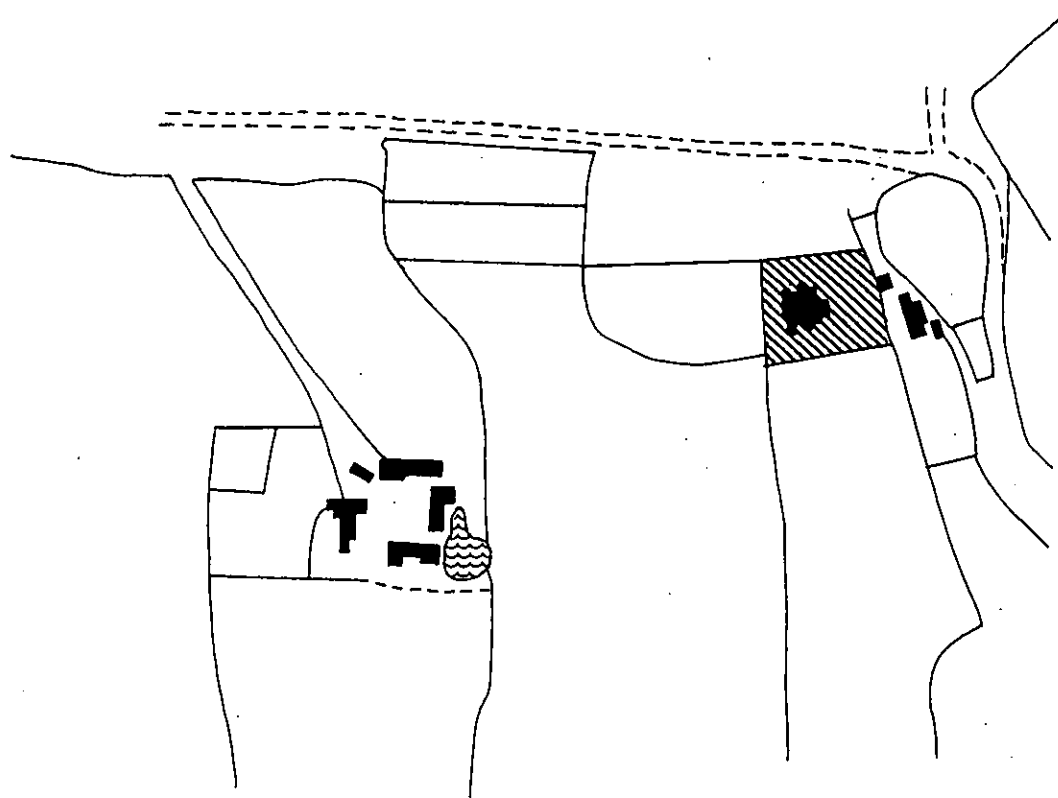

Steep

Map 4: development & archaeological features

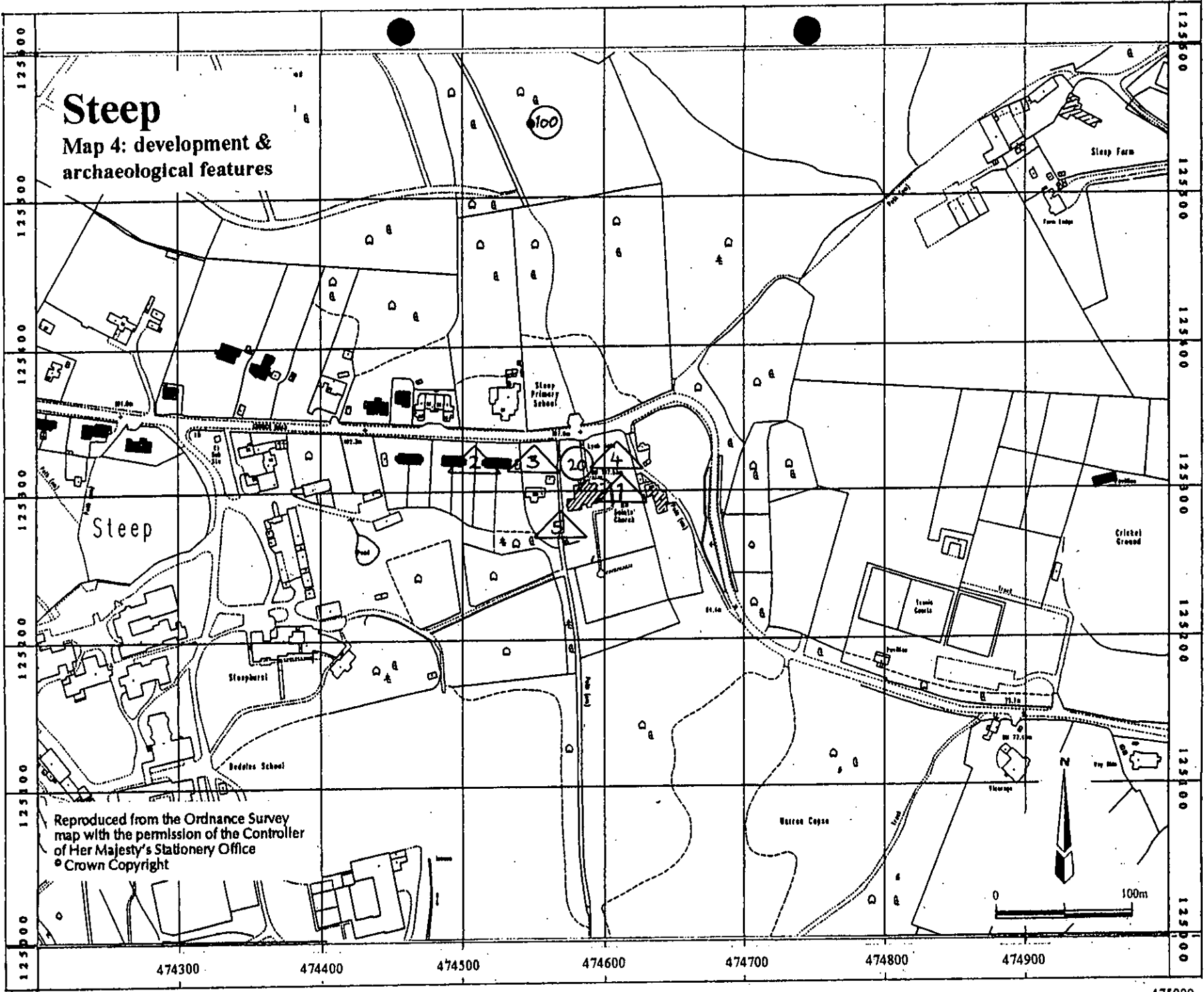

Reproduced from the Ordnance Survey map with the permission of the Controller of Her Majesty's Stationery Office
© Crown Copyright

Steep

Map 5: areas of archaeological potential

