

NAME East Dean
PARISH East Dean
HUNDRED Thorngate
DISTRICT Test Valley
NGR SU274268
GEOLOGY Upper chalk, river gravels and alluvium

SITE CONTEXT The village lies at 40m OD at the bottom of a N facing slope which rises to 130m OD. The lower part of the slope is gentle to 70m OD at which height it becomes much steeper. To the N the village is bounded by the River Dun which flows in two channels, one of which was the course of a canal. The railway also follows the line of the valley.

PLAN TYPE & DESCRIPTION Irregular row.

An irregular row of buildings lie mainly on the N side of an E-W road. At the W end of the settlement the road forks and the building line follows the fork to the N instead of the main road. The church is one of the few buildings on the S side of the road and apart from a couple of buildings to the N and S of it, has no buildings to the W or E for some distance.

AREAS OF ARCHAEOLOGICAL POTENTIAL

All areas alongside the road through the village must be regarded as having archaeological potential in a settlement with an irregular row such as East Dean. There is always the possibility that there may have been other properties in the gaps such as those between Manor Farm and East Dean Manor and W of Manor Farm which have disappeared.

However, two areas are seen as having a higher level of archaeological potential: The area around the church on the S side of the road and the area to the NE of the church which contains earthworks (New Site 10).

CHURCH & CHURCHYARD Mainly Victorian but with one Norman chancel window (Pevsner and Lloyd, 1967). The outside of the church is mainly brick but on the inside it is evident that the walls of the building are earlier than Victorian judging by their thickness and the angles at which they stand. The chancel arch is Victorian but the remains of a small blocked arch is visible to the N of the chancel arch. The purpose of the arch is unclear. It is unlikely that there was a chancel chapel on the N side the church.

The graveyard was only slightly larger than the church in 1840 and was rectangular. A house stood between the church and the road. The graveyard has also been extended to the N.

At Domesday it was a chapelry of Mottisfont and presumably the dead of the parish were taken there for burial, explaining the small size of the graveyard shown at the time of the Tithe Apportionment.

BUILDINGS

(Listed)

Manor Cottage C17 altered early C19 II
Thujas Mid C18 II
Manor Fmhse Early C18 II
East Dean Manor House Early C18 and early C19 II*
Church of St Winifrid II*
East Dean House Late C18 altered C19 II
Garden Cottages Early C19 II
Park Fmhse, Frenchmoor Lane C17 extended and tilehung C18 II*
Granary 10m N of Park Fmhse C18 II
Barnowls at Park Fm Barn converted C18 II
Barn and cartshed range 35m NE of Park Fmhse C18 of 2 builds II
Deansgate Fmhse, Holbury Lane C17 encased C18 II

SMR DATA

2	27402660	IA coin
6	27402660	Lynchet Unknown date
7	27342674	Med church
14	27232618	Earthwork
48	27502680	Medieval village mentioned in Domesday Book

SMR sites 22-24, 27-33, 35-40, 43, 44 are WWII pillboxes and anti-tank defences.

ADDITIONAL SITES/FEATURES

1	27342676	Site of building shown on Tithe map
2	26732688	ditto
3	27332682	ditto
4	27222675	ditto
5	27562681	Site of building shown on Tithe map with a second building to the SE
6	27082667	Site of cottage shown on Tithe map
7	27662677	ditto
8	26922672	Site of building shown on Tithe map
9	26802676	Site of buildings shown on Tithe map
10	27442683	Earthworks. Two irregularly shaped platforms with some other 'humps and bumps'. The largest of the platforms extends from the road to the N. The smaller of the two lies immediately E of the gardens of the semi's on the W edge of the site and lies away from the road. That they may be associated with the construction of the canal which lies immediately to the N cannot be ruled out. An earthwork survey would be helpful
11	26822682	Site of building shown on Tithe map

12 26862686 Site of cottage shown on map on 1807 and to the NW
at 26832687 a cottage is shown on the Tithe map

CARTOGRAPHIC SOURCES 1:2,500 SU 2626-2726, 2826-2926; Tithe map
21M65/F7/65/2 (1840), P85M71/PZ2 (1807).

BIBLIOGRAPHY

PRIMARY HISTORIC SOURCES

Domesday The King. In the same Hundred lies East Dean which is attached to this manor (Broughton). In lordship 1 pl. 2 villagers and 14 smallholders with 1.5 pl. 2 slaves; 2 mills at 20s; meadow, 4 acres; woodland at 3 pigs.

Subsidy Rolls

1334	1. 9. 0
1524	3. 17.6 (18 taxpayers)

Manorial Documents

Hearth Tax

1665	47 hearths chargeable (23 houses) 15 hearths not chargeable (13 houses) Total 36 houses
------	--

PLACE NAME 1086 *Dene* OE *denu* 'valley'. The village may continue the estate of the Roman villa around which West Dean has grown.

PHOTOGRAPHS

OTHER PROJECT ARCHIVE ELEMENTS

Opposite the church (where the left of the two new houses stands) were a couple of half-timbered cottages probably of C17 date (VCH Vol IV p498).

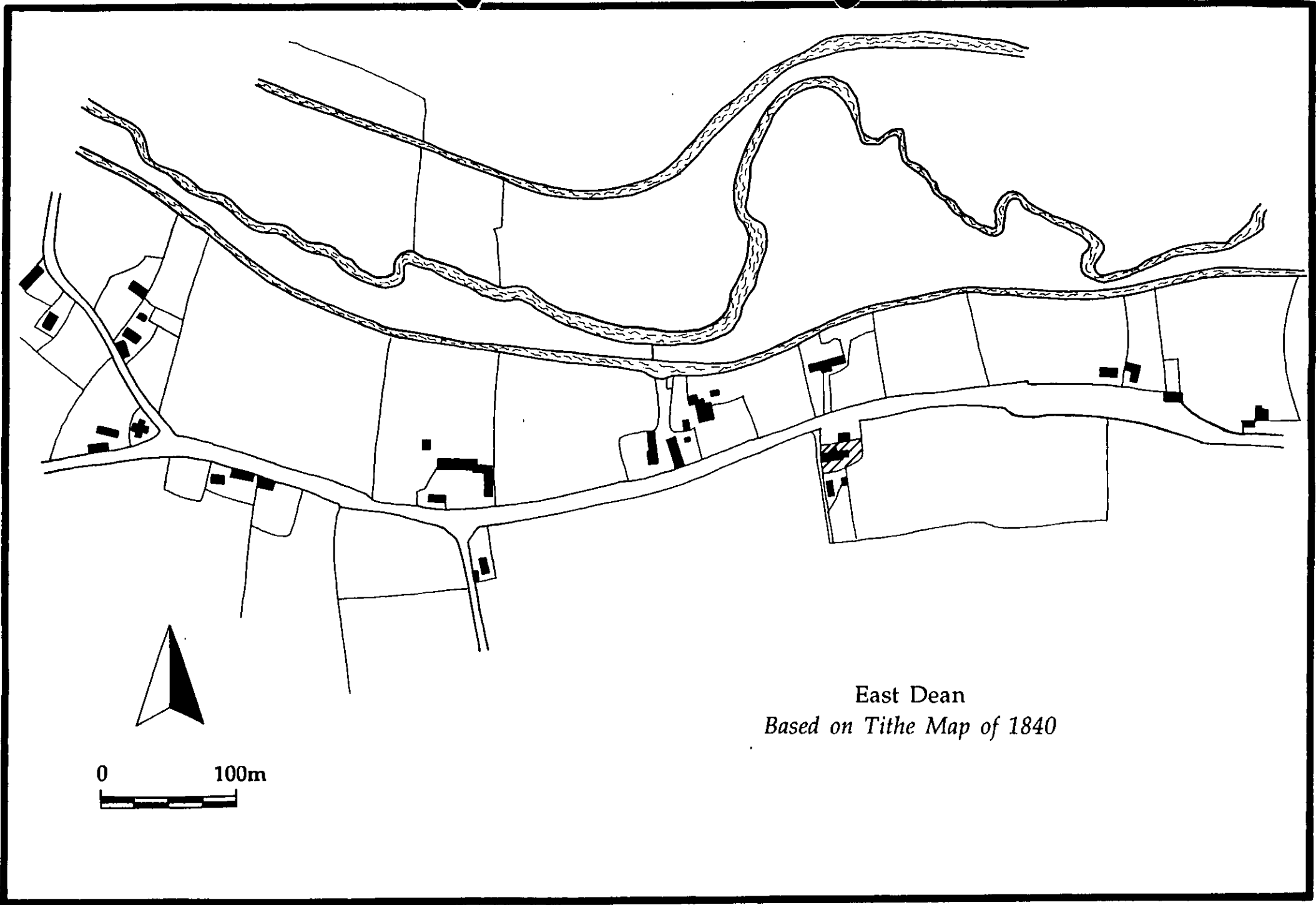

East Dean
Based on Tithe Map of 1840

0 100m

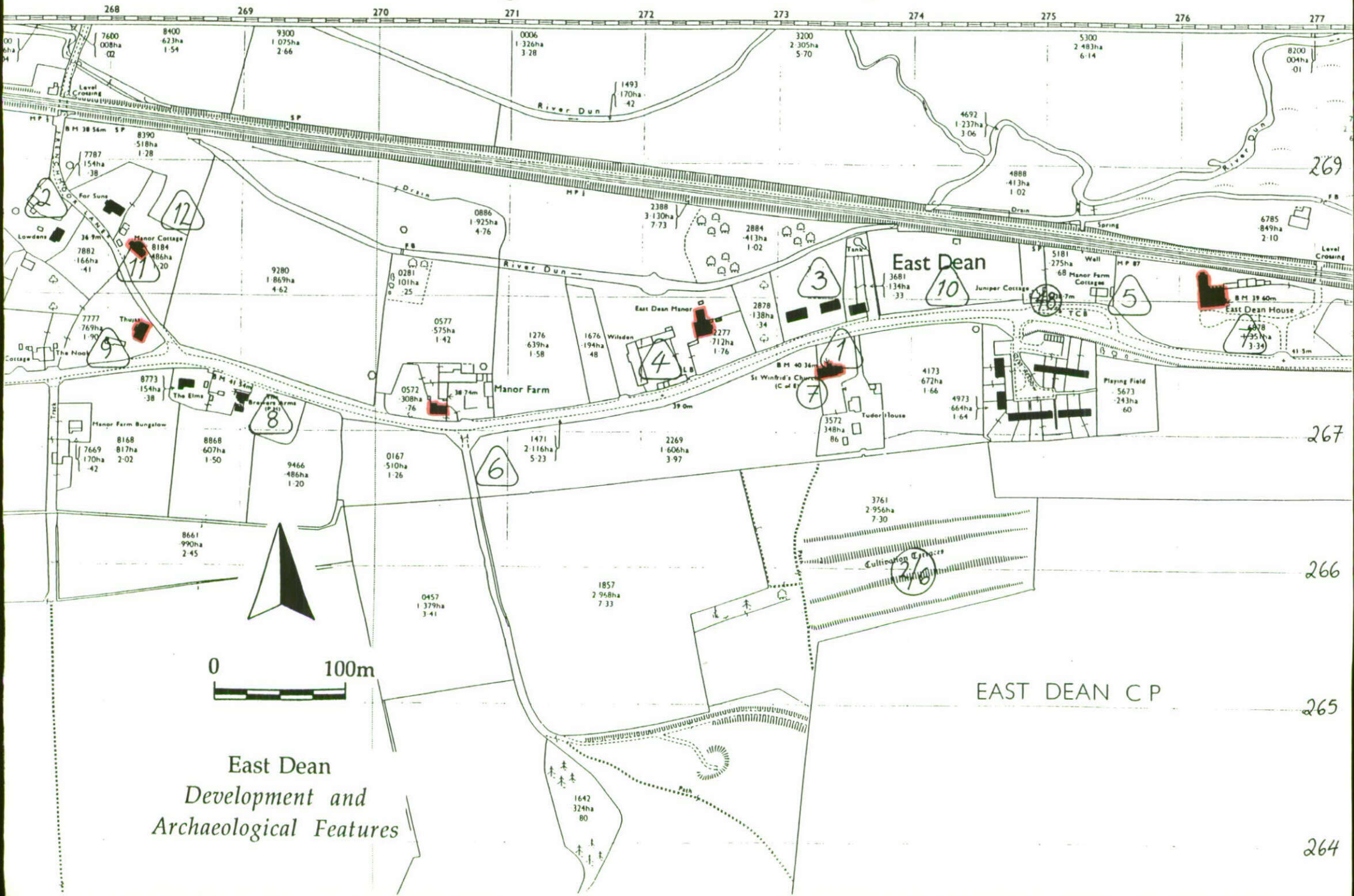

East Dean
Development and
Archaeological Features

EAST DEAN C P

269

267

266

265

264

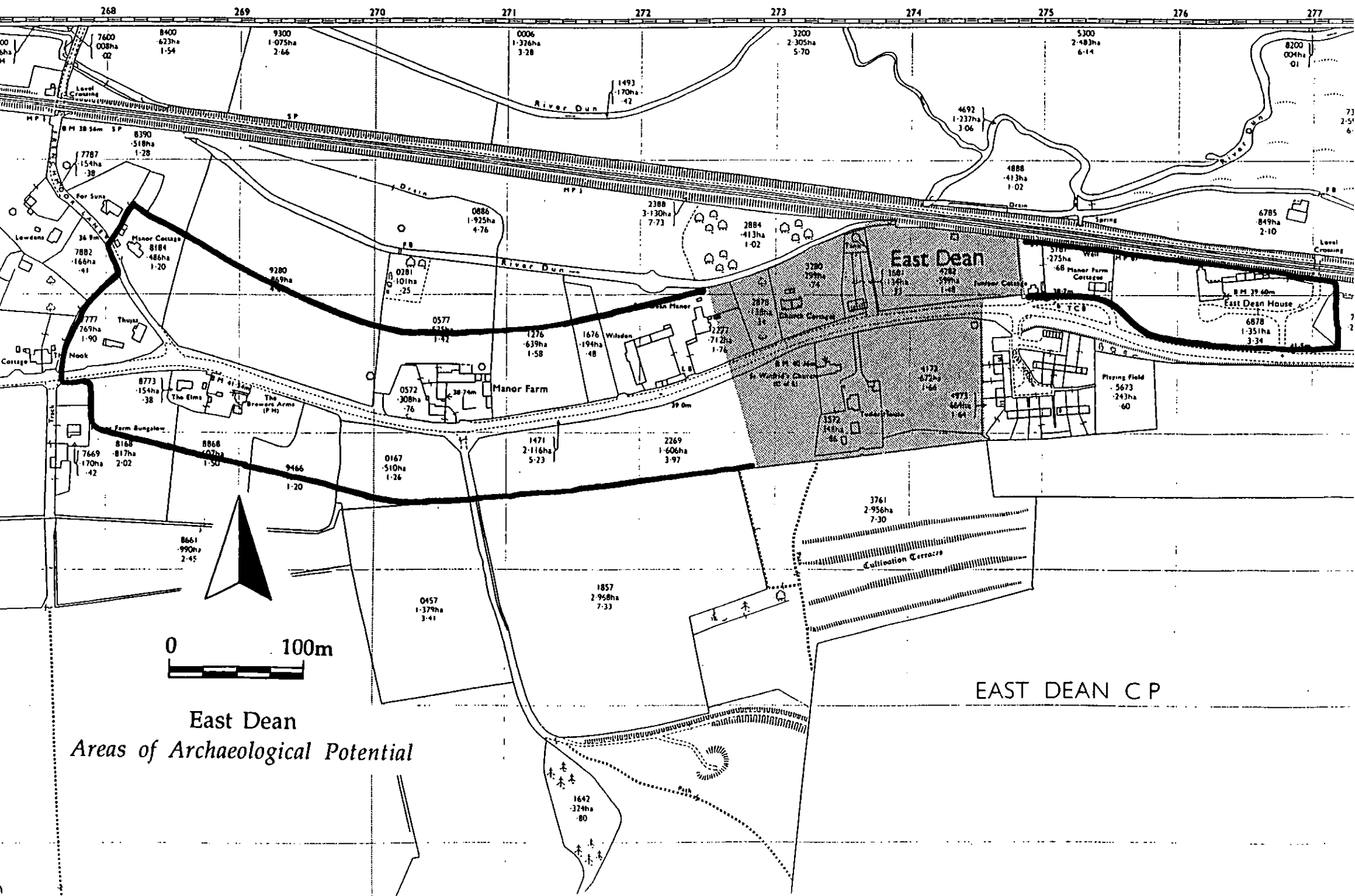

East Dean
Areas of Archaeological Potential

EAST DEAN C P