

PARAPET TYPE AS SHOWN ON INDIVIDUAL BRIDGE DRAWINGS WITH BASE PLATES ON MIN.15 MORTAR BED TO CLAUSE 2601.

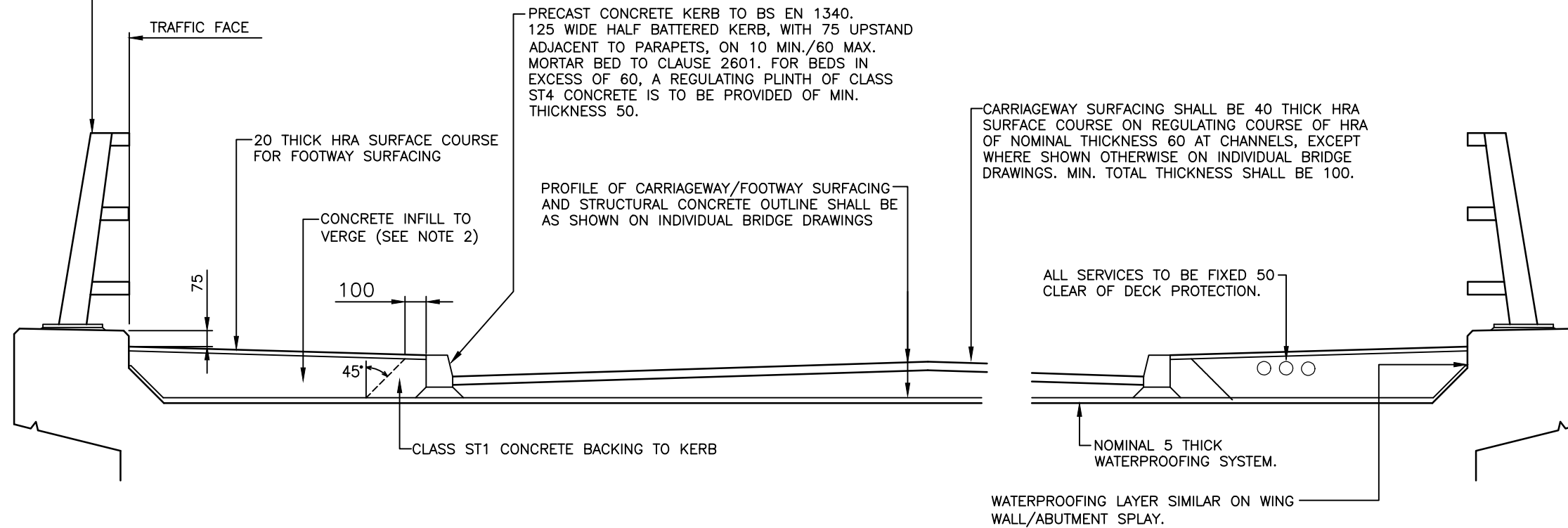

**SECTION THROUGH BRIDGE DECK**

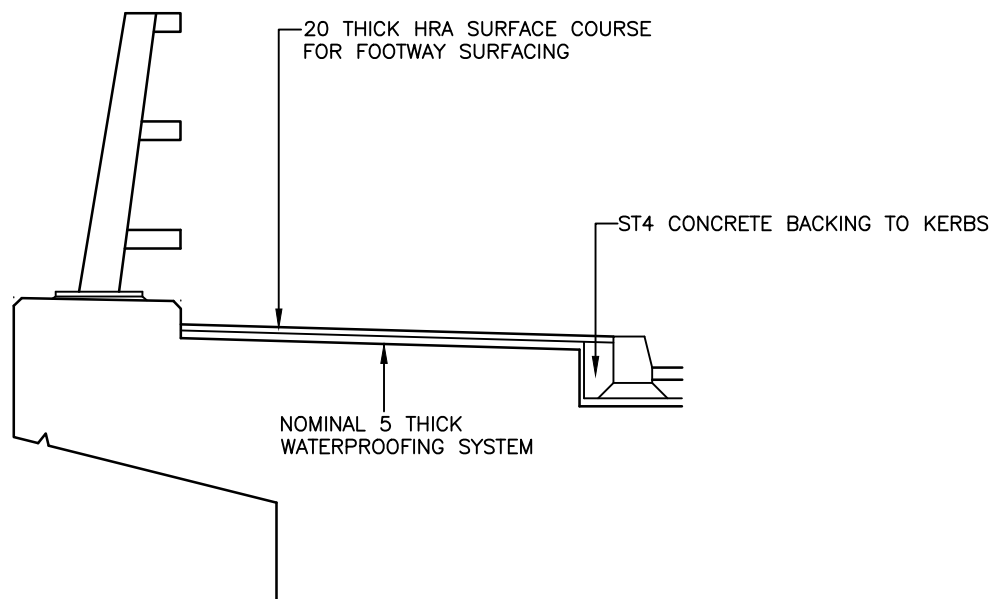

**SECTION THROUGH FOOTWAY**

FOR BRIDGES WITH STRUCTURAL CONCRETE UPSTAND BEHIND KERB

**NOTES:**

1. ALL DIMENSIONS ARE IN MILLIMETRES.
2. FINISHES TO VERGES:
  - a) WHEN THE APPROACH FOOTPATH/VERGE HAS BITUMINOUS SURFACING, THE FOOTPATH/VERGE CONSTRUCTION OVER THE BRIDGE SHALL BE ST1 CONCRETE AND 20 THICK BITUMINOUS SURFACING.
  - b) WHEN THE APPROACH VERGE IS GRASS, THE VERGE CONSTRUCTION OVER THE BRIDGE SHALL BE ST4 CONCRETE.
  - c) WHEN THE APPROACH FOOTPATH/VERGE IS CONCRETE, THE FOOTPATH/VERGE CONSTRUCTION OVER THE BRIDGE SHALL BE ST4 CONCRETE.

Copyright Hampshire County Council. 2019

All rights, including translation, reserved. No part of this publication may be reproduced, stored in a retrieval system, or transmitted in any form or by any means (electronic, mechanical, photocopied, recorded or otherwise) without the prior written permission of Hampshire County Council. Requests should be directed to the Economy, Transport & Environment Department.

REV	AMENDMENTS	DATE	CAD	CHKD	APPD
CONSULTANT					
 STUART JARVIS BSc DipTP FCIHT MRTPI: DIRECTOR OF ECONOMY, TRANSPORT & ENVIRONMENT					
SCHEME					
STANDARD DETAILS					
DRAWING TITLE					
FINISHES TO UNDERBRIDGES					
HCC CADplot: 28.Feb.2020 at 10:41am					
DRAWN	WW	CHECKED	JB	SCALE @ A3	N.T.S
CAD	WW	APPROVED	BH	DATE	March 2020
DRG No.	HCC11/S/040				REVISION

Use only for: K:\\_Encl Standard AutoCAD Standard Details (Scheme) Ac Updated Dec 2011\HCC11 2020 STANDARD DETAILS.cad