

PARAPET TYPE AS SHOWN ON INDIVIDUAL BRIDGE DRAWINGS WITH BASE PLATES ON MIN.15 MORTAR BED TO CLAUSE 2601.

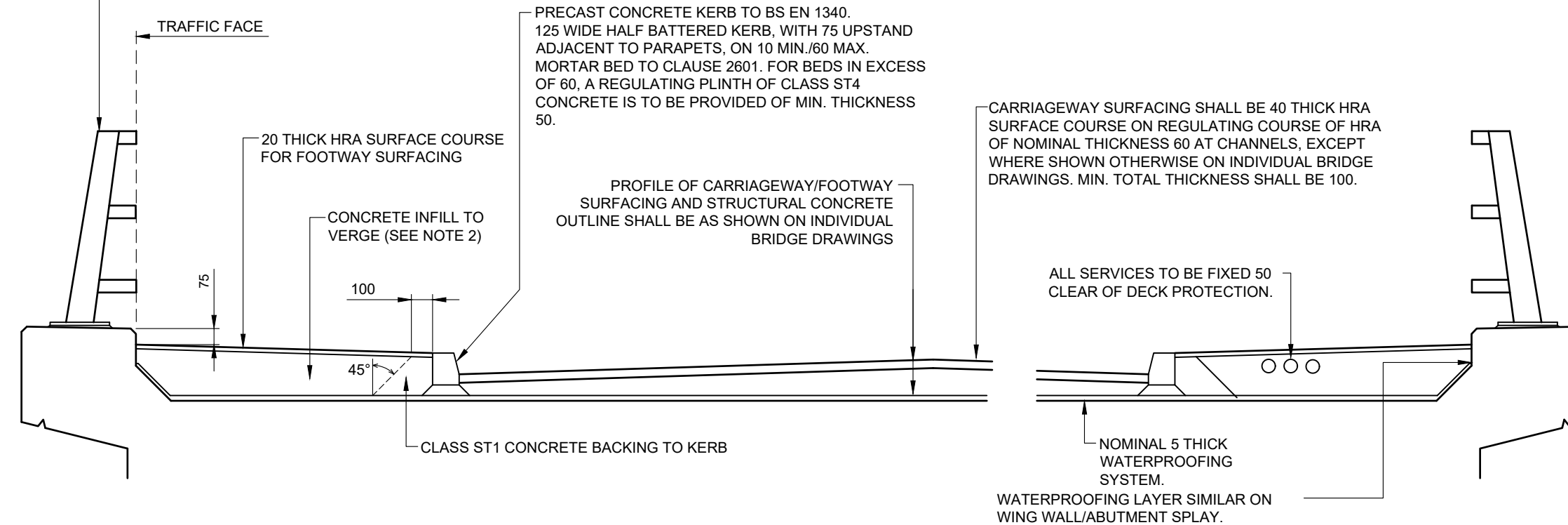

SECTION THROUGH BRIDGE DECK

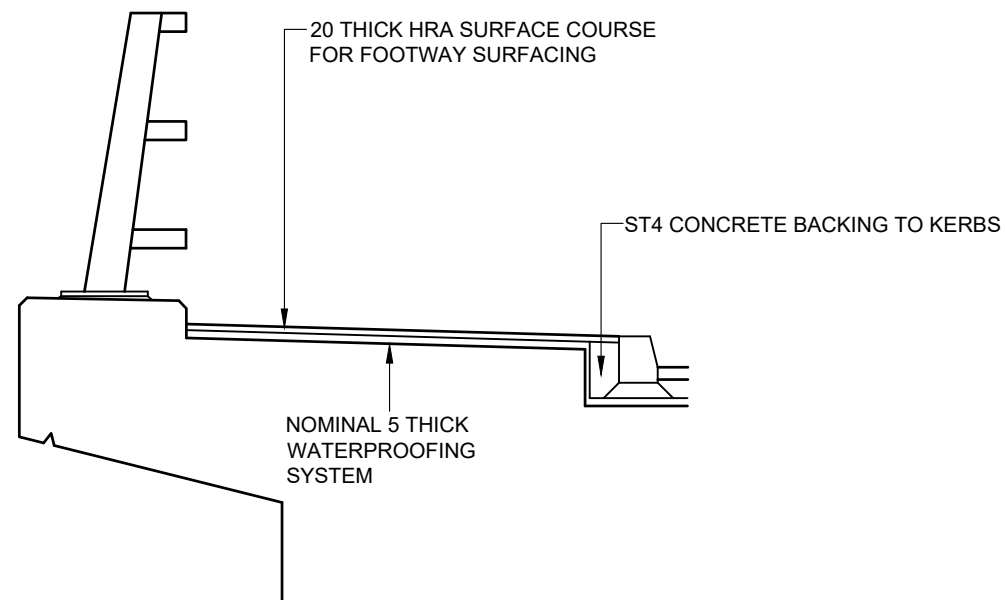

SECTION THROUGH FOOTWAY

FOR BRIDGES WITH STRUCTURAL CONCRETE UPSTAND BEHIND KERB

NOTES

1. ALL DIMENSIONS ARE IN MILLIMETRES.
2. FINISHES TO VERGES:
 - a) WHEN THE APPROACH FOOTPATH/VERGE HAS BITUMINOUS SURFACING, THE FOOTPATH/VERGE CONSTRUCTION OVER THE BRIDGE SHALL BE ST1 CONCRETE AND 20 THICK BITUMINOUS SURFACING.
 - b) WHEN THE APPROACH VERGE IS GRASS, THE VERGE CONSTRUCTION OVER THE BRIDGE SHALL BE ST4 CONCRETE.
 - c) WHEN THE APPROACH FOOTPATH/VERGE IS CONCRETE, THE FOOTPATH/VERGE CONSTRUCTION OVER THE BRIDGE SHALL BE ST4 CONCRETE.

A	BRANDING UPDATED. COPYRIGHT AMENDED AND NEW DIRECTORATE DETAILED.	12.02.2023	CLT/AC	MM	BH
REV	AMENDMENTS	DATE	CAD	CHKD	APPD

CONSULTANT

TIM LAWTON BEng CEng FICE FCIHT : ASSISTANT DIRECTOR OF UNIVERSAL SERVICES

SCHEME

STANDARD DETAILS

DRAWING TITLE

FINISHES TO UNDERBRIDGES

DESIGNER	CHECKED	SCALE @ A3
WW	JB JB	N.T.S
CAD	APPROVED	DATE
WW	BH BH	March 2020
DRAWING NUMBER	REV	
HCC11/S/040	A	

Copyright Hampshire County Council.

All rights, including translation, reserved. No part of this publication may be reproduced, stored in a retrieval system, or transmitted in any form or by any means (electronic, mechanical, photocopied, recorded or otherwise) without the prior written permission of Hampshire County Council. Requests should be directed to Hampshire Engineering Services.