

KERB TYPE CC1

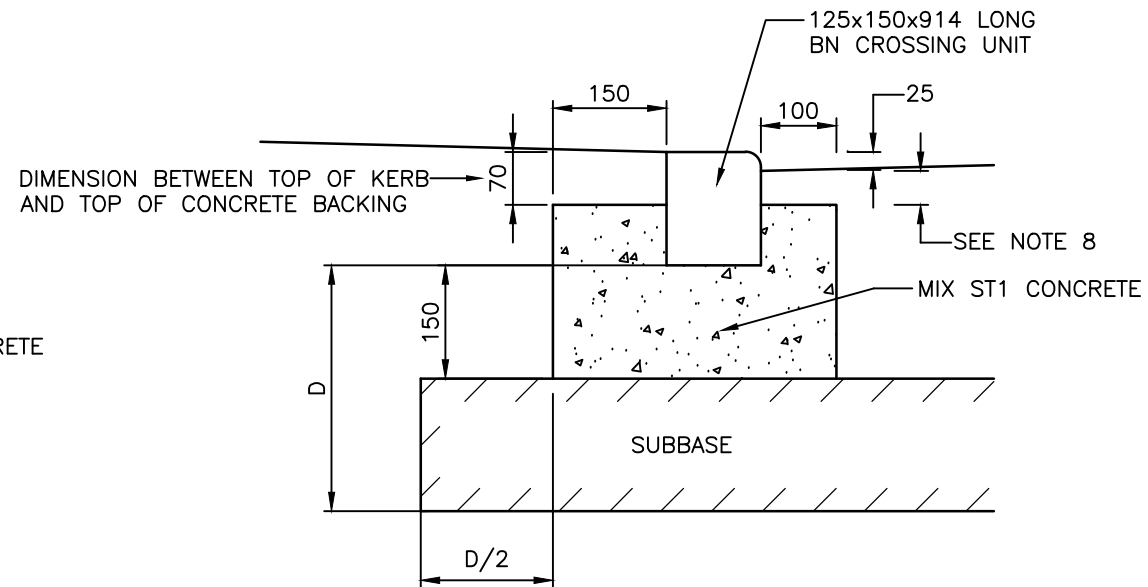

KERB TYPE CC2 (25 UPSTAND)

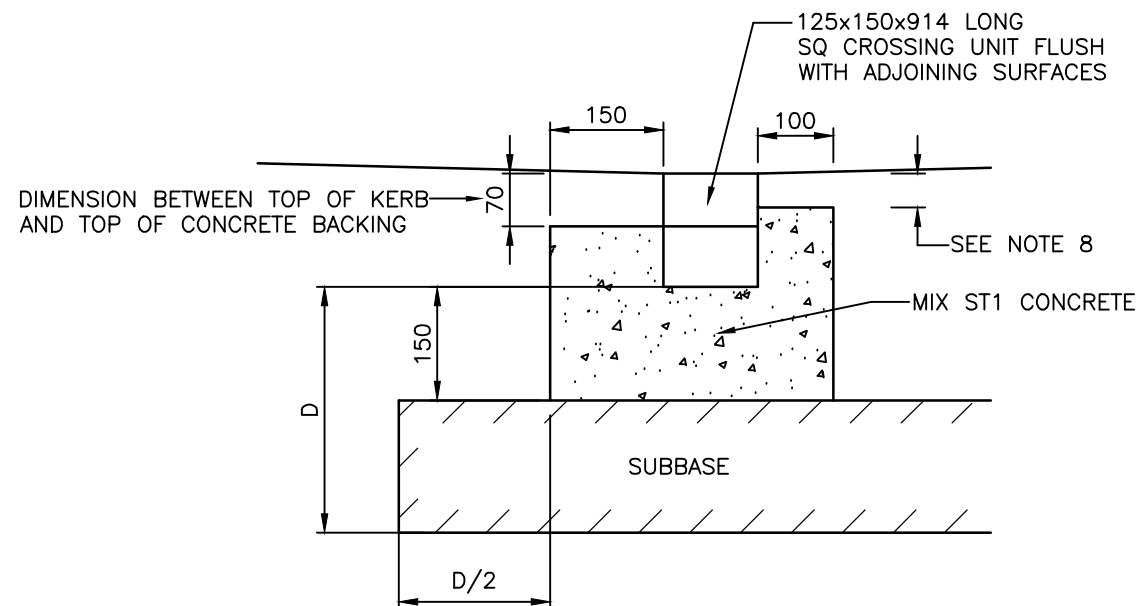

KERB TYPE CC3

NOTES:

1. ALL DIMENSIONS ARE IN MILLIMETRES.
2. KERBS SHALL BE CHARCON SILVER GREY 'COUNTRYSIDE CLASSIC' KERB OR EQUIVALENT.
3. MIX ST1 CONCRETE KERB BEDDING SHALL LAID ON SUBBASE AND SHALL BE A MINIMUM THICKNESS OF 150. SUBBASE SHALL BE EXCAVATED WHERE NECESSARY TO ACHIEVE 150 THICKNESS OF CONCRETE. RECOMPACT DISTURBED SUBBASE PRIOR TO CONSTRUCTION OF KERB BASE.
4. AS DESCRIBED IN CLAUSE 1101, SUB-CLAUSE 1, KERBS MAY BE LAID AND BEDDED ON MORTAR IN ACCORDANCE WITH CLAUSE 2601 OR LAID DIRECTLY ONTO THE CONCRETE BED. THE TYPE OF MORTAR SHALL BE APPROVED BY THE OVERSEEING ORGANISATION.
5. THE APPROPRIATE 914 LONG DROPPER KERB SHALL BE INSTALLED AT EACH CHANGE IN KERB TYPE, TIE-INS TO EXISTING AND AT TERMINATIONS.
6. THE MINIMUM LENGTH OF ANY CUT KERB SHALL BE 450.
7. THE KERB UPSTAND FOR TYPE CC1 SHALL BE 100 UNLESS OTHERWISE STATED, EXCEPT OVER BRIDGES WHERE IT SHALL BE AS SHOWN ON THE SCHEME DRAWINGS.
8. DEPTH OF SURFACE COURSE OVER KERB BED TO BE AS SPECIFIED FOR ADJACENT SURFACE COURSE (MINIMUM 40).

REV	AMENDMENTS	DATE	CAD	CHKD	APPD

CONSULTANT



STUART JARVIS BSc DipTP FCIHT MRTPI: DIRECTOR OF ECONOMY, TRANSPORT & ENVIRONMENT

SCHEME

STANDARD DETAILS

DRAWING TITLE

COUNTRYSIDE CLASSIC KERB

HCC CADplot: 24.Mar.2020 at 9:22am		
DRAWN	CHECKED	SCALE @ A3
MC	JPR <i>[Signature]</i>	N.T.S
CAD	APPROVED	DATE
CP	CDP <i>[Signature]</i>	March 2020
DRG No.	REVISION	
HCC11/C/020		

Copyright Hampshire County Council. 2015

All rights, including translation, reserved. No part of this publication may be reproduced, stored in a retrieval system, or transmitted in any form or by any means (electronic, mechanical, photocopied, recorded or otherwise) without the prior written permission of Hampshire County Council. Requests should be directed to the Economy, Transport & Environment Department.