

East Anton South Primary School

NOTE: ALL DEVELOPMENT OUTSIDE RED LINE BOUNDARY IS INDICATIVE ONLY AND DOES NOT FORM PART OF THIS PLANNING APPLICATION.

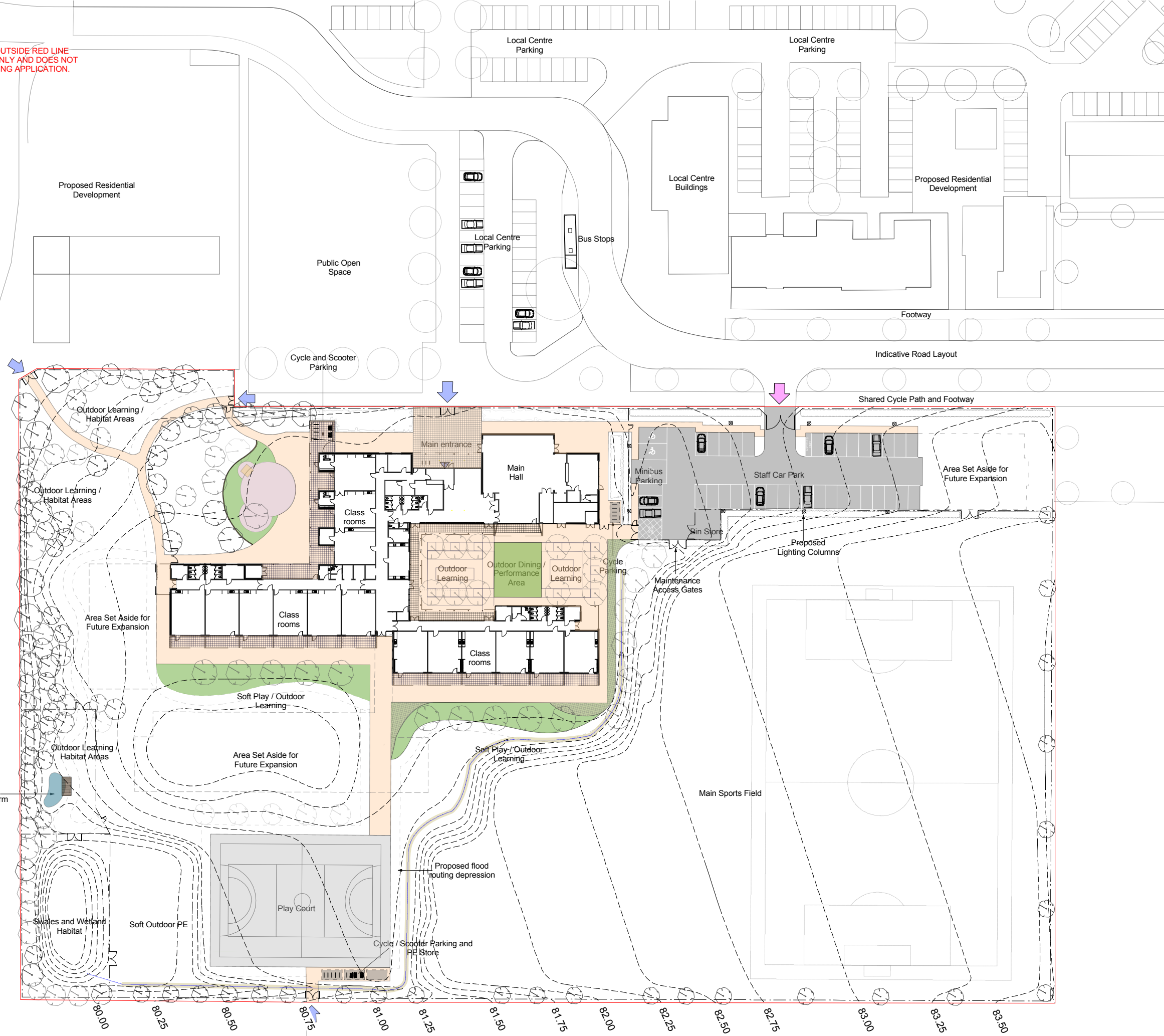

- Site Boundary
- Porous asphalt paving to all footpaths / informal hardplay spaces
- 400 x 400mm, buff colour non porous slab paving to classroom thresholds and main entrance.
- Porous black asphalt to play court
- Non porous black asphalt to car park
- Re-inforced grass surface for maintenance access.
- Artificial grass for all weather play.
- Wetpour surfaces to Early Years playground. Colour TBC.
- Hardwood timber sleeper seating wall to Early Years playground.

Fencing - Refer to drawing P10294-L-74 Fencing Specification and Setting Out for details.

Note: For soft landscape / planting details refer to drawing P10294-L-73 Soft Landscape External Works Plan.

Contours shown are indicative only and represent the Stage D cut and fill strategy FOR DEVELOPMENT.



PLANNING

Hard Landscape External Works Plan

1 : 800@ A3 1 : 400@ A1



P10294 L 72A

November 2015
A Updated Contour Layout 22.01.15 GL