

SOUTHLEIGH RD.

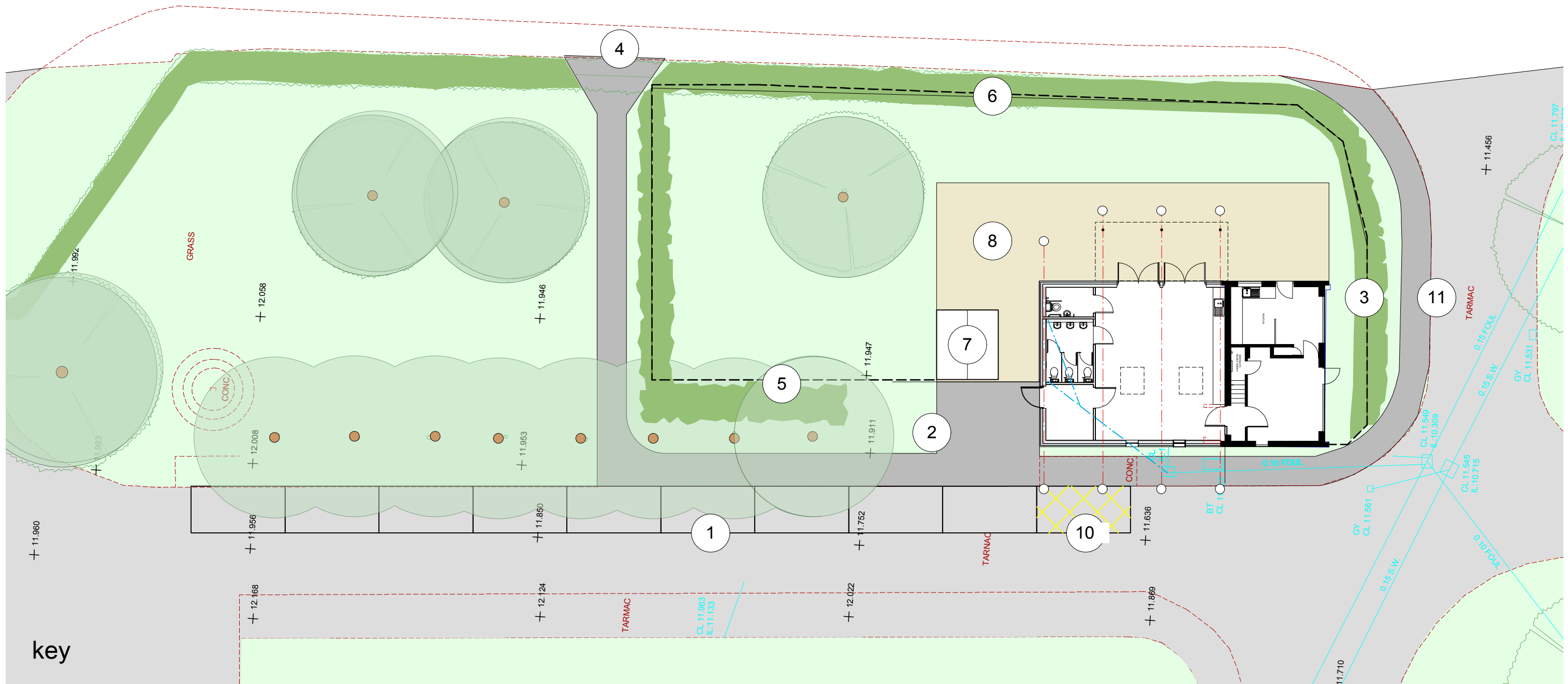

key

- 1 parking bays designated for pre school drop off
- 2 remove 2 no. trees.
- 3 remove leylandii hedge and replace with lower growing species e.g. hawthorn.
- 4 new pedestrian gated entrance from Southleigh Road
- 5 solid timber fence 2.1m high facing school (20m run)
- 6 1.6m high steel railings painted black behind existing hedge. (65m run)
- 7 play equipment shed
- 8 rubber crumb play surface 130m²
- 9 detailed soft landscaping proposals to be submitted.
- 10 accessible parking bay
- 11 new footpath for secondary school pupils subject to safe routes to schools funding.
- 12. new macadam timber edged footpath (94m²)

Planning



HCC Property Services,
Three Minsters House,
76 High Street, Winchester SO23 8UL.
tel: (01962) 847801

Notes	
1 This drawing is © copyright Hampshire County Council 2013. No unauthorised reproduction permitted. All rights reserved.	3 This map is reproduced from Ordnance Survey material with the permission of Ordnance Survey on behalf of the controller of Her Majesty's Stationery Office © Crown Copyright. Unauthorised reproduction infringes Crown Copyright and may lead to prosecution or civil proceedings. (100019180), (2013)
2 No dimensions are to be scaled from this drawing	

rev	description	date	by

PROJECT				SHEET CONTENTS	
Warblington School Sports Development				Proposed Site Plan Pre School	
SCALE	DATE	DRAWN.	CHKD.	DRAWING No.	REVISION
1:200	12.4.13	MJC	---	PO9949 - PL- 102	
				FILE REF.	PO9949 Pre School Planning Set

