

## HAMPSHIRE COUNTY COUNCIL

### Officer Decision Record

<b>Decision Maker:</b>	Adrian Gray
<b>Title:</b>	The Hampshire (Stockbridge) (Restricted Roads and 30 Miles Per Hour Speed Limit) Order 2015
<b>Reference:</b>	C734

**Tel:** 01962 846997

**Email:** Adrian.gray@hants.gov.uk

#### 1. The decision:

- 1.1. That a Traffic Order be implemented under the Road Traffic Regulation Act 1984, the effect of which will be to extend the existing Restricted Road status (30 mph) on that length of A30 London Road between its roundabout junction with A30 High Street and a point 395 metres north-east thereof (currently de-restricted).

#### 2. Reasons for the decision:

- 2.1. The extension of the 30 mph speed limit on A30 London Road, Stockbridge is proposed in association with a parking scheme to provide a new parking layby for 32 cars on the western side.

This will require carriageway widening of approximately 1.5m on the eastern side which will allow for a 3.5m wide parking layby plus two 3m wide traffic lanes. The existing school bus stand will be retained at its current location and the new parking layby will be defined by kerbed build outs.

Additionally a new footway link with uncontrolled dropped crossing points is proposed to the south of the proposed layby across the roundabout splitter island to link with an existing footway and an uncontrolled crossing point opposite the White Hart PH and linking to Stockbridge Primary School.

The proposal seeks to extend the 30 mph speed limit by around 300m and it is considered that it will have a road safety benefit given the increase in pedestrian activity on this route as a result of the proposed parking layby.

#### 3. Other options considered and rejected:

- 3.1. None

#### 4. Previous Orders

4.1 In addition, the Traffic Order shall contain the same provisions as set out in:

- (i) The Hampshire County Council (Restricted Roads) (No.4) Order 1961
- (ii) The Hampshire (B3049 Old Winton Hill, Stockbridge) (Restricted Road) Order 1995
- (iii) The Hampshire (Various Roads, Stockbridge/Longstock) (30 and 40 Miles Per Hour Speed Limit) Order 2012
- (iv) The County Council of the County of Southampton (Built-Up Areas) Order 1935 - *insomuch as it relates to Romsey and Stockbridge Rural District.*
- (v) The Hampshire (Various Roads, Stockbridge, Romsey, Braishfield and Ampfield) (Restricted Road, 30, 40 and 50 Miles Per Hour Speed Limit) Order 2015 - *insofar as it relates to A3057 Stockbridge to Kings Somborne road and Marsh Court Road.*

and shall revoke those Orders.

#### 5. Conflicts of interest:

5.1. None.

#### 6. Dispensation granted by the Head of Paid Service:

6.1. None.

#### 7. Supporting information:

7.1. File Reference: C734

Approved by:

Date: 18/3/2015



Adrian Gray, Head of Highways (Traffic Manager)

On behalf of the Director of Economy, Transport and Environment

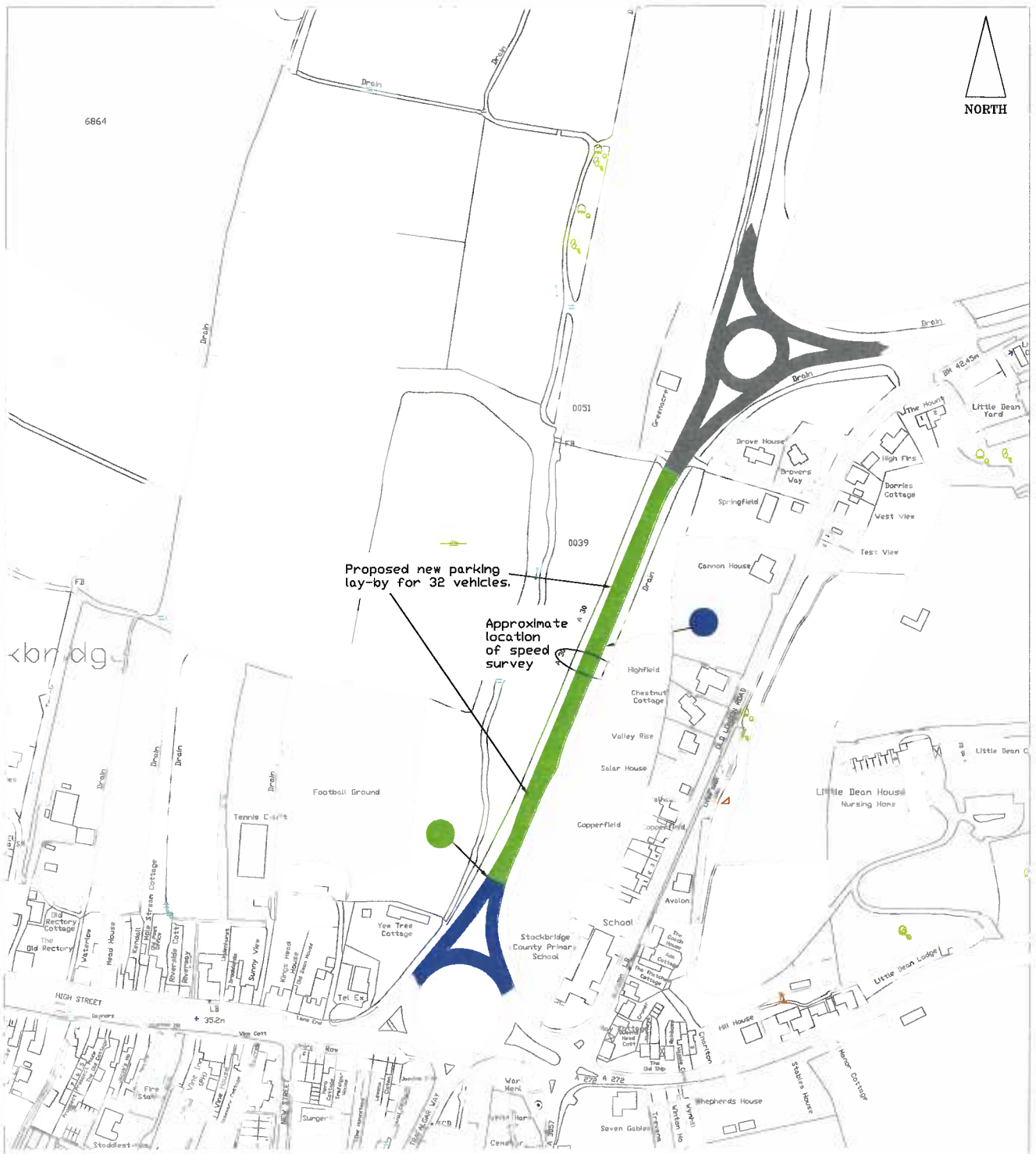

Proposed new parking lay-by for 32 vehicles.

Approximate location of speed survey

**PROPOSED SPEED LIMIT**

 Proposed 30mph speed limit (reduction from derestricted)

**EXISTING SPEED LIMIT**

 Existing 30mph speed limit

 Existing derestricted speed limit

**ACCIDENT DATA**

Recorded injury accident data for the five year period 1st Sept 2009 to 31st Aug 2014.

 Slight

 Serious

**TRAFFIC SPEED DATA**

Traffic Survey 30th October 2014 to 7th November 2014, between the roundabout junction with High Street and roundabout junction with A30, London Road.

Mean Speed - 41.7mph