

SCHEME	A27 St Margaret's Roundabout, Fareham	 SOLENT LOCAL ENTERPRISE PARTNERSHIP
DELIVERY TIMESCALE	2015/16	

Overview

Improvements at St Margaret's Roundabout form part of an overarching strategy to improve access to Fareham and Gosport seeking to facilitate economic growth in the area and fundamentally to bring forward development at the Solent Enterprise Zone and Welborne. Improvements to the A27 corridor between Fareham town centre and Segensworth roundabout are also essential to help improve access and egress to the peninsula and to help improve accessibility between the town centre and wider area and existing employment based around Segensworth and Whiteley, where congestion frustrates new investment.

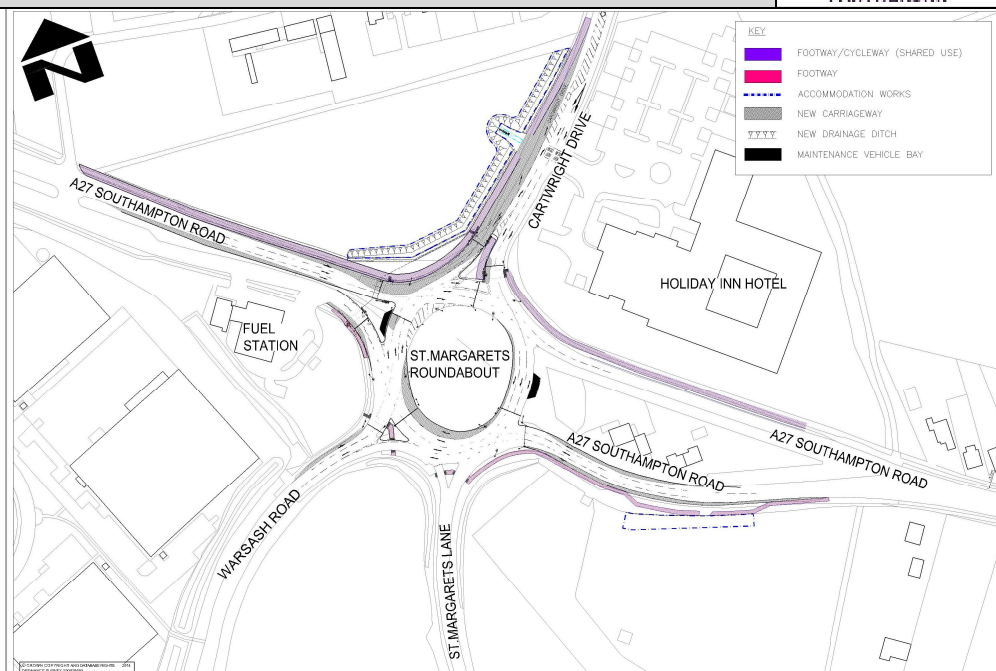

The scheme forms the first part of a phased programme of improvements for the A27 including upgrading the single carriageway sections of the A27 adjacent to St Margaret's roundabout to provide two lanes in each direction. The improvements to the roundabout will remove a significant constraint point on the network by providing additional capacity primarily to assist the east west movements on the A27. Traffic signal control is added on all arms except St Margaret's Lane. Improvements are provided to assist pedestrian and cyclists to facilitate crossing movements across this busy junction.

The scheme requires land outside the highway boundary which is owned by Hampshire County Council being part of the Hampshire Farms estate. Mitigation in the form of new and replacement landscape planting along with mitigation to help overcome minor ecological issues is currently being developed. The scheme does not require planning permission.

Project Costs:

Estimated scheme value £m:	4.60
LEP Local Growth Fund (LGF) contribution £m:	3.0
Local match funding £m:	1.6

Outline Programme	2014/15		2015/16				2016/17			
	Q3	Q4	Q1	Q2	Q3	Q4	Q1	Q2	Q3	Q4
Preliminary Design	■									
Full Business Case		■								
Detailed Design		■	■							
Project Appraisal			■							
Advance Works		■	■	■						
Construction					■	■	■	■	■	

SCHEME	B3334 / B3385 Peel Common Roundabout, Fareham	 SOLENT LOCAL ENTERPRISE PARTNERSHIP
DELIVERY TIMESCALE	2015/16	

Overview:

Improvements at Peel Common Roundabout form the second stage of an overarching strategy to improve access to Fareham and Gosport seeking to facilitate economic growth in the area and fundamentally to bring forward development at the Solent Enterprise Zone and Welborne.

- The installation of traffic lights on the Newgate Lane, Rowner Road and Broom Way approaches to the roundabout;
- Widening on the Newgate Lane approach to the roundabout to improve traffic capacity;
- The provision of additional lanes on the roundabout between Newgate Lane and Rowner Road to improve traffic capacity;
- Widening on the Rowner Road approach to the roundabout;
- The provision of shared use footway / cycleway around the south side of the roundabout;
- No third party land or planning permission is required.

Scheme Objectives:

- To manage traffic flows on the signalised arms of the roundabout particularly between Newgate Lane and Rowner Road, and from Broom Way;
- To improve facilities for pedestrians and cyclists by providing better linkage between the existing shared use facilities on the north side of the roundabout and those on the south side of Gosport Road and on Broom Way;
- To prepare the roundabout for further improvements, which would be required with the proposed Stubbington Bypass and Newgate Lane (South) schemes respectively.

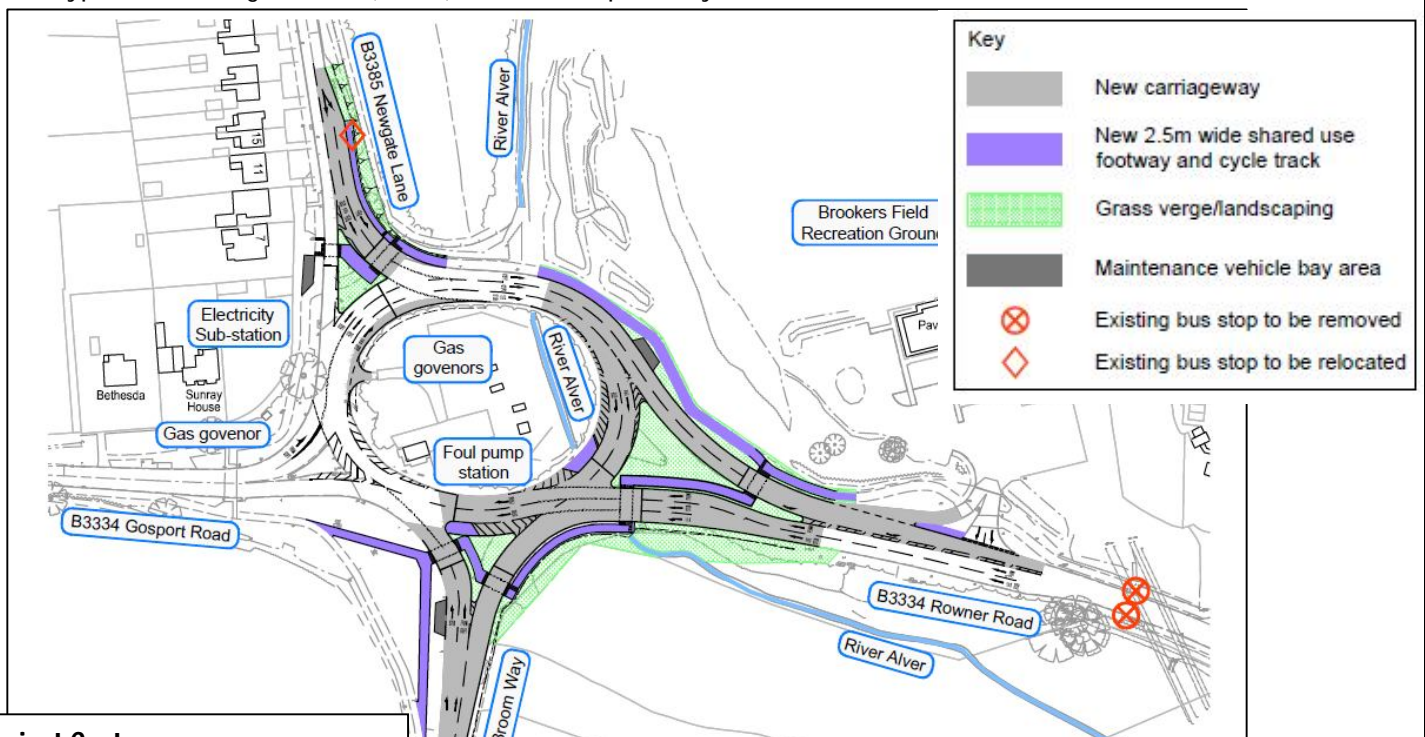
**Project Costs:**

Estimated scheme value £m:	3.25
LEP Local Growth Fund (LGF) contribution £m:	2.0
Local match funding £m:	1.25

Outline Programme

	2014/15		2015/16			
	Q3	Q4	Q1	Q2	Q3	Q4
Preliminary Design						
Full Business Case						
Detailed Design						
Project Appraisal						
Advance Works						
Construction						

SCHEME	A27 Bishopsfield Road to Station Roundabout and Fareham Train Station, Fareham	
DELIVERY TIMESCALE	2016/17	

Overview

- At the A27/ Gudge Heath Lane signalised junction, the A27 westbound lane will be widened from one lane to two, retaining the dedicated right hand turn into Gudge Heath Lane. A new Toucan Crossing across the A27 will be provided at the A27 Gudge Heath Lane junction.
- A new bus layby and shelter on the eastbound A27 will be provided at the A27's entry to

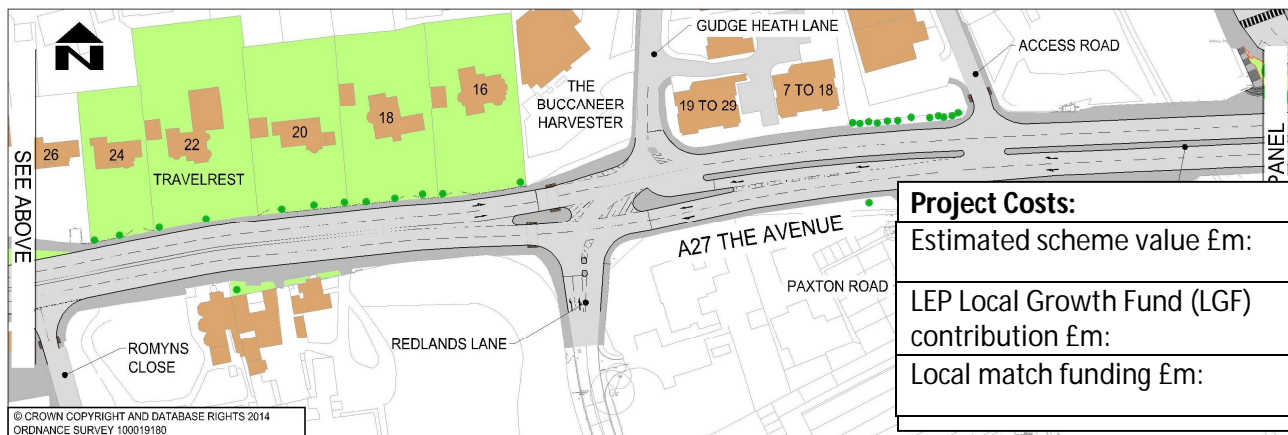
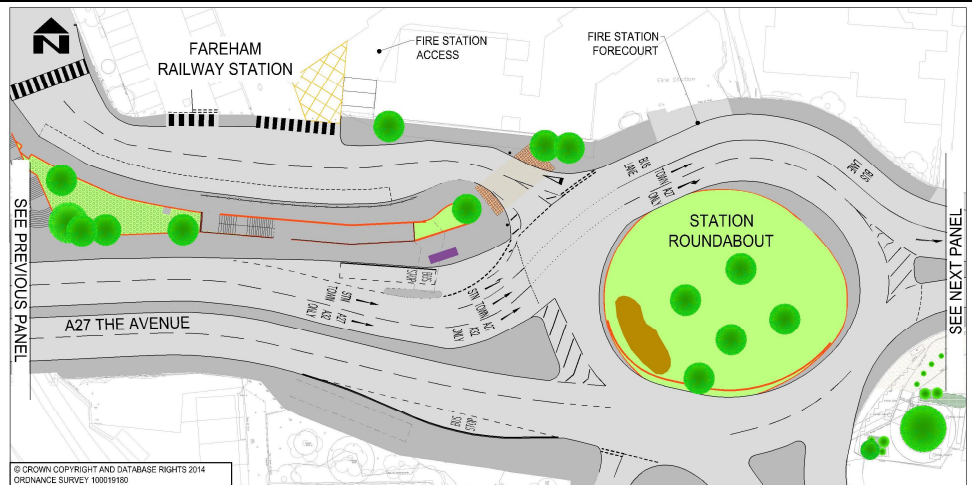

Project Costs:	
Estimated scheme value £m:	6.61
LEP Local Growth Fund (LGF) contribution £m:	4.96
Local match funding £m:	1.65

Station Roundabout. A new dedicated bus lane will be provided adjacent to the bus stop. Shared use urban realm enhancements will be delivered on the northern side of the roundabout will provide a link for pedestrians and cyclists from West Street to the train station, complementing recent similar works delivered in West Street. The existing steps connecting the A27 (The Avenue) with Fareham railway station forecourt, will be widened and improved. The existing carriageway on Station Approach up to the railway station forecourt will be resurfaced.

- The scheme requires third party land to be secured and planning permissions for new boundary treatments.

Objectives:

- Reduce congestion and delay on the westbound A27 in the evening peak, where queues currently form back through Station roundabout and along the A27 from both the Delme roundabout and towards M27 Junction 11.
- To improve modal interchange between the Eclipse and other bus services and trains at Fareham Train Station
- To deliver public realm improvements that will enhance the quality of the pedestrian route from Fareham Train Station to West Street and Fareham town centre.

Outline Programme

	2014/15			2015/16				2016/17			
	Q2	Q3	Q4	Q1	Q2	Q3	Q4	Q1	Q2	Q3	Q4
Preliminary Design	■	■									
Detailed design			■	■	■	■	■	■			
Project Appraisal		■									
Land Acquisition				■	■	■	■				
Advance works							■				
Construction works								■	■	■	■

