

COMMENTS / OBSERVATIONS

KEY TO SYMBOLS

- Existing Building
- Extension/New Building
- New Internal Walls
- Contractor Access
- Vehicular Access
- Pedestrian Access
- Contractors Working Area

NOTE:
Position of drainage and location of trees and shrubs indicative only, please check on site for accurate location.

PARKING:
Existing car park spaces 19no
261 pupils (7-11yrs) 2FE
8 classrooms of 30 and more pupils
1.5 spaces per classroom = 12no spaces
1no accessible space
Total spaces required for school = 13no

MLD unit - 5 FTS and 1no PTS required
parking spaces 0.75 per FTS = 4no spaces

Spaces required for CC 2no + 1no accessible space

Total parking required for this site including school, MLD unit and CC - 20 spaces - therefore 1no additional spaces required

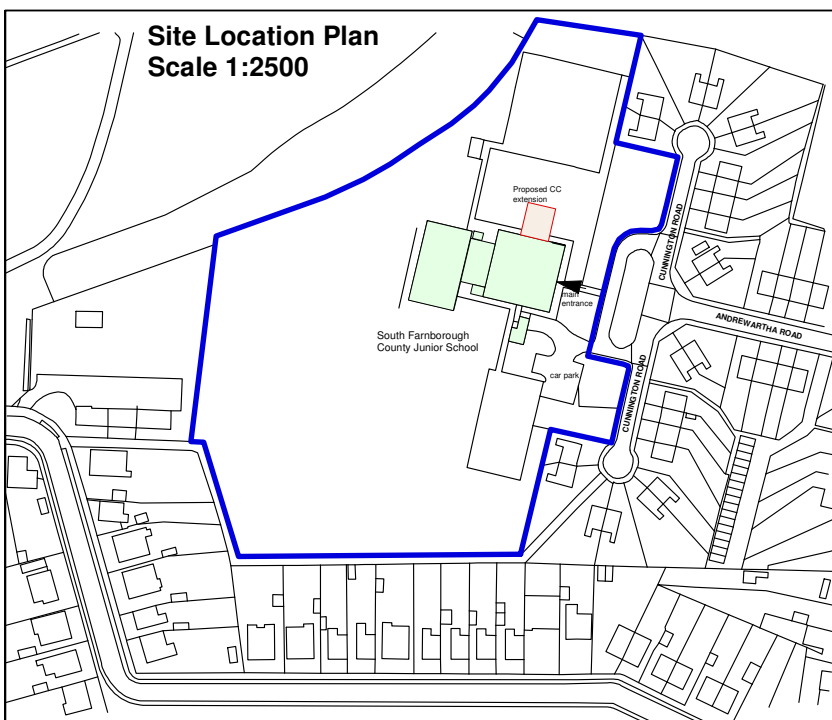

South Farnborough County Junior School

grassed playground

Proposed single storey CC extension approx 104sqm

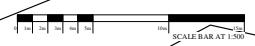
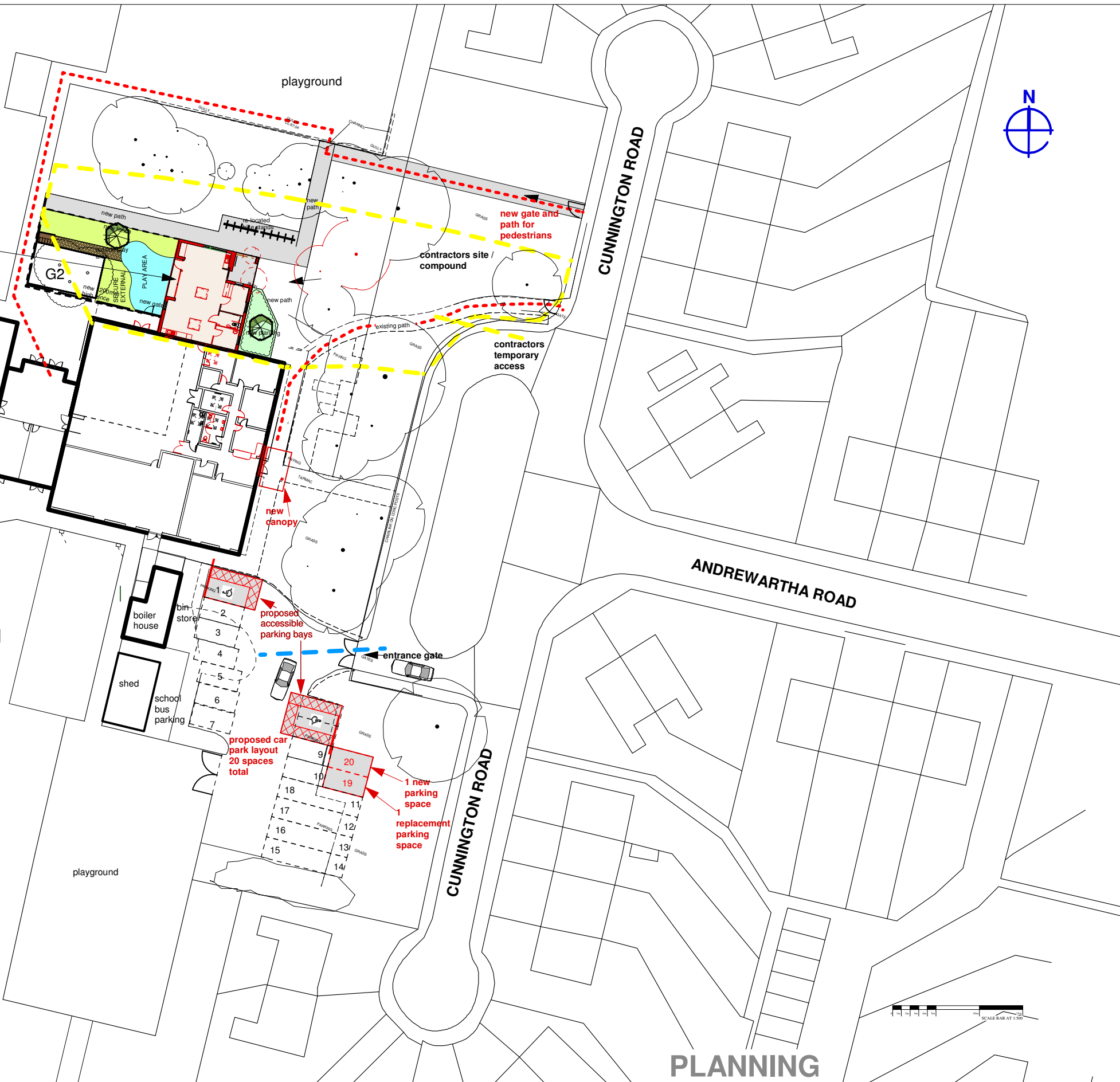

PLANNING



Property, Business and Regulatory Services,
Three Ministers House,
76 High Street, Winchester SO23 8UL.
tel: (01962) 847801

Notes

- This drawing is © copyright Hampshire County Council 2005. No unauthorised reproduction permitted. All rights reserved.
- No Dimensions to be scaled from this drawing
- This map is reproduced from Ordnance Survey material with the permission of Ordnance Survey on behalf of the controller of Her Majesty's Stationary Office © Crown Copyright. Unauthorised reproduction infringes Crown Copyright and may lead to prosecution or civil proceedings. LA079651, 2006

rev	description	date	by
A	Assumed drainage added	16.3.09	ZM
B	Temporary path revised	20.3.09	ZM
C	Proposed planting removed	6.4.09	ZM
D	Approval issue	5.5.09	ZM
E	Revised following meeting with client on 6.5.09	7.5.09	ZM
F	Planning issue	19.8.09	ZM
G	Temporary pedestrian access revised	14.10.09	ZM
H	Planning issue	3/12/09	AD

PROJECT South Farnborough Junior Cunnington Road Farnborough		R7	SHEET CONTENTS Proposed Children's Centre Proposed Site Plan	
SCALE 1:500 @ A1 @ A3	DATE 11.12.2009	DRAWN. AD	DRAWING No. P8242-102 FILE REF. P8242-102-Location Plan	REVISION H