

New Pedestrian Path linking corner of Junior Playground with existing path behind Bransley Close

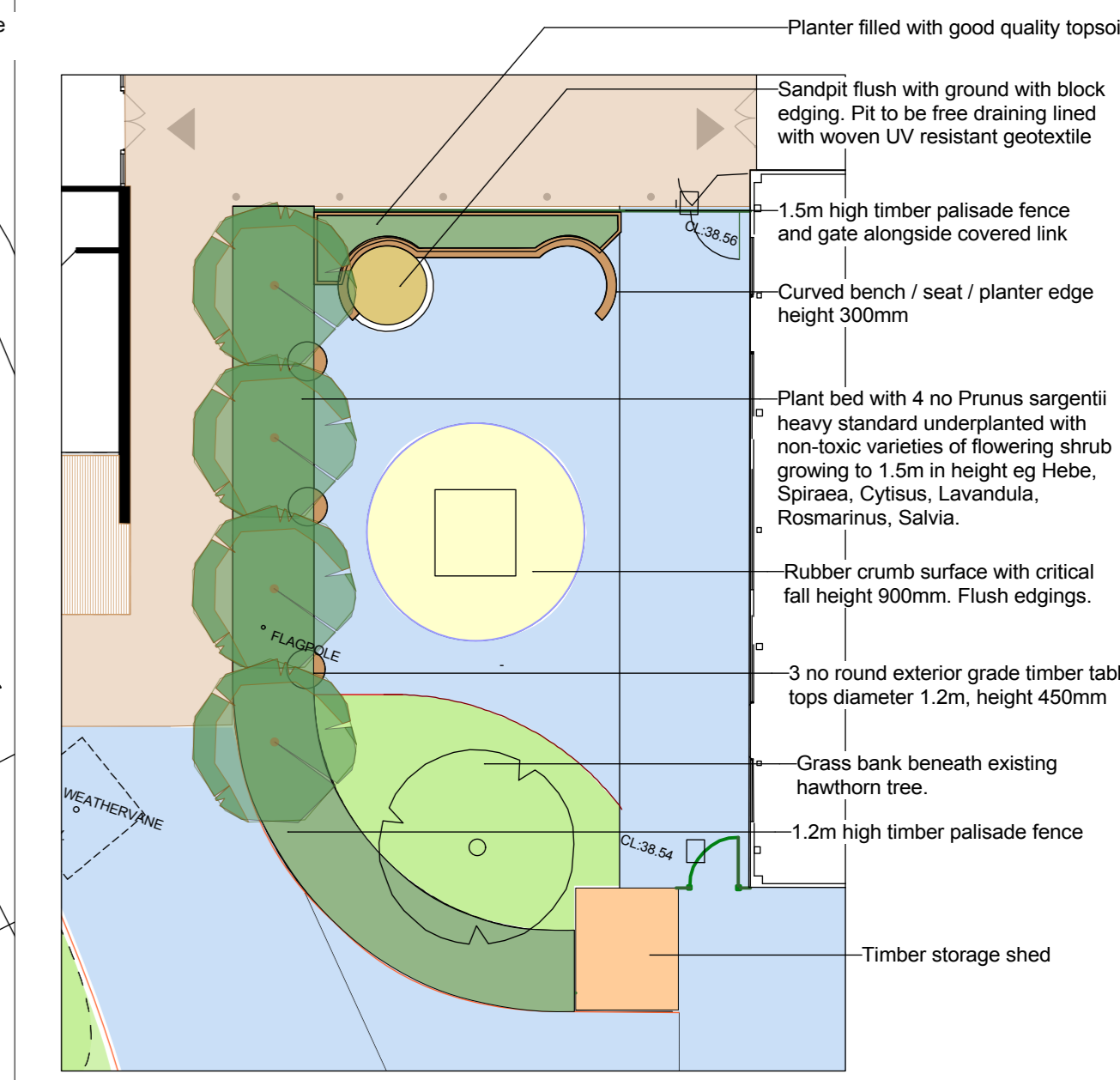

Year R Outdoor Area, Scale 1:200 @ A1

rev	description	date	by
A	Additional features in Pre-School area - screening, shed & rubber crumb.	30.4.12	PD
	Caravans store added	15.5.12	PD
B	Alterations within enlarged tree root protection areas	23.05.12	PD

Notes

1 This drawing is © copyright Hampshire County Council 2008. No unauthorised reproduction permitted. All rights reserved.

2 No dimensions are to be scaled from this drawing

3 This map is reproduced from Ordnance Survey data with the permission of Ordnance Survey on behalf of the controller of Her Majesty's Stationery Office © Crown Copyright. Unauthorised reproduction infringes Crown Copyright and may lead to prosecution or civil proceedings. LA070051, 2008

Works Information

PROJECT		SHEET CONTENTS			
Cupernham Infant and Junior Schools 3FE Extension		Landscape Proposed Site Layout			
SCALE	DATE	DRAWN	DRAWING No.	REVISION	
1:250 @ A1 1:500 @ A3	15/05/2012	ARCDPD	P9194-04	B	
FILE REF.		Cupernham Feasibility Landscape Plan			