

RIGID TIPPER ENTERING SITE FROM BASINGSTOKE DIRECTION

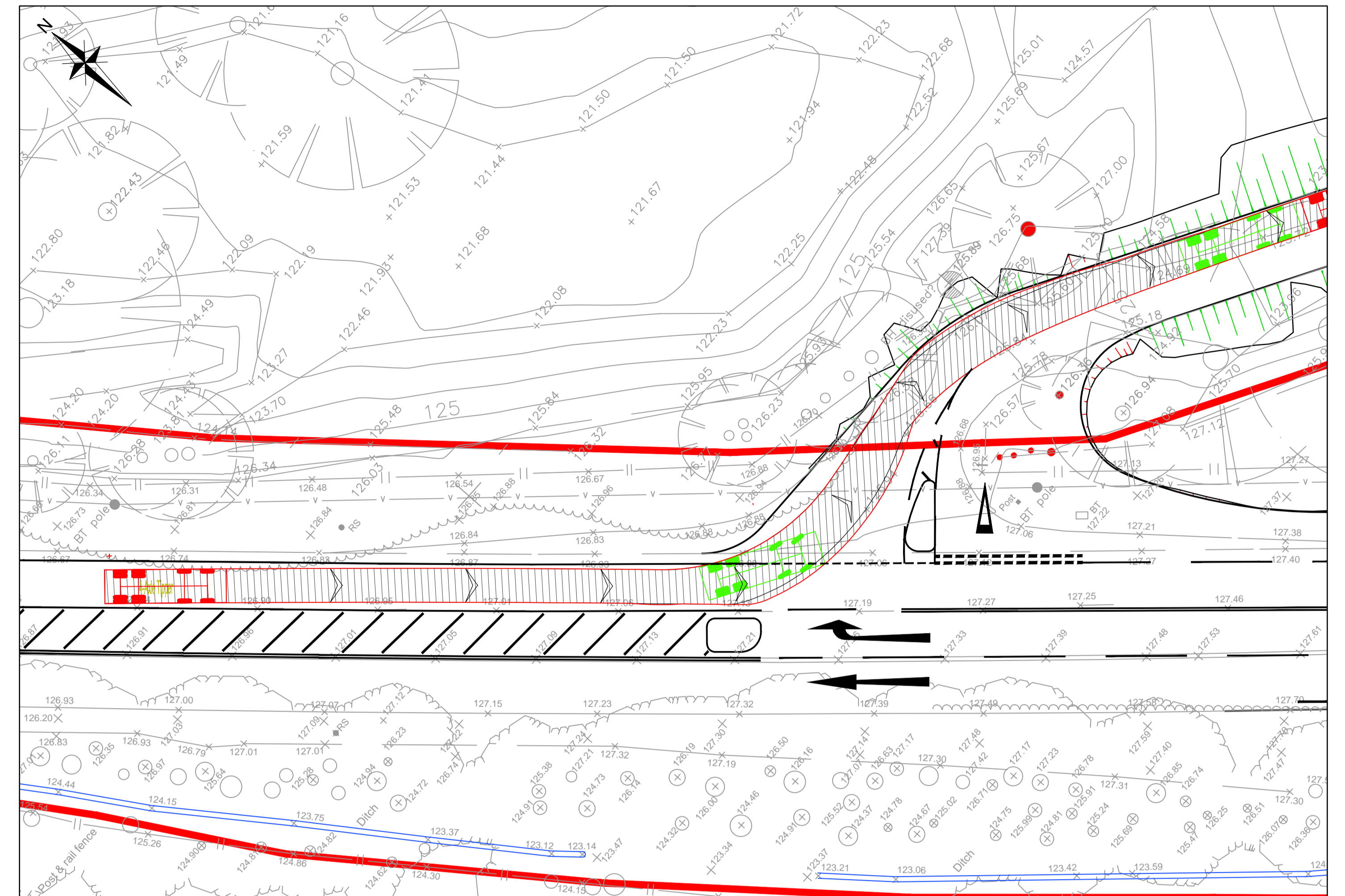

RIGID TIPPER ENTERING SITE FROM NEWBURY DIRECTION

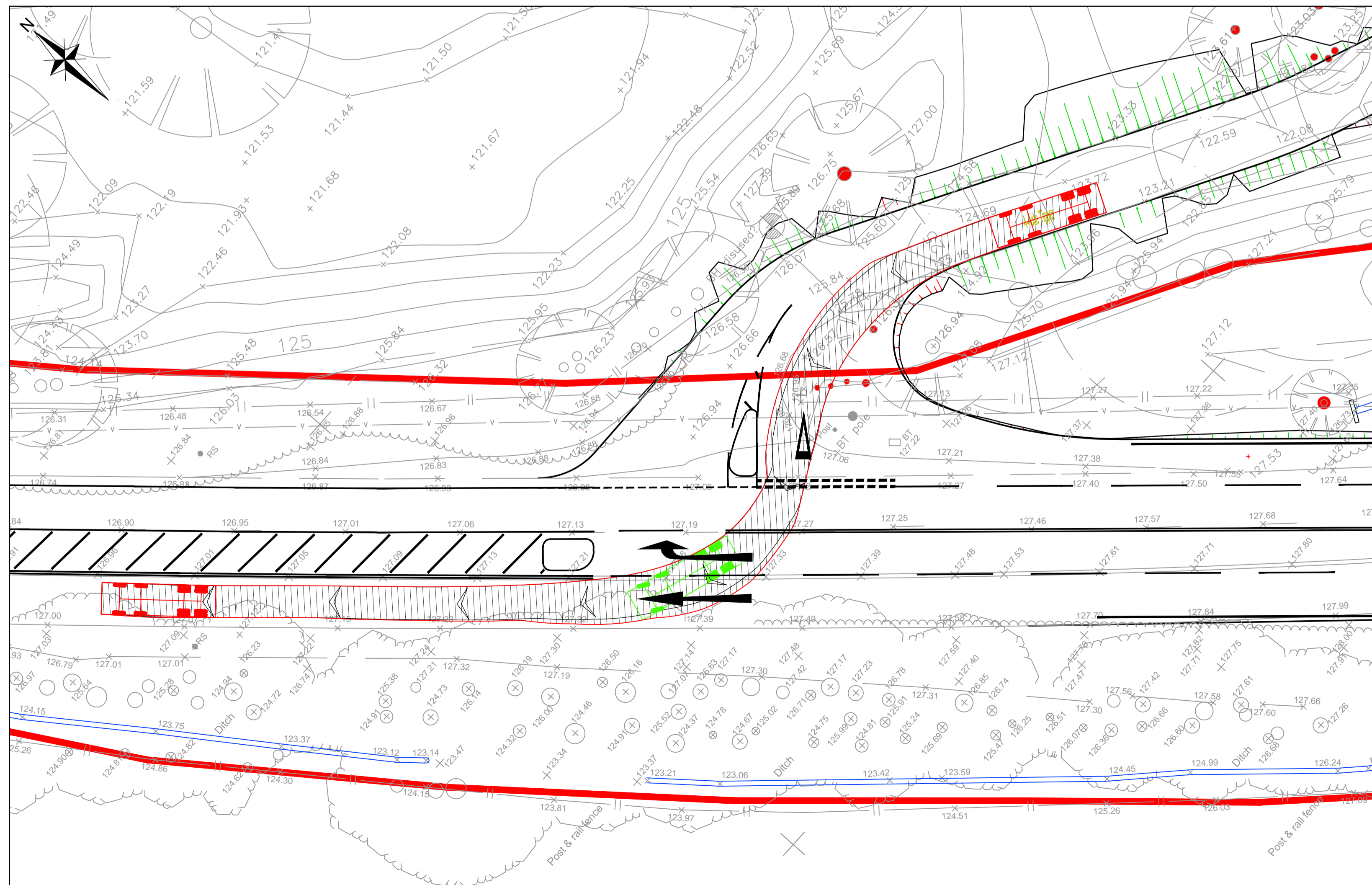

RIGID TIPPER EXITING SITE IN THE NEWBURY DIRECTION

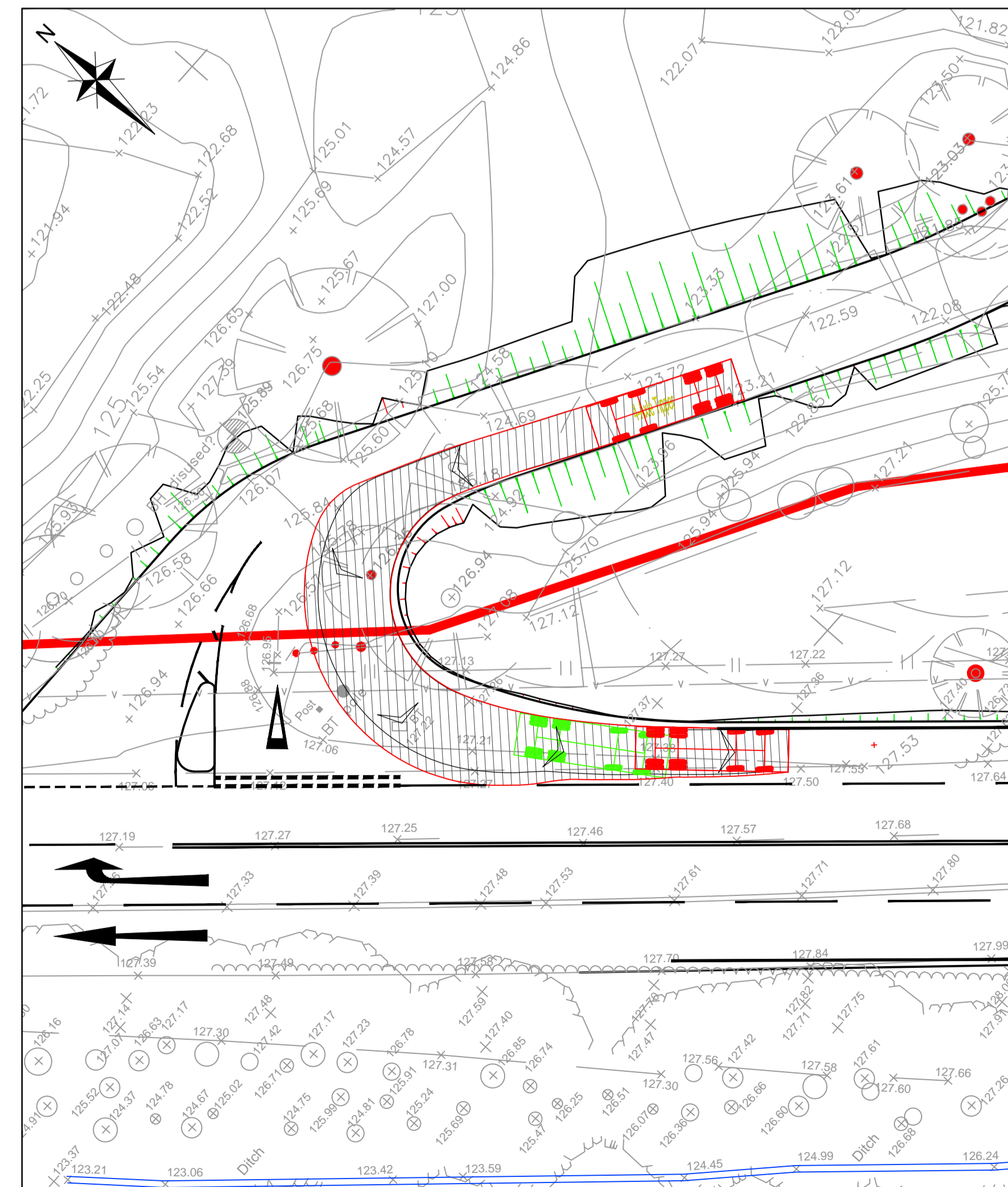

RIGID TIPPER EXITING SITE IN THE BASINGSTOKE DIRECTION

KEY

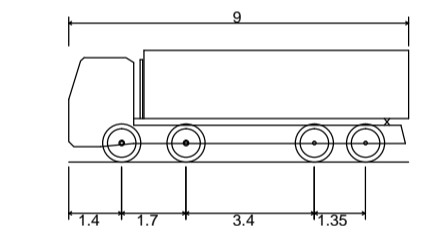

- 4-Axle Tipper
- Overall Length 9.000m
- Overall Width 2.500m
- Overall Body Height 2.958m
- Min Body Ground Clearance 0.408m
- Track Width 2.500m
- Lock to Lock Time 5.00s
- Kerb to Kerb Turning Radius 10.500m

B	UPDATED TO SUIT REVISED JUNCTION LAYOUT	ND	RS	BAC	06.09.13
A	UPDATED TO SUIT LATEST LAYOUT	ZB	RS	BAC	20.08.13
Rev	Amendments	Dm	Chk	Appr	Date

Odyssey
consulting engineers

Taney House
White Hart Lane
Basingstoke
Hampshire RG21 4AP

Telephone: 01256 331144
Fac: 01256 331144
Email: enquiries@odyssey-co.co.uk
Web: www.odyssey-co.co.uk

**KINGSLCLERE QUARRY - PROPOSED
MATERIALS RECYCLING AND
TRANSFER LOADING STATION**

Drawing Title
**RIGID TIPPER
SWEEP PATH ANALYSIS**

Client
JOHN STACEY & SONS

Scale	1:250@A1	Date	JUNE 2012	Designed	RS
Drawn	ND	Checked	RS	Approved	BAC
Job No	09-044	Drawing No	09-044/GA/209	Rev	B