

ber shall be free of splits and twists.

ed timber shall be sanded smooth to ensure splinters do not occur to any face after installation.

2 joins and mitres occur the timber shall be carefully finished so that the timbers butt joint tightly and no sharp corners are created. Corners shall be chamfered

ber shall be softwood, Tanalith E Preservative treatment (or similar approved non arsenic treatment) with a desired service life 20 years. All timber cuts shall be brushed with preservative to manufacturers recommendations.

ng to be grooved and have anti slip carborundum strips (min two per board).

Its to be threaded coach bolts stainless steel and to be recessed into timber to present flush finishes. Where screws are surface mounted and visible ink and plug.

mesh to cut to panels to fit each bay. Cuts to wire edge. Protruding wires to be trimmed back to panel edge leaving no sharp points. Panels to be arranged so wires run horizontally and vertically, not with the gradient.

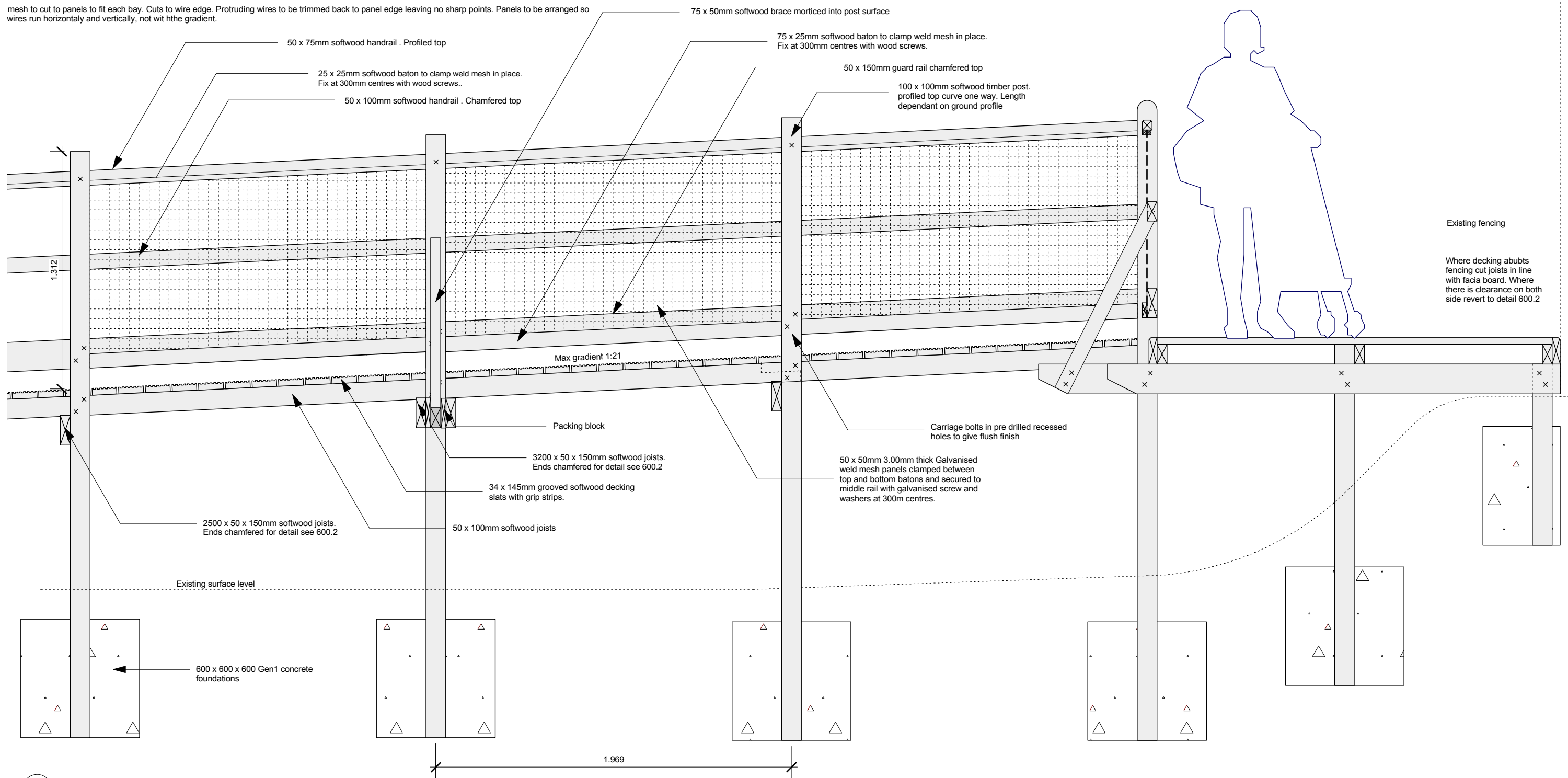

Detail 601.1 Typical boardwalk section and elevation AA Scale 1/20

Notes	
1 This drawing is © copyright Hampshire County Council 2009. No unauthorised reproduction permitted. All rights reserved.	3 This map is reproduced from Ordnance Survey material with the permission of Ordnance Survey on behalf of the controller of Her Majesty's Stationery Office © Crown Copyright. Unauthorised reproduction infringes Crown Copyright and may lead to prosecution or civil proceedings. (100019180), (2009)
2 No dimensions are to be scaled from this drawing	

rev	description	date	by

PROJECT			SHEET CONTENTS	
Whiteley Primary School			External Works	
Gull Coppice			Detail Plan	
Whiteley PO15 7LA			Elevations 1	
SCALE	DATE	DRAWN.	DRAWING No.	REVISION
1/20 @ A3 @ A1	Jan 2010	WP	P8771-L-601	
FILE REF.			File name	