

IMPORTANT
 Do not scale from this drawing, use figured dimensions only. If in doubt ask Douglas Briggs Partnership (01243-576611 or architecture@douglasbriggspartnership.co.uk)
 All dimensions must be checked on site prior to commencement of works and fabrication.
 This drawing/document is to be read in conjunction with other consultants/suppliers information and the Architects contract drawings and specifications etc.
 Any discrepancies between different pieces of information that have been supplied shall be notified immediately to Douglas Briggs Partnership.
 Any departure from dimensions provided by DBP and the locations, positions or dimensions given in Planning and Building Control approvals shall be notified to Douglas Briggs Partnership prior to departure.
 This design and copyright remains the property of Douglas Briggs Partnership LLP unless expressly released in writing by Douglas Briggs Partnership LLP.

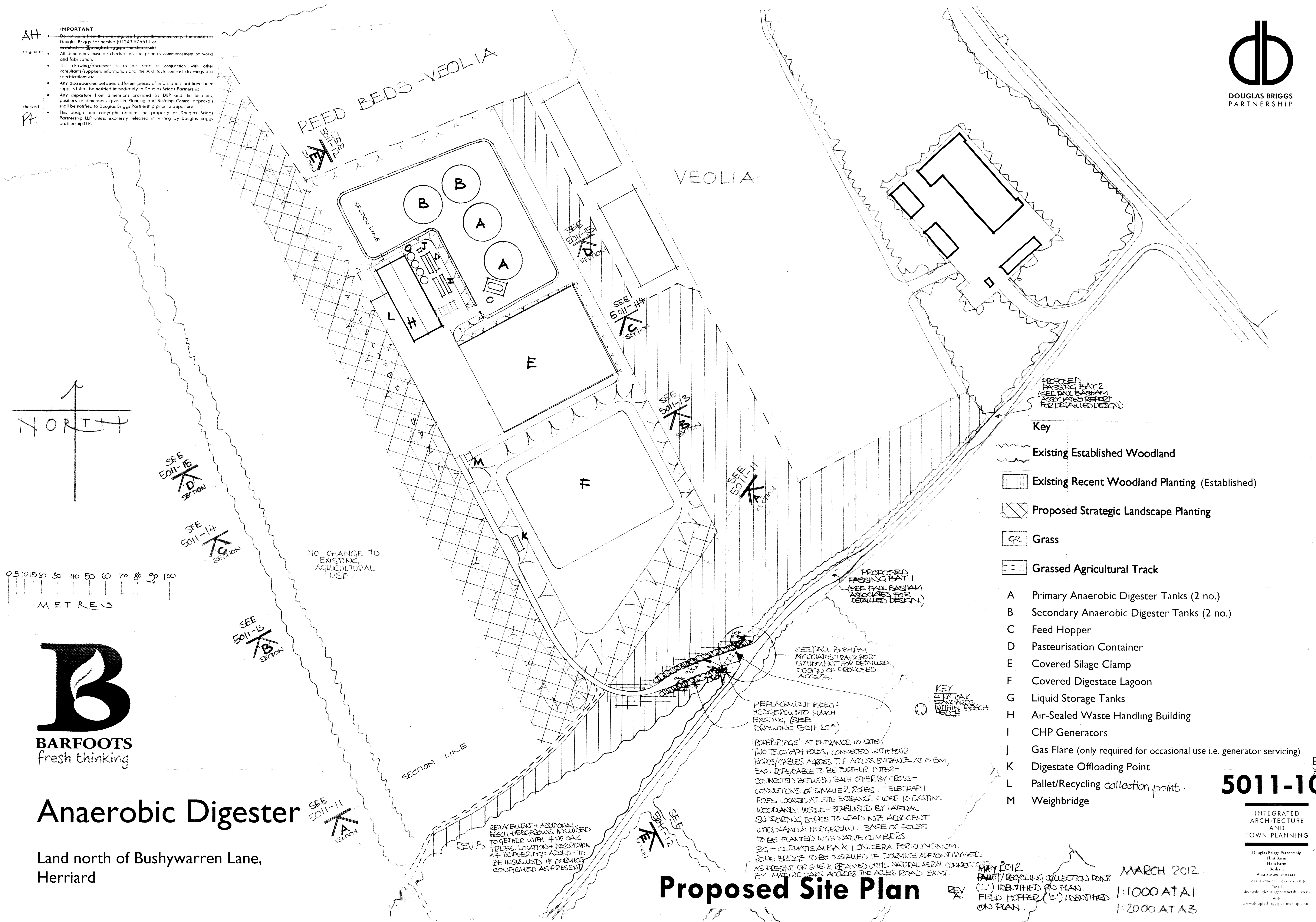

- Key**
- Existing Established Woodland
 - Existing Recent Woodland Planting (Established)
 - Proposed Strategic Landscape Planting
 - Grass
 - Grassed Agricultural Track
- Legend**
- A Primary Anaerobic Digester Tanks (2 no.)
 - B Secondary Anaerobic Digester Tanks (2 no.)
 - C Feed Hopper
 - D Pasteurisation Container
 - E Covered Silage Clamp
 - F Covered Digestate Lagoon
 - G Liquid Storage Tanks
 - H Air-Sealed Waste Handling Building
 - I CHP Generators
 - J Gas Flare (only required for occasional use i.e. generator servicing)
 - K Digestate Offloading Point
 - L Pallet/Recycling collection point
 - M Weighbridge

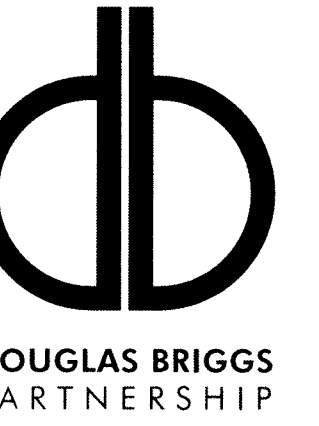

Anaerobic Digester

Land north of Bushywarren Lane, Herriard

Proposed Site Plan

5011-10

INTEGRATED ARCHITECTURE AND TOWN PLANNING

Douglas Briggs Partnership
 Elm Barns
 Ham Farm
 Bosham
 West Sussex PO18 8EH
 01243 576611 01243 576116
 Email
 info@douglasbriggspartnership.co.uk
 Web
 www.douglasbriggspartnership.co.uk

MAY 2012
 PALETTE/RECYCLING COLLECTION POINT ('L') IDENTIFIED ON PLAN.
 FEED HOPPER ('C') IDENTIFIED ON PLAN.

MARCH 2012
 1:1000 AT A1
 1:2000 AT A3