

**St Lawrence CE Primary School
Alton
Expansion to 1 Classroom
per Year Group**

Proposed Site & Building Plans

- Key:
- a St Lawrence CE Primary School
 - b Amery Hill Academy
 - c St Lawrence Church
 - d St Lawrence Churchyard

- Proposed Site Plan:
- 1 Proposed New Classroom
 - 2 Re-located Library Space
 - 3 Existing Hard Play
 - 4 Existing Soft Play

- Teaching - New Build
- Teaching - Refurbishment
- Circulation
- Site Boundary
- Works Area
- Contractor's Compound
- ▶ Pedestrian Access
- ▶ Vehicular Access
- ▶ Contractor Access

© Crown Copyright and database rights 2016. All rights reserved. HCC 100019180.

Project Appraisal
Not to Scale
P10563 - A7434
July 2016

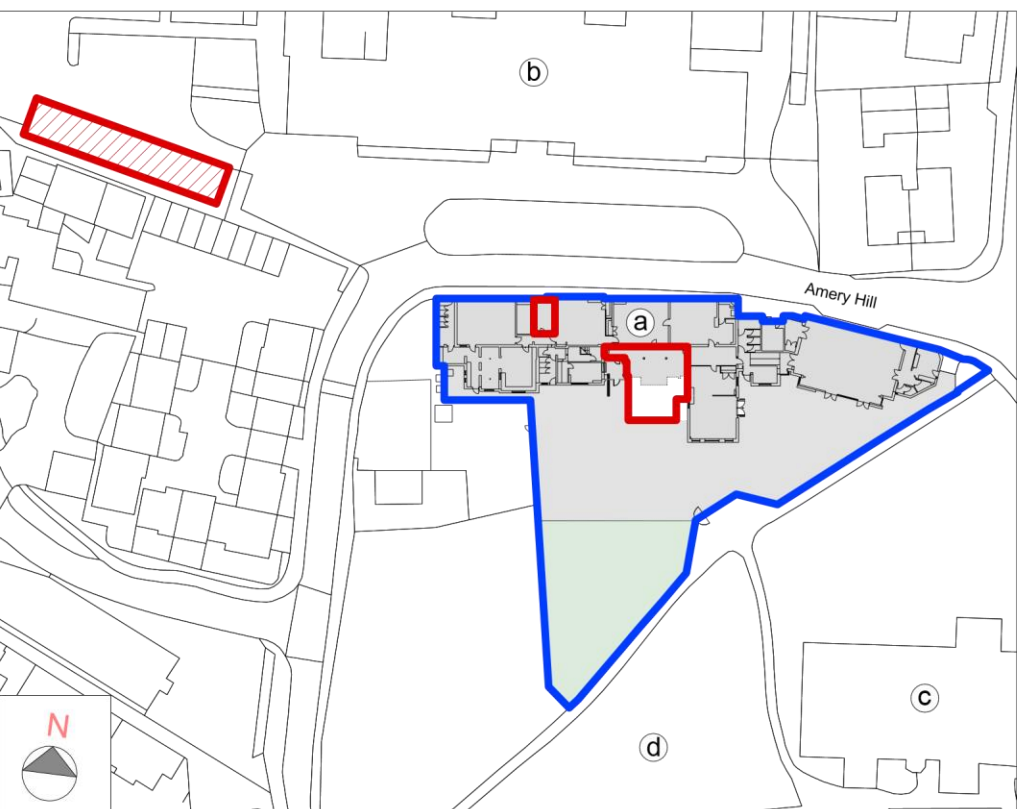

Existing Site Location Plan

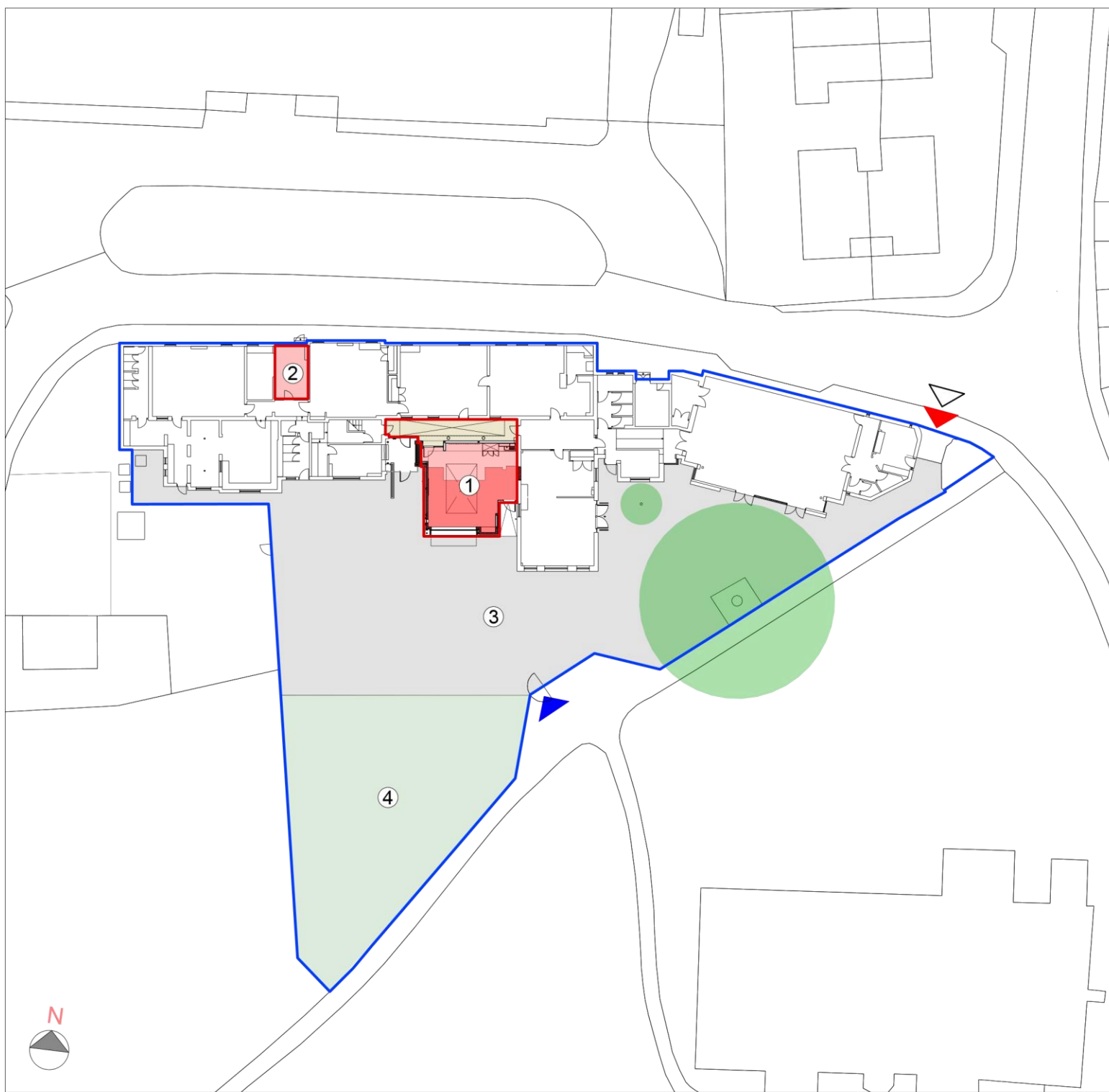

Proposed Site Plan



Proposed South Elevation