

The Butts Primary School Alton

6 Classroom Expansion Proposed Site & Building Plans

Key:

Proposed Site Plan:

- 1 Proposed 6 classroom extension
- 2 Existing Primary School
- 3 Existing Bolle Road Car park
- 4 Existing Playing Field
- 5 Proposed Games Court
- 6 Extended Staff Car Park
- 7 Proposed Habitat Area
- 8 Proposed Soft Play Area
- 9 Existing Early Years Play Area
- 10 Proposed External Teaching Area
- 11 Additional Cycle / Scooter parking
- 12 Proposed Grounds Maintenance Access
- 13 Synthetic Grass Play Area
- 14 Automated Gates

- Development Boundary
- HCC Site Boundary
- ▶ Pedestrian Access
- ▶ Vehicular Access
- ▶ Grounds Maintenance Access
- ▶ Contractor Access

Pedestrian Guardrails

Teaching - New Build

Non-Teaching New Build

Circulation



© Crown Copyright and database rights
2016. All rights reserved. HCC
100019180.

Project Appraisal

Not to Scale

P10697-A-1010

August 2016



Aerial view of proposed new classroom block and canopy to main entrance

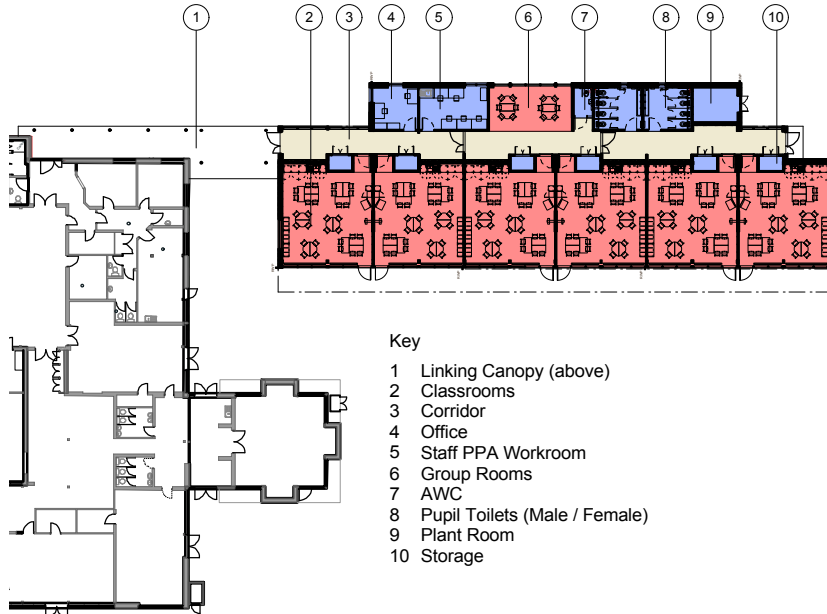

Key

- 1 Linking Canopy (above)
- 2 Classrooms
- 3 Corridor
- 4 Office
- 5 Staff PPA Workroom
- 6 Group Rooms
- 7 AWC
- 8 Pupil Toilets (Male / Female)
- 9 Plant Room
- 10 Storage

Proposed Building Plan



Proposed Site Plan



Section AA - Proposed East Elevation