

Saint James Church of England Primary School, West End, Southampton
Expansion to 3FE
Proposed Site & Building Plans

Proposed Site Plan:

1. Existing Primary School
2. Existing Temporary Classrooms
3. Existing Staff Car Parking
4. Proposed Extended Staff Car Park
5. Existing Hard Court Play
6. Existing Hard Games Area
7. Proposed All Weather Pitch
8. Habitat Area
9. Proposed Classroom Wing
10. Proposed Hall Extension
11. Toilet & Circulation refurbishment
12. Year R Classroom Refurbishment
13. Proposed Link Canopy
14. Proposed Bike/Scooter Storage
15. Existing External Stores
16. Proposed Pedestrian Footpath
17. Existing Ponds
18. Proposed Additional Playground
19. Proposed Bin Storage
20. Staff Room Refurbishment

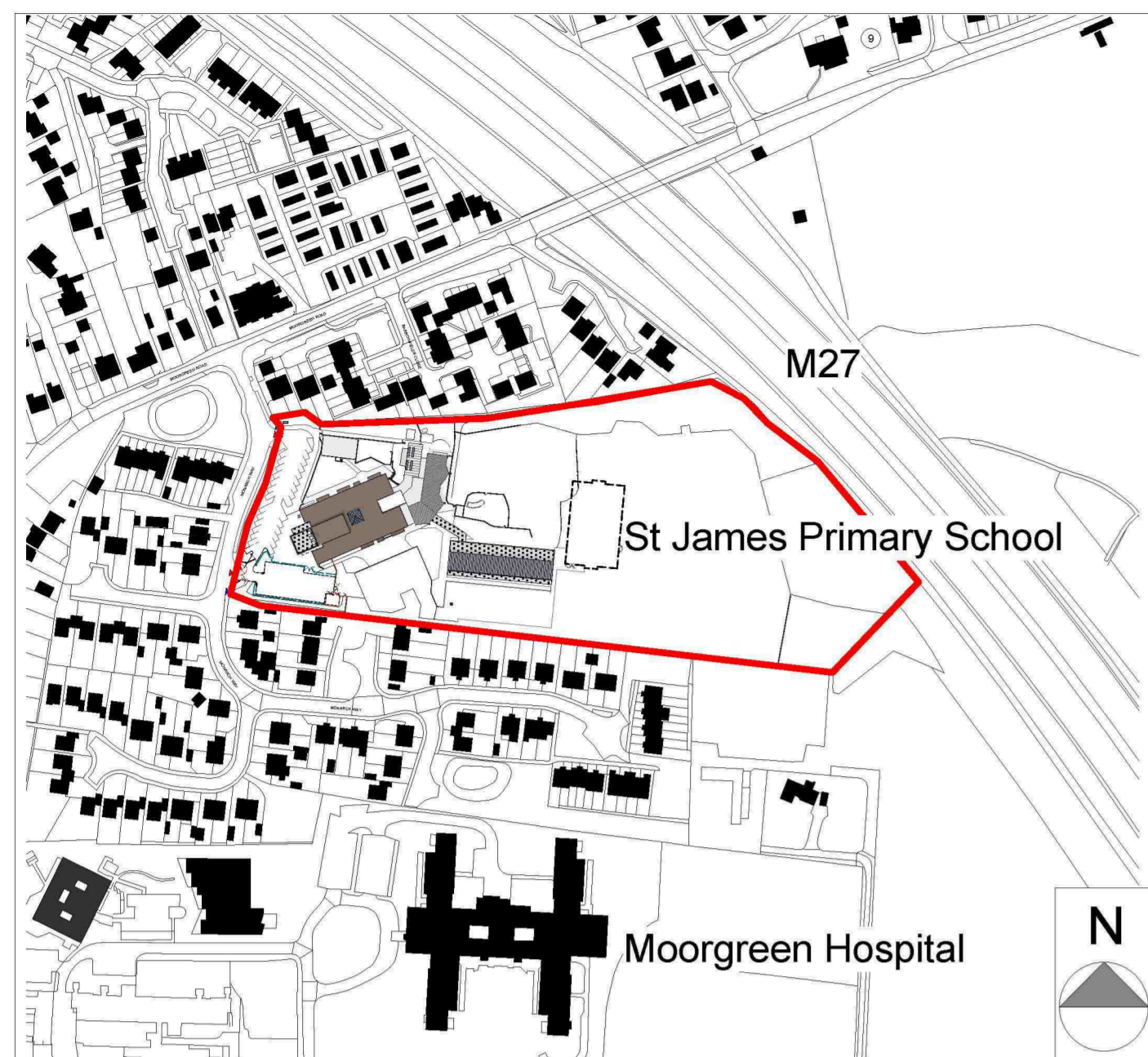

01 Existing Site Location Plan



02 Aerial View Looking North

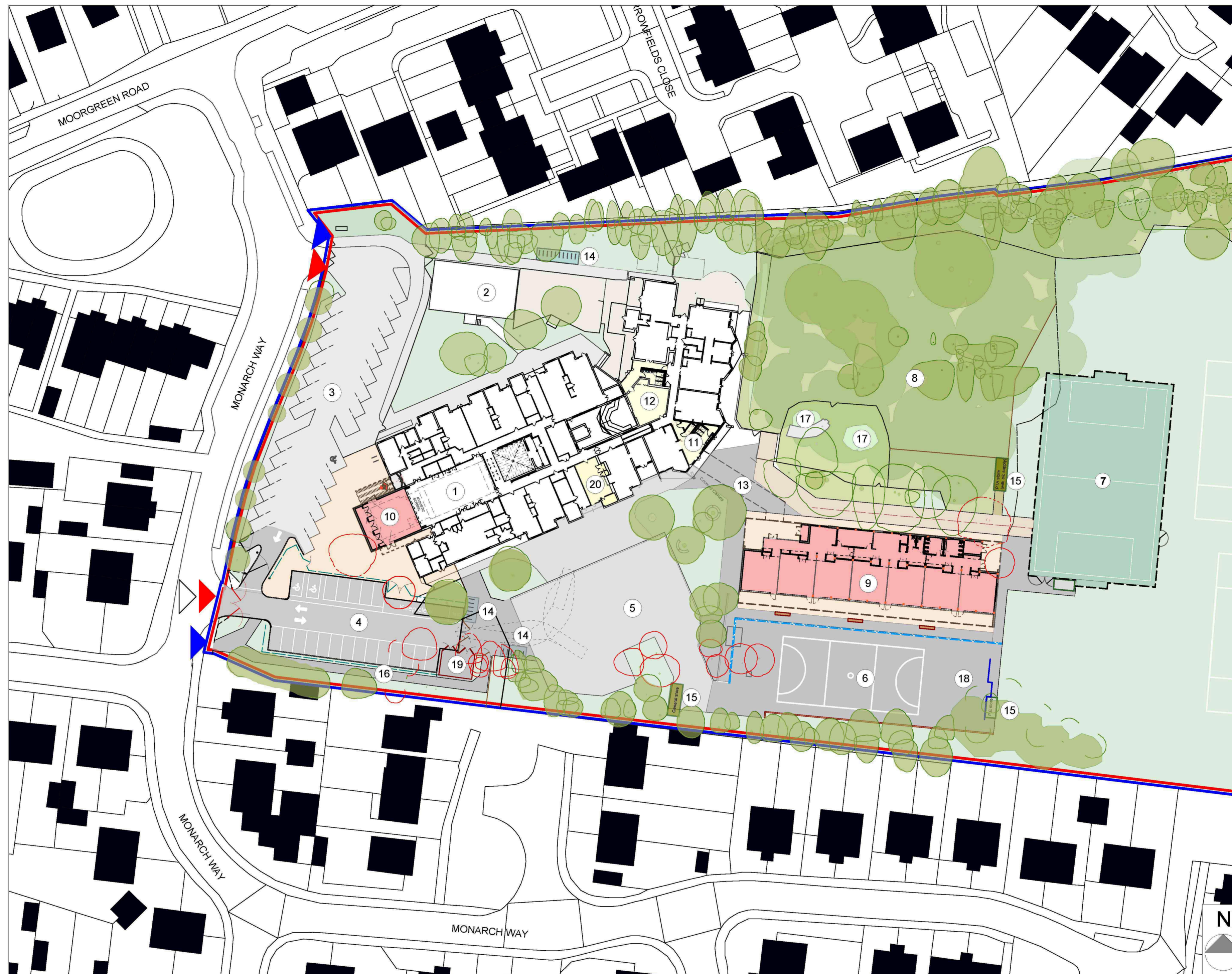

03 Proposed Site Plan



04 Proposed South Elevation

- Site Boundary
- ▶ Pedestrian Access
- ▶ Vehicular Access
- Contractors Access

Project Appraisal

P09161 - A.100_Rev A

Not to Scale
 April 2016