

HAMPSHIRE COUNTY COUNCIL

Decision Report

Decision Maker:	Executive Member for Economy, Transport and Environment
Date:	9 September 2014
Title:	Project Appraisal Update - A27 Station Roundabout and Gudge Heath Lane Junctions, Fareham
Reference:	Tbc
Report From:	Director of Economy, Transport and Environment

Contact name: Heather Walmsley

Tel: 01962 846089

Email: heather.walmsley@hants.gov.uk

APPENDICES

Appendix	Drawing Reference
APPENDIX 1 Gudge Heath Lane Junction Preferred Scheme General Arrangement	EC/CJ008212/002 Rev A
APPENDIX 2 General Arrangement – Bishopsfield Road to Romyns Court	EC/CJ008212/001
APPENDIX 3 A27 Gudge Heath Lane Junction Improvement – Land Plan Overview	EC/CJ008212/068 Rev C
APPENDIX 4 A27 Gudge Heath Lane Junction Improvement – 16 The Avenue Land Requirements	EC/CJ008212/066 Rev C
APPENDIX 5 A27 Gudge Heath Lane Junction Improvement – 18 The Avenue - Land Requirements	EC/CJ008212/065 Rev C
APPENDIX 6 A27 Gudge Heath Lane Junction Improvement – 20 The Avenue - Land Requirements	EC/CJ008212/064 Rev C
APPENDIX 7 A27 Gudge Heath Lane Junction Improvement – Travelrest 22 The Avenue - Land Requirements	EC/CJ008212/063 Rev C
APPENDIX 8 A27 Gudge Heath Lane Junction Improvement – 24 The Avenue -Land Requirements	EC/CJ008212/062 Rev C
APPENDIX 9 General Arrangement – A27 / Station Roundabout	EC/CJ008212/003
Appendix 10 A27 / Station Roundabout – Land Plan	EC/CJ008212/070 Rev A
APPENDIX 11 – General Arrangement – West Street	EC/CJ008212/004



NOTES

- 1. DO NOT SCALE FROM THIS DRAWING
- 2. ALL DIMENSIONS IN METRES UNLESS OTHERWISE STATED
- 3. ACCOMODATION WORKS TO BE AGREED WITH LANDOWNERS

KEY

- AREA REQUIRED FOR DEDICATION (99.2m²)
- AREA REQUIRED FOR LICENCE (58.3m²)
- LAND BOUNDARY

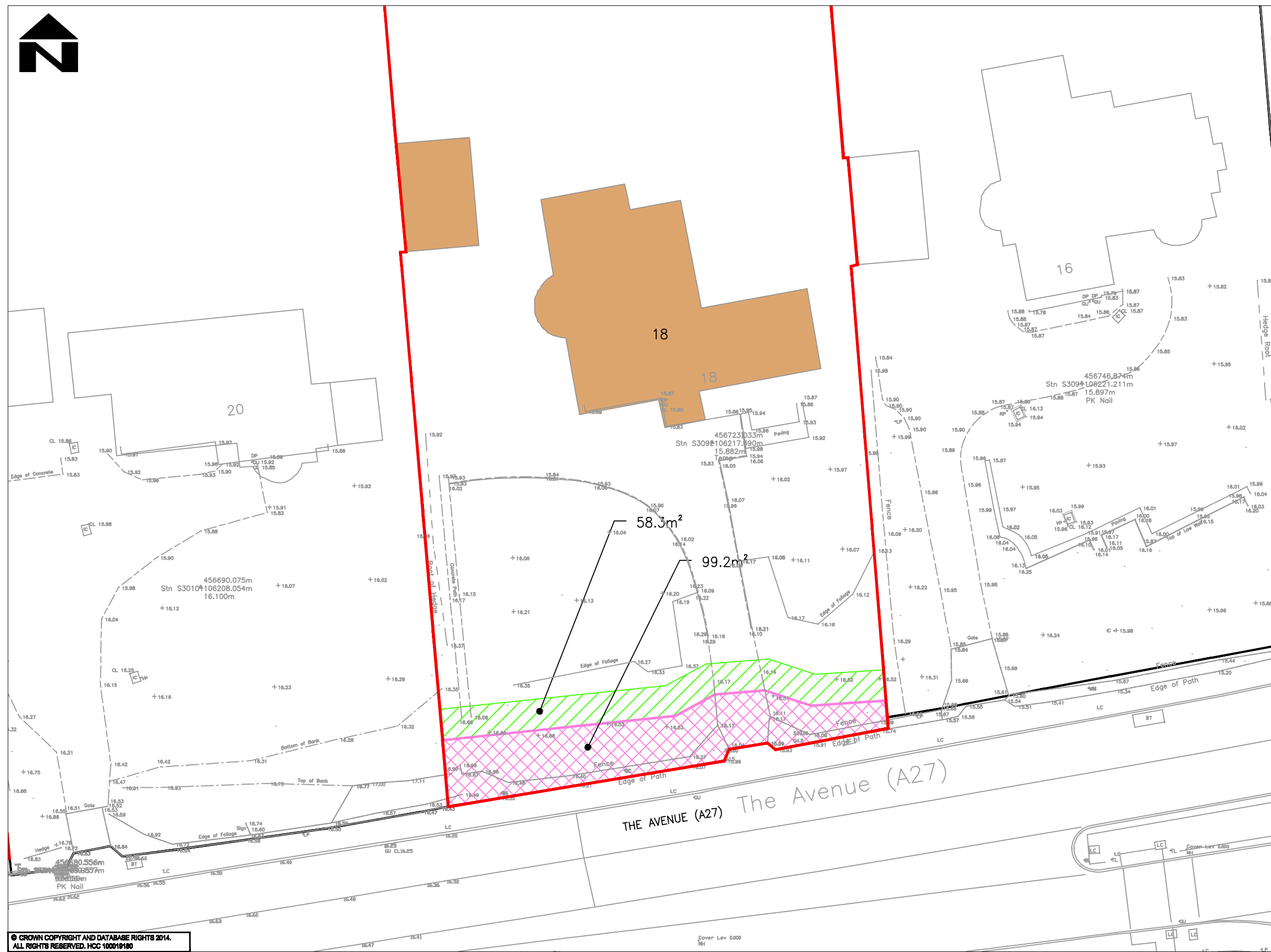

© CROWN COPYRIGHT AND DATABASE RIGHTS 2014.
ALL RIGHTS RESERVED. HCC 100019100

C	HATCH PATTERN AMENDED	18.08.2014	SCL	MC	AT
B	TOPO SURVEY AMENDED	07.08.2014	RB	MC	AT
A	TOPO SURVEY ADDED & MINOR AMENDMENTS	06.08.2014	SCL	MC	AT

CLIENT
HAMPSHIRE COUNTY COUNCIL
ECONOMY, TRANSPORT AND ENVIRONMENT DEPARTMENT
STRATEGIC TRANSPORT

CONSULTANT
Hampshire Engineering
County Council CONSULTANCY
STUART JARVIS BSc DipTP FCIHT MRTPI: DIRECTOR OF ECONOMY, TRANSPORT & ENVIRONMENT

DESIGNER
MC
CAD
SCL
CHECKED
MC | MC
APPROVED
IH | IH

SCHEME
A27 STATION ROUNDABOUT & GUDGE HEATH LANE JUNCTION IMPROVEMENTS
JOB No. C:J008212.01
SCALE @ A3
1:250

DATE
MAY 14

SHEET NUMBER
4 OF 5

DRAWING TITLE
**LAND PLAN
NUMBER 18, THE AVENUE**

HCC CAD PLOT: 18/08/2014 10:27:28
DRAWING NUMBER
EC/J008212/065

REV
C



NOTES

- 1. DO NOT SCALE FROM THIS DRAWING
- 2. ALL DIMENSIONS IN METRES UNLESS OTHERWISE STATED
- 3. ACCOMMODATION WORKS TO BE AGREED WITH LANDOWNERS

KEY

- AREA REQUIRED FOR DEDICATION (150m²)
- AREA REQUIRED FOR LICENCE (58.3m²)
- LAND BOUNDARY

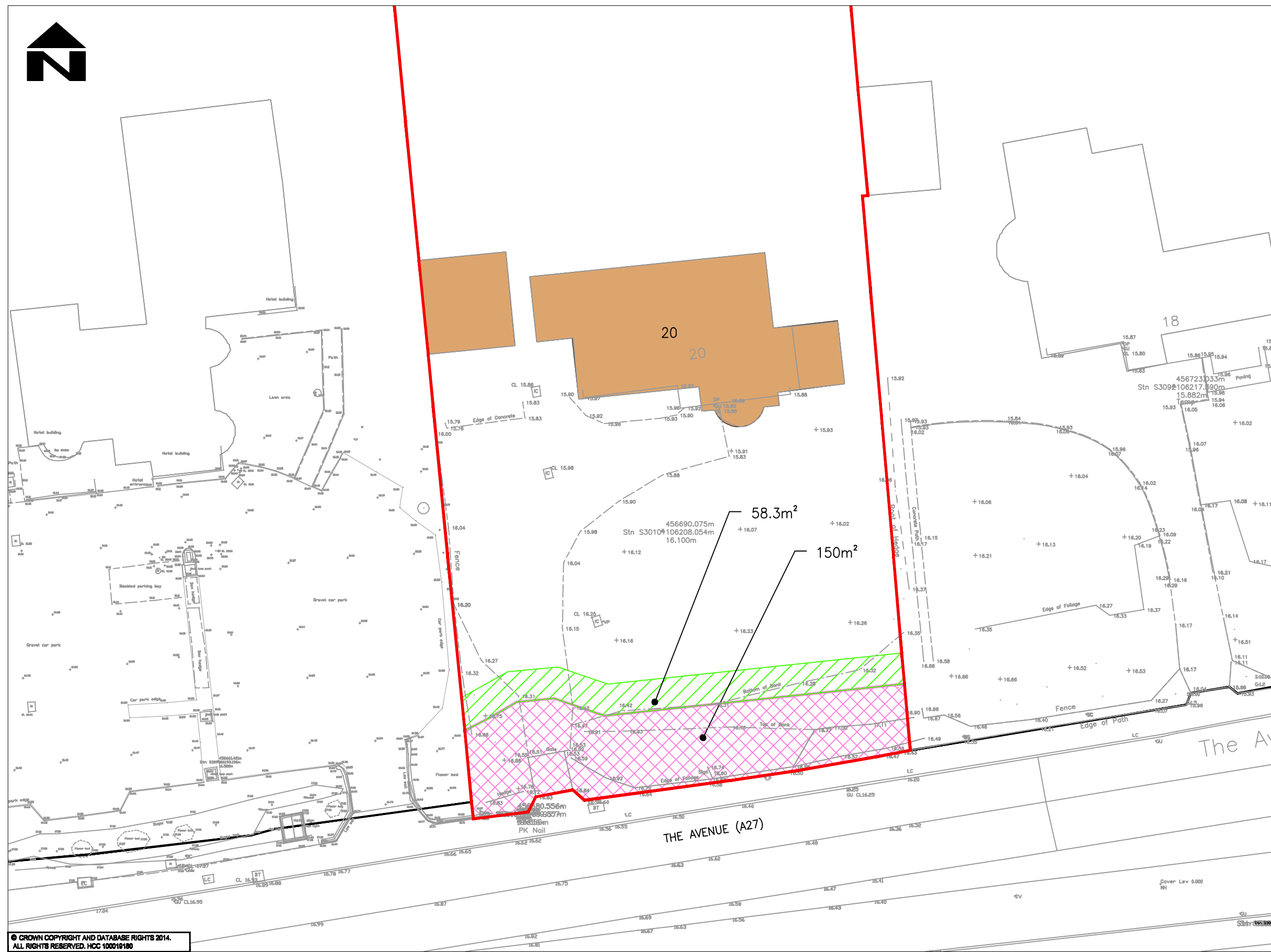

© CROWN COPYRIGHT AND DATABASE RIGHTS 2014.
ALL RIGHTS RESERVED. HCC 100018180

REV	DESCRIPTION	DATE	BY	CHECKED	APPD
C	HATCH PATTERN AMENDED	18.08.2014	SCL	MC	AT
B	TOPO SURVEY AMENDED	07.08.2014	RB	MC	AT
A	TOPO SURVEY ADDED & MINOR AMENDMENTS	06.08.2014	SCL	MC	AT

CLIENT
HAMPSHIRE COUNTY COUNCIL
ECONOMY, TRANSPORT AND ENVIRONMENT DEPARTMENT
STRATEGIC TRANSPORT

CONSULTANT
Hampshire Engineering
County Council CONSULTANCY
STUART JARVIS BSc DipTP FCIBT MRTP: DIRECTOR OF ECONOMY, TRANSPORT & ENVIRONMENT

DESIGNER
MC
CAD
SCL
CHECKED
MC | MC
APPROVED
IH | IH

SCHEME
A27 STATION ROUNDABOUT & GUDGE HEATH LANE JUNCTION IMPROVEMENTS
JOB No. C:J008212.01
SCALE @ A3
DATE
MAY 14
SHEET NUMBER
3 OF 5



DRAWING TITLE
LAND PLAN NUMBER 20, THE AVENUE
HCC CAD PLOT: 18/08/2014 10:28:28
DRAWING NUMBER
EC/C:J008212/064
REV
C



NOTES

1. DO NOT SCALE FROM THIS DRAWING
2. ALL DIMENSIONS IN METRES UNLESS OTHERWISE STATED
3. ACCOMMODATION WORKS TO BE AGREED WITH LANDOWNERS

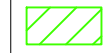
KEY

-  AREA REQUIRED FOR DEDICATION (164.6m²)
-  AREA REQUIRED FOR LICENCE (231.7m²)
-  LAND BOUNDARY



© CROWN COPYRIGHT AND DATABASE RIGHTS 2014.
 ALL RIGHTS RESERVED. HCC 100018180



<p>CLIENT</p> <p>HAMPSHIRE COUNTY COUNCIL ECONOMY, TRANSPORT AND ENVIRONMENT DEPARTMENT STRATEGIC TRANSPORT</p>				<p>CONSULTANT</p> <p>Hampshire Engineering County Council CONSULTANCY</p> <p>STUART JARVIS BSc DipTP FCILT MRTP: DIRECTOR OF ECONOMY, TRANSPORT & ENVIRONMENT</p>				<p>DESIGNER MC</p> <p>CAD SCL</p> <p>CHECKED MC MC</p> <p>APPROVED IH IH</p>				<p>SCHEME A27 STATION ROUNDABOUT & GUDGE HEATH LANE JUNCTION IMPROVEMENTS</p> <p>JOB No. C-J008212.01</p> <p>SCALE @ A3 1:250</p> <p>DATE MAY 14</p> <p>SHEET NUMBER 2 OF 5</p>				<p>DRAWING TITLE LAND PLAN NUMBER 22, THE AVENUE</p> <p>HCC CAD PLOT: 18/05/2014 10:28:38</p> <p>DRAWING NUMBER EC/C-J008212/063</p> <p>REV C</p>																	
<table border="1"> <tr> <td>C</td> <td>HATCH PATTERN AMENDED</td> <td>18.08.2014</td> <td>SCL</td> <td>MC</td> <td>AT</td> </tr> <tr> <td>B</td> <td>TOPO SURVEY AMENDED</td> <td>07.06.2014</td> <td>RB</td> <td>MC</td> <td>AT</td> </tr> <tr> <td>A</td> <td>TOPO SURVEY ADDED & MINOR AMENDMENTS</td> <td>06.08.2014</td> <td>SCL</td> <td>MC</td> <td>AT</td> </tr> </table>				C	HATCH PATTERN AMENDED	18.08.2014	SCL	MC	AT	B	TOPO SURVEY AMENDED	07.06.2014	RB	MC	AT	A	TOPO SURVEY ADDED & MINOR AMENDMENTS	06.08.2014	SCL	MC	AT												
C	HATCH PATTERN AMENDED	18.08.2014	SCL	MC	AT																												
B	TOPO SURVEY AMENDED	07.06.2014	RB	MC	AT																												
A	TOPO SURVEY ADDED & MINOR AMENDMENTS	06.08.2014	SCL	MC	AT																												



NOTES

- 1. DO NOT SCALE FROM THIS DRAWING
- 2. ALL DIMENSIONS IN METRES UNLESS OTHERWISE STATED
- 3. ACCOMODATION WORKS TO BE AGREED WITH LANDOWNERS

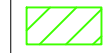
KEY

-  AREA REQUIRED FOR DEDICATION (47.7m²)
-  AREA REQUIRED FOR LICENCE (42.1m²)
-  LAND BOUNDARY



© CROWN COPYRIGHT AND DATABASE RIGHTS 2014.
ALL RIGHTS RESERVED. HCC 100016180

REV	DESCRIPTION	DATE	BY	CHECKED	APPD
C	HATCH PATTERN AMENDED	18.08.2014	SCL	MC	AT
B	TOPO SURVEY AMENDED	07.08.2014	RB	MC	AT
A	TOPO SURVEY ADDED & MINOR AMENDMENTS	06.08.2014	SCL	MC	AT

CLIENT

HAMPSHIRE COUNTY COUNCIL
ECONOMY, TRANSPORT AND ENVIRONMENT DEPARTMENT
STRATEGIC TRANSPORT

CONSULTANT

Hampshire Engineering
County Council CONSULTANCY

STUART JARVIS BSc DipTP FCIBT MRTP: DIRECTOR OF ECONOMY, TRANSPORT & ENVIRONMENT

DESIGNER
MC

CAD
SCL

CHECKED
MC | MC

APPROVED
IH | IH

SCHEME
A27 STATION ROUNDABOUT & GUDGE HEATH LANE JUNCTION IMPROVEMENTS

JOB No. C-1007548.01

SCALE @ A3
1:250

DATE
MAY 14

SHEET NUMBER
1 OF 5

DRAWING TITLE

LAND PLAN
NUMBER 24, THE AVENUE

DRAWING NUMBER
EC/CJ008212/062

REV
C