

**Appendix A**

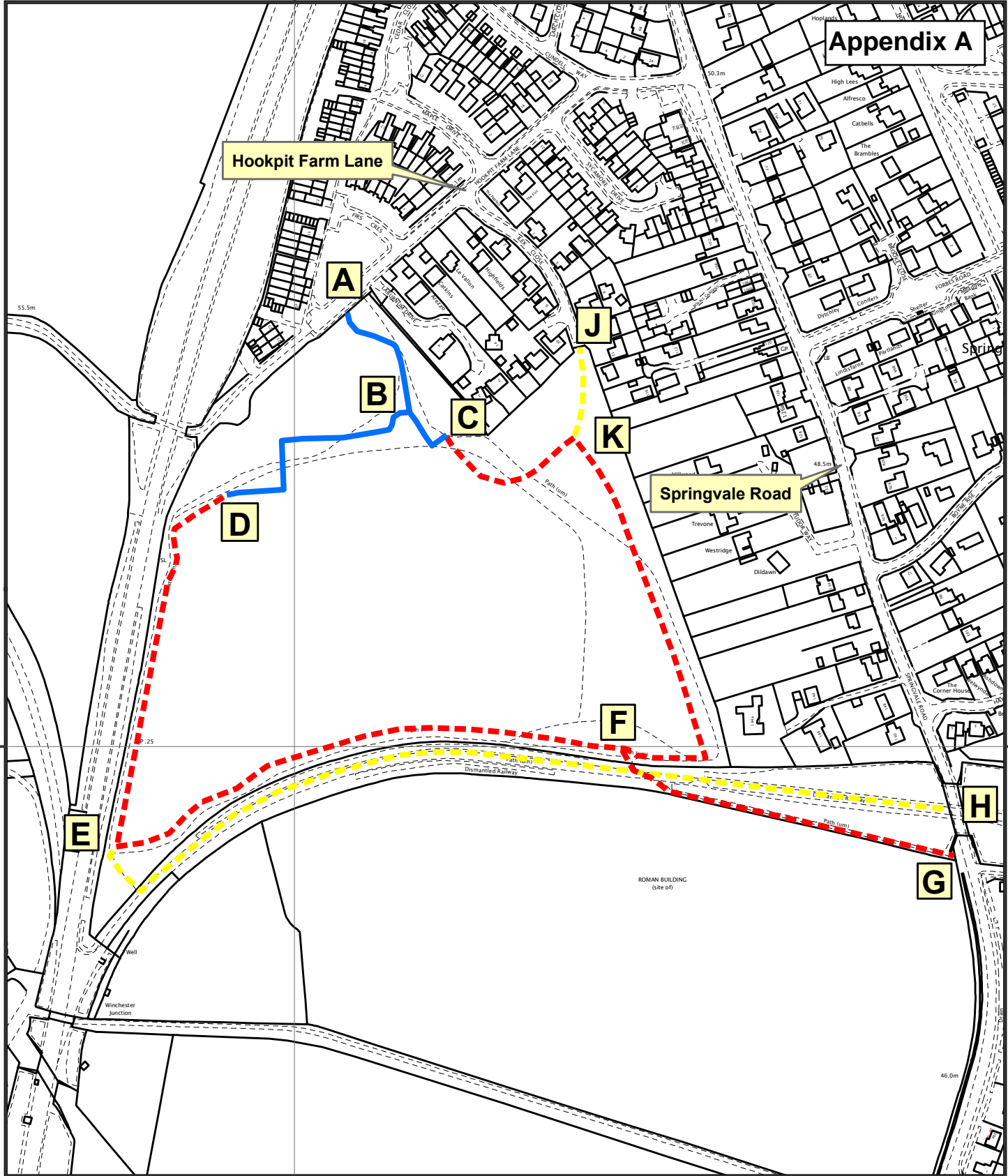

**Hampshire**  
County Council

**PARISH OF KINGS WORTHY**

**PROPOSAL TO DEDICATE PUBLIC RIGHTS OF WAY**

- - - - - **FOOTPATHS TO BE DEDICATED**
- **ROUTE OF FOOTPATHS ALREADY DIVERTED UNDER TCPA 1990**
- - - - - **FOOTPATHS TO BE OFFERED ON A PERMISSIVE BASIS**

**DRAWN** HG  
**DATE** 17.02.14  
**SCALE** 1:3,500

Countryside Access Team  
Culture, Communities & Business Services  
Castle Avenue  
Winchester  
Hampshire  
SO23 8UL

Reproduced from the the O.S. mapping with the permission of the Controller of HMSO © Crown. Unauthorised reproduction infringes © Crown and may lead to prosecution or civil proceedings  
HCC Licence No. 100019180 2014