

- Key:**
- General Teaching - New Build
 - General Teaching - Refurb.
 - Non-Teaching - New Build
 - Non-Teaching - Refurb.
 - Circulation
 - ▶ Vehicle Access
 - ▶ Pedestrian Access
 - Site Boundary
 - Development Boundary (Including contractor's compound)

- Plans**
- 1 Existing Children's Centre
 - 2 Existing Main Hall
 - 3 Existing Class Rooms
 - 4 Existing Plant Room
 - 5 Existing Admin Offices
 - 6 Existing Kitchen
 - 7 Existing Studio Space
 - 8 Proposed Classrooms
 - 9 Proposed WCs
 - 10 Proposed Staff/Group Room
 - 11 Proposed Plant Equipment
 - 12 Refurb Storage Space
 - 13 Existing Temporary Classrooms
 - 14 Proposed Temporary Classrooms
 - 15 External Soft Play
 - 16 External Hard Play
 - 17 Car Park

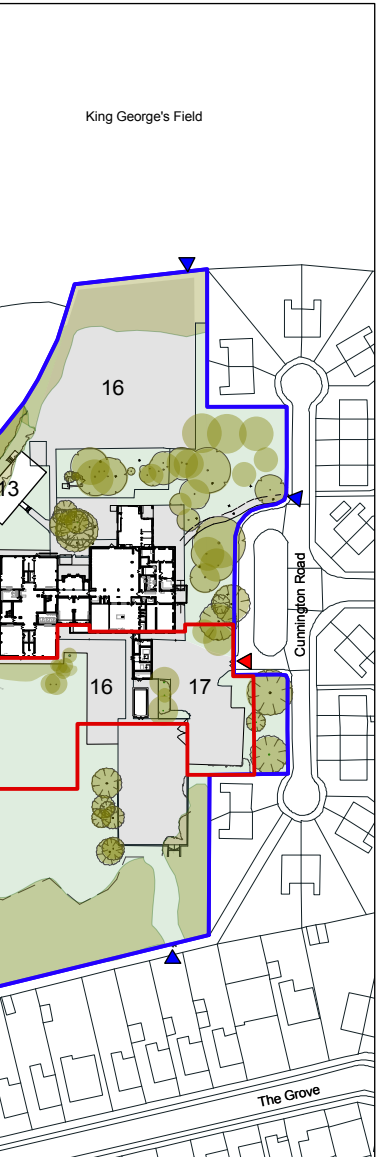
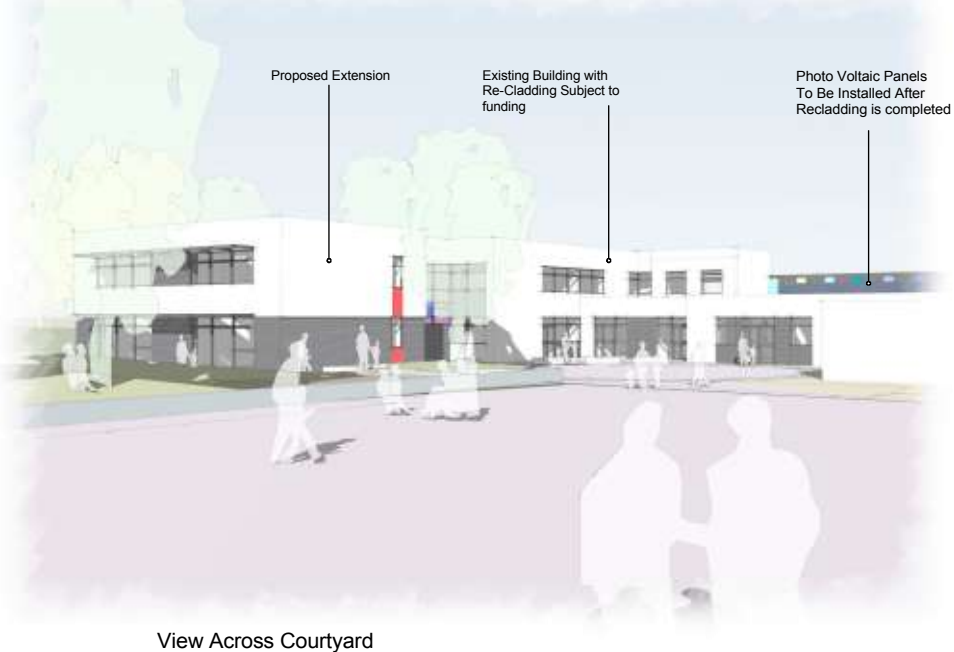

Hampshire County Council
 HCC Property Services,
 Three Minsters House,
 76 High Street, Winchester SO23 8UL.
 tel: (01962) 847801

Notes

- 1 This drawing is © copyright Hampshire County Council 2012. No unauthorised reproduction permitted. All rights reserved.
- 2 No dimensions are to be scaled from this drawing
- 3 This map is reproduced from Ordnance Survey material with the permission of Ordnance Survey on behalf of the controller of Her Majesty's Stationery Office © Crown Copyright. Unauthorised reproduction infringes Crown Copyright and may lead to prosecution or civil proceedings. (100019180), (2012)

rev	description	date	by

PROJECT
Hampshire County Council
South Farnborough Jnr
1 FE Expansion

SCALE	DATE	DRAWN.	CHKD.
Not to Scale	Feb 2014	arcnci	CH

SHEET CONTENTS
Project Appraisal Drawing

HCC
Property Services

DRAWING No.	P09900 - A220	REVISION
FILE REF.		