

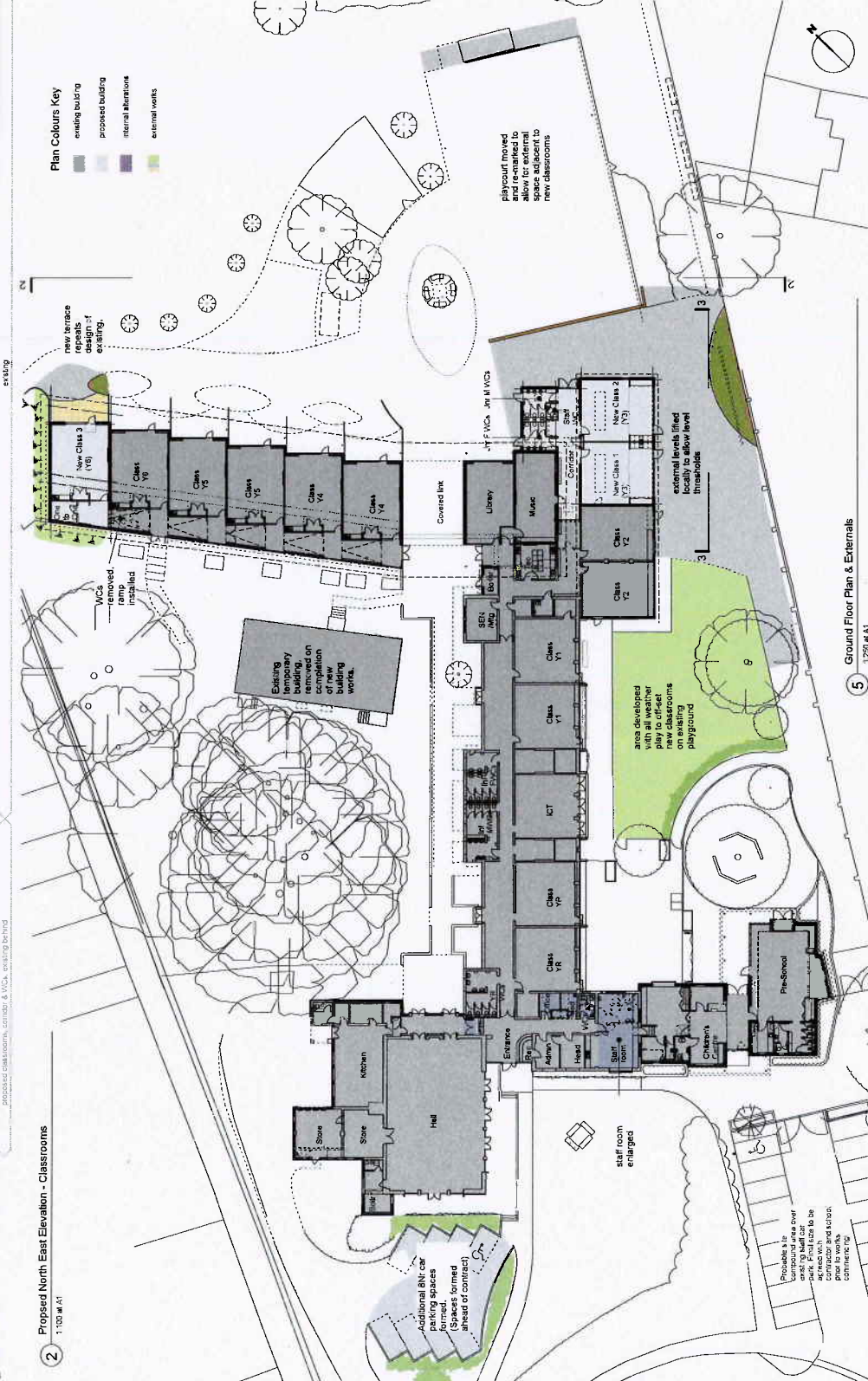

2 Proposed North East Elevation - Classrooms  
1:100 @ A1

Plan Colours Key  
 existing building  
 proposed building  
 internal alterations  
 external works



5 Ground Floor Plan & Externals  
1:250 @ A1



3 Proposed South East Elevation - Proposed & Existing Classrooms  
1:100 @ A1

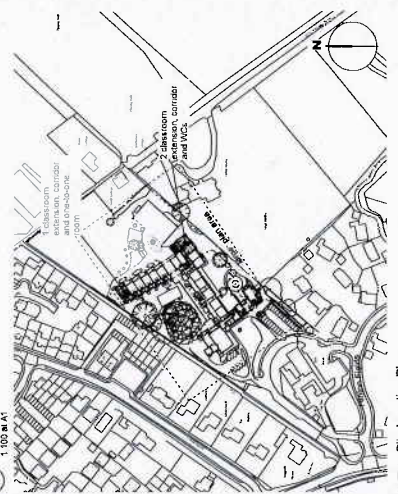

4 Site Location Plan  
1:2000 @ A1

Notes	Rev	Description	Date	By
1 This drawing is copyright Hampshire County Council & its officers. No part of this drawing or any kind of part thereof may be reproduced, stored in a retrieval system or transmitted in any form or by any means, electronic, mechanical, photocopying, recording, or by any information storage and retrieval system, without the prior written permission of Hampshire County Council.				
2 No dimensions to be taken from this drawing.				
3 This drawing is reproduced from the Council's website. It is not to be used for any other purpose without the prior written permission of Hampshire County Council. For more information, please contact the Planning Department, Hampshire County Council, 1000 High Street, Southampton, Hampshire, SO9 4LN, UK. Tel: 023 8023 1000.				

Hampshire County Council  
 Kings Worthy Primary School  
 Church Lane, Kings Worthy, SO23 7QS

PROJECT SHEET 00000775  
 0.5FE Extension - 3 Class Extension - Proposed Plans & Elevations

DATE: 13.03.13  
 DRAWN: SCM  
 CHECKED: CHW  
 PROJECT NO: P09762-05

HCC Property Services, Three Malpas House, West SO23 1UL  
 Tel: 01703 217201