

Deposit Of Statement And Plan
Section 31(6), Highways Act 1980

To Hampshire County Council:

1. We are and have been since 9th November 1976 the owners within the meaning of the above section of the land known as Ashley Glebe Farm more particularly delineated on the plan accompanying this statement and thereon edged red.
2. The aforementioned land lies in the Parishes of Ashley and Kings Somborne.
3. The ways coloured brown on the said plan have been dedicated as highways with vehicular status.
4. The ways coloured purple on the said plan have been dedicated as footpaths.
5. No other ways over the land have been dedicated as highways.
6. The deposit shall comprise this statement and accompanying plan.

Signed (landowners)

Names (landowners)

Alan J Browning

C T Browning

Address'

36 Allbrook Hill
EASTLEIGH
Hants. S050 4LY

44 Beechwood Crescent
Chandlers Ford
EASTLEIGH
Hants. S053 5PD

Date 10.2.00

Signed (witness)

Name (witness)

Peter W. Treloar.

Address

*8. Tamar Down, Riverdale, Waterlooville
P: 7 805.*

Occupation

Consultant

COUNTRYSIDE SERVICE	
15 FEB 2000	
Passed to	
Copies to	
Ack./Reply	

recd 16/12/2010



**Deposit Of Statement And Plan
Section 31(6), Highways Act 1980**

To Hampshire County Council:

Plan submitted on 10th February 2000 file ref 101.

1. I am and have been since 9th November 1976 a co-owner within the meaning of the above section of the land known as Ashley Glebe Farm more particularly delineated on the plan accompanying this statement and thereon edged red.
2. The aforementioned land lies in the Parishes of Ashley and King's Somborne.
3. The ways coloured brown on the said plan have been dedicated as highways for all purposes.
4. The ways coloured purple on the said plan have been dedicated as footpaths.
5. No other ways over the land have been dedicated as highways.
6. The deposit shall comprise this statement and accompanying plan.

Signed (*landowner*) 

Name (*landowner*) A.J.Browning

Address Ashley Glebe Farm, King's Somborne, Stockbridge, Hants. SO20 6RJ

Date 14/12/2010.

Signed (*witness*) 

Name (*witness*) Ralph Lancaster

Address Twin Oaks, 49 Ladywood, Boyatt Wood, Eastleigh SO50 4RW

Occupation Sales & Marketing assistant

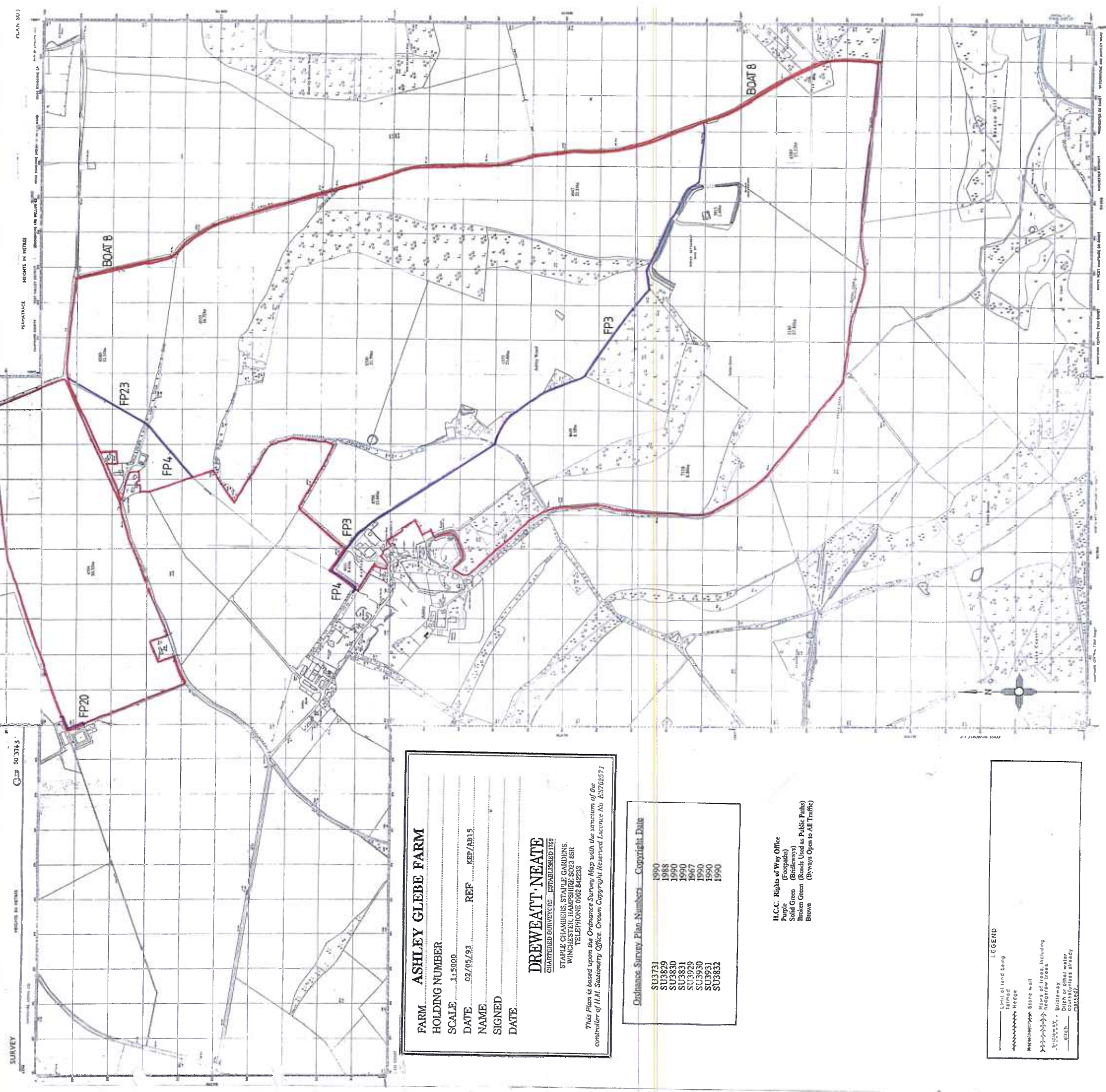

FARM ASHLEY GLEBE FARM
HOLDING NUMBER
SCALE 1:15000
DATE 02/05/93 **REF** KEE/AB15
NAME
SIGNED
DATE

DREWETT NEATE
 CHARTERED SURVEYORS ESTABLISHED 1823
 STAPLE CHAMBERS STABLE YARDS
 WINCHESTER, HAMPSHIRE SO23 8SR
 TELEPHONE 0952 84223

This Plan is based upon the Ordnance Survey Map with the sanction of the controller of H.M. Stationery Office. Crown Copyright Reserved Licence No. E5706571

Ordnance Survey Plan Numbers - Copyright Date

SU3731	1990
SU3829	1988
SU3830	1990
SU3831	1990
SU3929	1967
SU3930	1990
SU3931	1990
SU3832	1990

H.C.C. Rights of Way Office
 Purple (Footpaths)
 Solid Green (Bridleways)
 Broken Green (Roads Used as Public Paths)
 Brown (Byways Open to All Traffic)

LEGEND

- Lines of land being
- Farms
- Hedges
- Stone wall
- Rows of trees, including
- hedgerow trees
- Bridleway
- Ditch or other water
- (crossed)