

Wildlife and Countryside Act 1981

The Hampshire Wildlife and Countryside Act 1981 Section 57(3) Definitive Map and Statement (Dated 1st January 2008)

To: **The Director of Culture, Communities and Business Services**
of: **Hampshire County Council**
Castle Avenue
Winchester
Hampshire
SO23 8UL

I/We [name of applicant(s)]: Ian Bowman / Parish Council of Heckfield

of [address of applicant(s)]: Highfield Lodge, Church Lane, Heckfield, HOOK

.....
hereby apply for an Order under Section 53(2) of the Wildlife and Countryside Act 1981
modifying the definitive Map and statement for the area by:- *[delete where appropriate]*

• **deleting** the footpath / bridleway / restricted byway / byway open to all traffic
from

or

• **adding** the footpath / bridleway / ~~restricted byway / byway open to all traffic~~
from B3349 @ 51.344047, -0.96007 (aprox)
to Laundry Lane @ 51.342868, -0.953559 (aprox)

or

• **upgrading/downgrading**
to a footpath / bridleway / restricted byway / byway open to all traffic
the footpath / bridleway / restricted byway / byway open to all traffic
from

or

• **varying/adding** to the particulars relating to the footpath /
bridleway / restricted byway / byway open to all traffic
from

and shown on the map accompanying this application

(NB The map which you submit should be drawn to a scale of at least 1:25,000)

I/We attach copies of the following documentary evidence (including statements of witnesses) in support of this application:

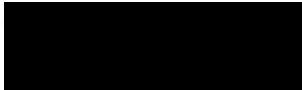
LIST OF DOCUMENTS	
Hampshire Definitive Map Extract	With highlighting of Path that should be registered as a Public Footpath – note that this Path shows a branch to enable the path to run to the Heckfield bus stop.
OS 1958	SU76 (Includes Reading)
OS 1911	Hampshire & Isle of Wight XI.3 (includes Heckfield; Mattingley.)
OS 1911	Hampshire & Isle of Wight XI.4 (includes Heckfield; Mattingley.)
OS 1897	Hampshire & Isle of Wight XI.NE (includes Heckfield; Mattingley.)
Francis Frith Collection	Heckfield 1894-1909
Cover Letter	Cover letter sent with notice to landowner
Community statement  Simon Richards Parish Councillor - Heckfield Mulberry House, Church Lane, Heckfield, Hook	The footpath shown highlighted was in frequent use to traverse across to Laundry Lane from the B3349 and to walk to the community bus stop. Walkers and horse riders used the path frequently until it was enclosed with a new fence (circa 2018).

The personal data you provide on this form will be treated in accordance with Data Protection Legislation. It will be used to process the application to modify the definitive map of public rights of way, and to carry out consultation and investigation including contacting you about your evidence. The legal basis for our use of this information is the compliance with a legal obligation – Wildlife and Countryside Act 1981.

We may share your personal information with owners or occupiers (or their representatives), objectors, other Council departments or local authorities and other interested parties. It may also be made public if the matter is referred to the Planning Inspectorate. It will become part of the permanent records kept on rights of way in Hampshire.

You have some legal rights in respect of the personal information we collect from you. Please see our website Data Protection page for further details: www.hants.gov.uk/dataprotection. You can contact the County Council's Data Protection Officer at data.protection@hants.gov.uk. If you have a concern about the way we are collecting or using your personal data, you should raise your concern with us in the first instance or directly to the Information Commissioner's Office at <https://ico.org.uk/concerns>.

Signed



..... Date 18th July 2020

Signed Ian Bowman - Parish Councillor - Heckfield

Wildlife and Countryside Act 1981

**The Hampshire Wildlife and Countryside Act 1981
Section 57(3) Definitive Map and Statement
(Dated 1st January 2008)**

Certificate of Service of Notice of Application for Modification Order

To: **The Director of Culture, Communities and Business Services,
Countryside Access Team, Hampshire County Council, Castle Avenue,
Winchester, Hampshire, SO23 8UL**

I/We [name of applicant(s)] Ian Bowman (On behalf of Heckfield Parish Council)

of [address of applicant(s)] Highfield Lodge
Church Lane
Heckfield
HOOK

hereby certify that the requirements of paragraph 2 of Schedule 14 to the Wildlife and Countryside Act 1981 have been complied with.

Signed

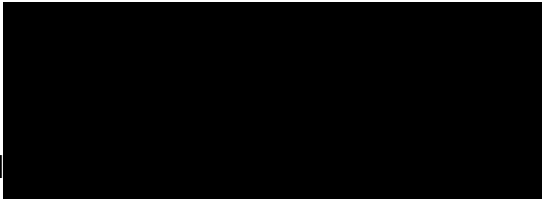

Date 18th July 2020

Notice of the application should be served on the owners and occupiers of all the land affected by the application. Please note here the names and addresses of all people given notice of the application:

Mrs V Perrins
Coldpiece Farm
Hound Green
HOOK
RG278LG

The personal data you provide on this form will be treated in accordance with Data Protection Legislation. Your application will be published on our website and be available for inspection in accordance with the Public Rights of Way (Register of Applications under Section 53(5) of the Wildlife and Countryside Act 1981) (England) Regulations 2005. We will remove signatures on the online version.

The information you enter on this form will be used to carry out consultation and investigation including contacting witnesses about their evidence. The legal basis for our use of this information is the compliance with a legal obligation – Wildlife and Countryside Act 1981.

We may share your personal information with owners or occupiers (or their representatives), objectors, other Council departments or local authorities and other interested parties. It may also be made public if the matter is referred to the Planning Inspectorate. It will become part of the permanent records kept on rights of way in Hampshire.

*You have some legal rights in respect of the personal information we collect from you. Please see our website Data Protection page for further details: www.hants.gov.uk/dataprotection
You can contact the County Council's Data Protection Officer at data.protection@hants.gov.uk. If you have a concern about the way we are collecting or using your personal data, you should raise your concern with us in the first instance or directly to the Information Commissioner's Office at <https://ico.org.uk/concerns/>*

Wildlife and Countryside Act 1981

Schedule 14: Applications for certain orders under Part III

Form of applications





1. An application shall be made in the prescribed form and shall be accompanied by:
 - (a) a map drawn to the prescribed scale and showing the way or ways to which the application relates; and
 - (b) copies of any documentary evidence (including statements of witnesses) which the applicant wishes to adduce in support of the application

Notice of Applications

2. (1) Subject to sub-paragraph (2), the applicant shall serve a notice stating that the application has been made on every owner and occupier of any land to which the application relates.
 - (2) If, after reasonable inquiry has been made, the authority is satisfied that it is not practicable to ascertain the name or address of an owner or occupier of any land to which the application relates, the authority may direct that the notice required to be served on him by sub-paragraph (1) may be served by addressing it to him by the description 'owner' or 'occupier' of the land (describing it) and by affixing it to some conspicuous object or objects on the land.
 - (3) When the requirements of this paragraph have been complied with, the applicant shall certify that fact to the authority.
 - (4) Every notice or certificate under this paragraph shall be in the prescribed form.

DMMO 1364
Add bridleway from B3349 to Laundry Lane
and add bridleway from claimed route to the Causeway

 **Hampshire**
 County Council
RIGHTS OF WAY OFFICE

- Footpath 
- Bridleway 
- Restricted Byway 
- Byway Open to All Traffic 
- Route subject to application 

One or more of these line notations will appear on the map

1:3,000

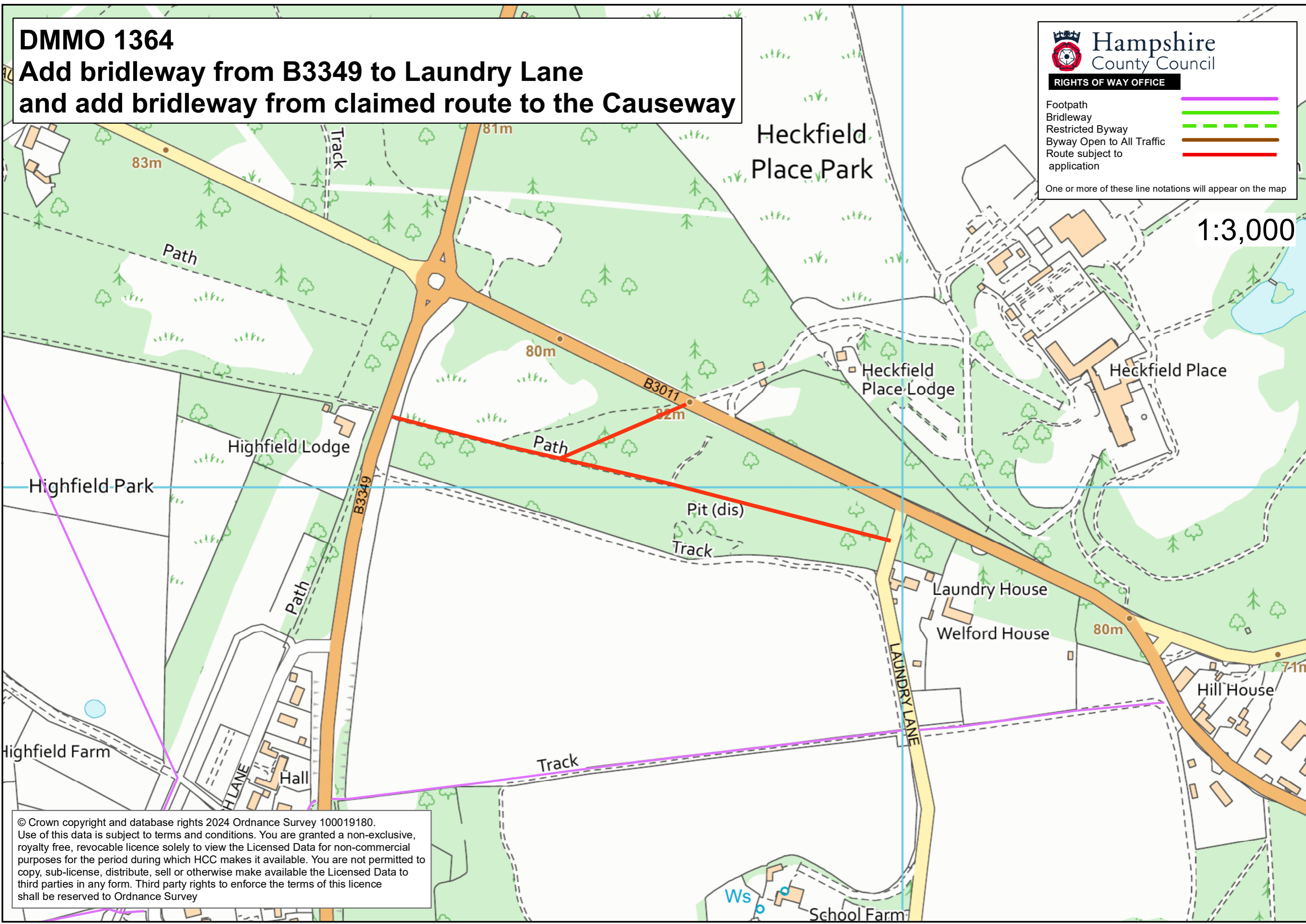

© Crown copyright and database rights 2024 Ordnance Survey 100019180.
 Use of this data is subject to terms and conditions. You are granted a non-exclusive, royalty free, revocable licence solely to view the Licensed Data for non-commercial purposes for the period during which HCC makes it available. You are not permitted to copy, sub-license, distribute, sell or otherwise make available the Licensed Data to third parties in any form. Third party rights to enforce the terms of this licence shall be reserved to Ordnance Survey