

Form CA16

Application Form for deposits under section 31(6) of the Highways Act 1980 and section 15A(1) of the Commons Act 2006

Please read the following guidance carefully before completing the form

1. *Guidance relating to completion of this form is available from <http://www.defra.gov.uk/rural/protected/greens/>. Please refer to these separate notes when completing this form.*
2. *Parts A and F must be completed in all cases.*
3. *The form must be signed and dated by, or by a duly authorised representative of, every owner of land to which the application relates who is an individual, and by the secretary or some other duly authorised officer of every owner of land to which the application relates which is a body corporate or an unincorporated association.*
4. *In the case of land in joint ownership all the joint owners must complete paragraphs 2 and 3 of Part A and complete and sign the application in Part F, unless a duly authorised representative completes and signs the form on behalf of all of the owners of the land. Paragraph 3 should be completed in full to clearly explain the capacity of each applicant e.g. trustee, landowner's managing agent, executor.*
5. *"Owner" is defined in section 61(3) of the Commons Act 2006 and sections 31(7) of the Highways Act 1980 and means, broadly, a legal owner of the freehold interest in the land.*
6. *Where the application relates to more than one parcel of land, a description of each parcel should be included in Paragraph 4 of Part A and the remainder of the form should be completed to clearly identify which statement and/or declaration relates to which parcel of land. This may require the insertion of additional wording. See separate notes for further guidance. Multiple parcels of land should be clearly identified by coloured edging on any accompanying map.*
7. *Where a statement or declaration requires references to colouring shown on an accompanying map or previously lodged map, the colouring must be clearly specified and must match that shown on the relevant map. For example, if a footpath is specified in a Part C declaration as shown coloured brown, the accompanying map or previously deposited map referred to must reflect that colouring.*
8. *An application must be accompanied by an ordnance map, or (in respect of declarations under Part C or statements under Part D of this form) refer to a map previously deposited in accordance with the Commons (Registration of Town or Village Greens) and Dedicated Highways (Landowner Statements and Declaration) (England) Regulations 2013 or (if deposited before 1st October 2013) in accordance with section 31(6) of the Highways Act 1980. Any accompanying map must be an ordnance map at a scale of not less than 1:10,560 showing the boundary of the land to which the application relates in coloured edging.*
9. *An application must be accompanied by the requisite fee - please ask the appropriate authority for details.*

10. "Appropriate authority" means (a) in relation to a map or statement deposited or declaration lodged under section 31(6) of that Act, an appropriate council (as defined in section 31(7) of the Highways Act 1980); and (b) in relation to a statement and map deposited under section 15A(1) of the 2006 Act, a commons registration authority (defined in section 4 of the Commons Act 2006 and section 2 of the Commons Registration Act 1965). In practice, the appropriate council and commons registration authority will usually be the same body.

**PART A: Information relating to the applicant and land to which the application relates
(all applicants must complete this Part)**

1. Name of appropriate authority to which the application is addressed:

Hampshire County Council

2. Name and full address (including postcode) of applicant:

Alexander Welch
Flat 100, Maltings Place
169 Tower Bridge Road
London
SE1 3LJ

3. Status of applicant (tick relevant box or boxes):

I am

(a) the owner of the land(s) described in paragraph 4.

(b) making this application and the statements/declarations it contains on behalf of [insert name of owner] who is the owner of the land(s) described in paragraph 4 and in my capacity as [insert details].

4. Insert description of the land(s) to which the application relates (including full address and postcode):

Land at Humbers Farm, Ashford Hill, Thatcham, RG19 8BL & Land at Dairy House, Ashford Hill. Thatcham, RG19 8BL

5. Ordnance Survey six-figure grid reference(s) of a point within the area of land(s) to which the application relates (if known):

Grid reference: SU54816092

6. This deposit comprises the following statement(s) and/or declarations (delete Parts B, C, or D where not applicable):

C

PART C: Declaration under section 31(6) of the Highways Act 1980

1. I am the owner of the land described in paragraph 4 of Part A of this form and shown edged red on the maps lodged with Hampshire County Council on 25 day of August 2022.

2. On the 25 day of August 2022 I deposited with Hampshire County Council being the appropriate council, a statement accompanied by maps showing my property edged red

which stated that:

the way shown with a purple solid line on those maps is a footpath and is numbered on the Definitive Map as 007/732/1.

no other ways had been dedicated as public rights of way or highways over my property.

3. No additional ways have been dedicated over the land edged red on the maps referenced in paragraph 1 above since the statement dated the 16 day of August 2022 referred to in paragraph 2 above other than the footpath marked in the appropriate colour on the maps reference in paragraph 1 above and at the present time I have no intention of dedicating any more public rights of way or highways over my property.

PART E: Additional information relevant to the application
(insert any additional information relevant to the application)

N/A

PART F: Statement of Truth
(all applicants must complete this Part)

WARNING: If you dishonestly enter information or make a statement that you know is, or might be, untrue or misleading, and intend by doing so to make a gain for yourself or another person, or to cause loss or the risk of loss to another person, you may commit the offence of fraud under section 1 of the Fraud Act 2006, the maximum penalty for which is 10 years' imprisonment or an unlimited fine, or both.

I BELIEVE THAT THE FACTS AND MATTERS CONTAINED IN THIS FORM ARE TRUE

Signature (of the person making the statement of truth): 

Print full name: Alexander Welch

Date: 26.09.2022

You should keep a copy of the completed form

Data Protection Act 1998 - Fair Processing Notice

The purpose of this Fair Processing Notice is to inform you of the use that will be made of your personal data, as required by the Data Protection Act 1998.

The appropriate authority (see explanation of definition in above guidance notes) in England is the data controller in respect of any personal data that you provide when you complete this form.

The information that you provide will be used by the appropriate authority in its duties to process applications to deposit statements, maps and declarations under section 31(6) the Highways Act 1980 and statements under section 15A(1) of the Commons Act 2006. The information you provide will also be used by the appropriate authority in its duty to update the registers in which details of such deposits are recorded under the Dedicated Highways (Registers under Section 31A of the Highways Act 1980) (England) Regulations 2007 and the Commons (Registration of Town or Village Greens) and Dedicated Highways

(Landowner Statements and Declarations) (England) Regulations 2013.

The appropriate authority is required by the legislation above to maintain a register which holds information provided in this form, which can be inspected online or in person by members of the public on request. It may also be required to release information, including personal data and commercial information, on request under the Environmental Information Regulations 2004 or the Freedom of Information Act 2000. However, the appropriate authority will not permit any unwarranted breach of confidentiality nor will they act in contravention of their obligations under the Data Protection Act 1998.

Form CA16

Application Form for deposits under section 31(6) of the Highways Act 1980 and section 15A(1) of the Commons Act 2006

Please read the following guidance carefully before completing the form

1. *Guidance relating to completion of this form is available from <http://www.defra.gov.uk/rural/protected/greens/>. Please refer to these separate notes when completing this form.*
2. *Parts A and F must be completed in all cases.*
3. *The form must be signed and dated by, or by a duly authorised representative of, every owner of land to which the application relates who is an individual, and by the secretary or some other duly authorised officer of every owner of land to which the application relates which is a body corporate or an unincorporated association.*
4. *In the case of land in joint ownership all the joint owners must complete paragraphs 2 and 3 of Part A and complete and sign the application in Part F, unless a duly authorised representative completes and signs the form on behalf of all of the owners of the land. Paragraph 3 should be completed in full to clearly explain the capacity of each applicant e.g. trustee, landowner's managing agent, executor.*
5. *"Owner" is defined in section 61(3) of the Commons Act 2006 and sections 31(7) of the Highways Act 1980 and means, broadly, a legal owner of the freehold interest in the land.*
6. *Where the application relates to more than one parcel of land, a description of each parcel should be included in Paragraph 4 of Part A and the remainder of the form should be completed to clearly identify which statement and/or declaration relates to which parcel of land. This may require the insertion of additional wording. See separate notes for further guidance. Multiple parcels of land should be clearly identified by coloured edging on any accompanying map.*
7. *Where a statement or declaration requires references to colouring shown on an accompanying map or previously lodged map, the colouring must be clearly specified and must match that shown on the relevant map. For example, if a footpath is specified in a Part C declaration as shown coloured brown, the accompanying map or previously deposited map referred to must reflect that colouring.*
8. *An application must be accompanied by an ordnance map, or (in respect of declarations under Part C or statements under Part D of this form) refer to a map previously deposited in accordance with the Commons (Registration of Town or Village Greens) and Dedicated Highways (Landowner Statements and Declaration) (England) Regulations 2013 or (if deposited before 1st October 2013) in accordance with section 31(6) of the Highways Act 1980. Any accompanying map must be an ordnance map at a scale of not less than 1:10,560 showing the boundary of the land to which the application relates in coloured edging.*
9. *An application must be accompanied by the requisite fee - please ask the appropriate authority for details.*

10. "Appropriate authority" means (a) in relation to a map or statement deposited or declaration lodged under section 31(6) of that Act, an appropriate council (as defined in section 31(7) of the Highways Act 1980); and (b) in relation to a statement and map deposited under section 15A(1) of the 2006 Act, a commons registration authority (defined in section 4 of the Commons Act 2006 and section 2 of the Commons Registration Act 1965). In practice, the appropriate council and commons registration authority will usually be the same body.

**PART A: Information relating to the applicant and land to which the application relates
(all applicants must complete this Part)**

1. Name of appropriate authority to which the application is addressed:

Hampshire County Council

2. Name and full address (including postcode) of applicant:

Alexander Welch
Flat 100, Maltings Place
169 Tower Bridge Road
London
SE1 3LJ

3. Status of applicant (tick relevant box or boxes):

I am

(a) the owner of the land(s) described in paragraph 4.

(b) making this application and the statements/declarations it contains on behalf of [insert name of owner] who is the owner of the land(s) described in paragraph 4 and in my capacity as [insert details].

4. Insert description of the land(s) to which the application relates (including full address and postcode):

Land at Humbers Farm, Ashford Hill, Thatcham, RG19 8BL & Land at Dairy House, Ashford Hill, Thatcham, RG19 8BL

5. Ordnance Survey six-figure grid reference(s) of a point within the area of land(s) to which the application relates (if known):

Grid reference: SU54816092

6. This deposit comprises the following statement(s) and/or declarations (*delete Parts B, C, or D where not applicable*):

B

PART B: Statement under section 31(6) of the Highways Act 1980

I am the owner of the land described in paragraph 4 of Part A of this form and shown edged red on the maps accompanying this statement.

The way shown with a purple solid line on the accompanying maps is a public footpath, and numbered on the Definitive Map as 007/732/1

No other ways over the land shown edged red on the accompanying maps have been dedicated as highways.

PART E: Additional information relevant to the application
(insert any additional information relevant to the application)

N/A

PART F: Statement of Truth
(all applicants must complete this Part)

WARNING: If you dishonestly enter information or make a statement that you know is, or might be, untrue or misleading, and intend by doing so to make a gain for yourself or another person, or to cause loss or the risk of loss to another person, you may commit the offence of fraud under section 1 of the Fraud Act 2006, the maximum penalty for which is 10 years' imprisonment or an unlimited fine, or both.

I BELIEVE THAT THE FACTS AND MATTERS CONTAINED IN THIS FORM ARE TRUE

Signature (of the person making the statement of truth):

Print full name: Alexander Welch 

Date: 16/08/22 

You should keep a copy of the completed form

Data Protection Act 1998 - Fair Processing Notice

The purpose of this Fair Processing Notice is to inform you of the use that will be made of your personal data, as required by the Data Protection Act 1998.

The appropriate authority (see explanation of definition in above guidance notes) in England is the data controller in respect of any personal data that you provide when you complete this form.

The information that you provide will be used by the appropriate authority in its duties to process applications to deposit statements, maps and declarations under section 31(6) the Highways Act 1980 and statements under section 15A(1) of the Commons Act 2006. The information you provide will also be used by the appropriate authority in its duty to update the registers in which details of such deposits are recorded under the Dedicated Highways (Registers under Section 31A of the Highways Act 1980) (England) Regulations 2007 and the Commons (Registration of Town or Village Greens) and Dedicated Highways (Landowner Statements and Declarations) (England) Regulations 2013.

The appropriate authority is required by the legislation above to maintain a register which holds information provided in this form, which can be inspected online or in person by members of the public on request. It may also be required to release information, including personal data and commercial information, on request under the Environmental Information Regulations 2004 or the Freedom of Information Act 2000. However, the appropriate authority will not permit any unwarranted breach of confidentiality nor will they act in

HM Land Registry
Official copy of
title plan

Ordnance Survey map reference [REDACTED]
Scale **1:2500**
Administrative area **Hampshire :**
Basingstoke and Deane

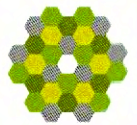

© Crown copyright and database rights 2021. Ordnance Survey 100026316. You are not permitted to copy, sub-license, distribute or sell any of this data to third parties in any form.

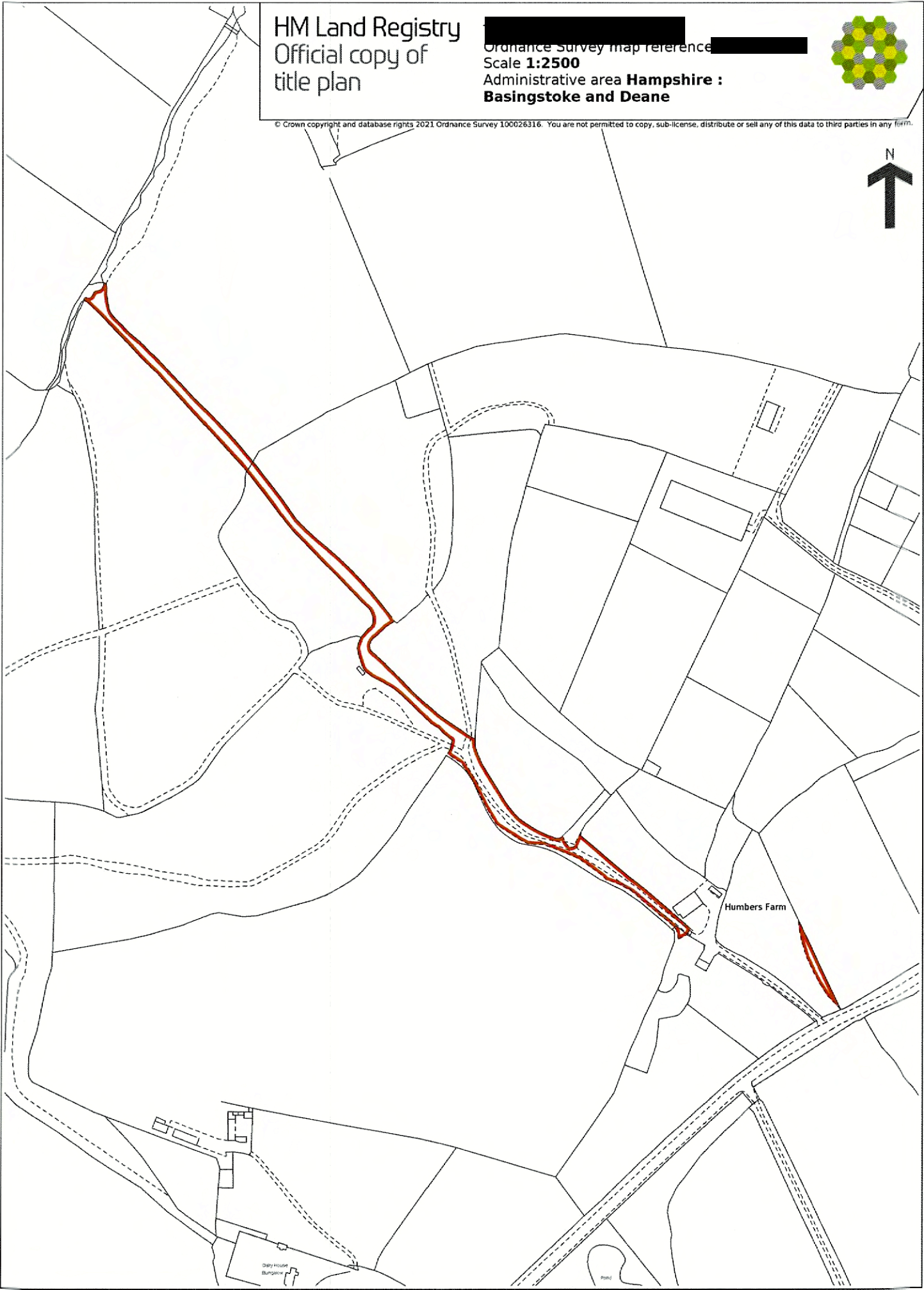

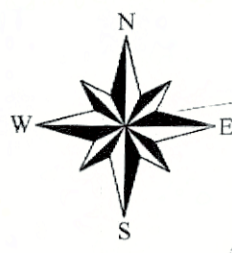

Dairy House, Ashford Hill, Kingsclere, Hampshire

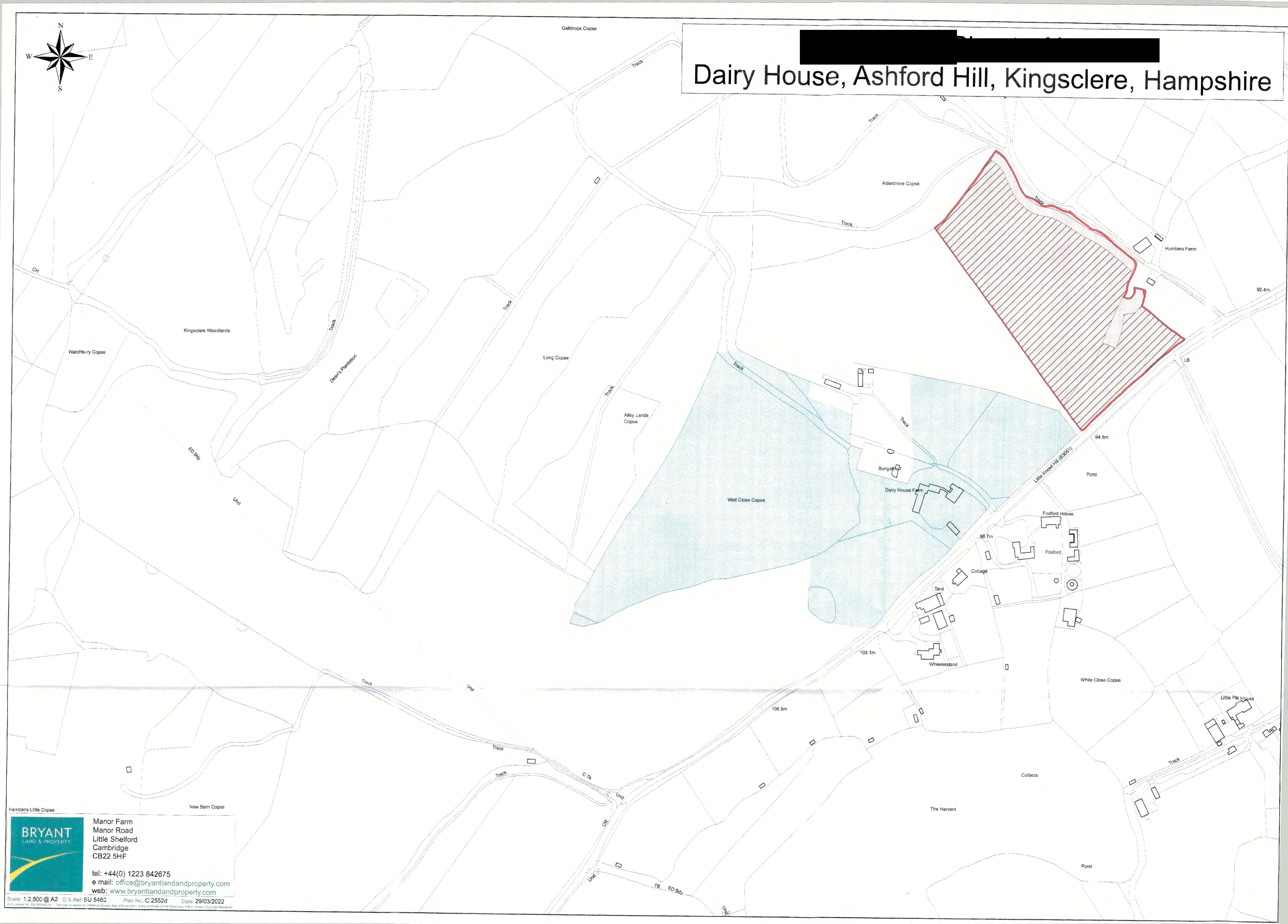

Harridens Little Copse
New Barn Copse

BRYANT
LAND & PROPERTY

Manor Farm
Manor Road
Little Shelford
Cambridge
CB22 5HF

tel: +44(0) 1223 842675
e mail: office@bryantlandandproperty.com
web: www.bryantlandandproperty.com

Land at Humbers Farm

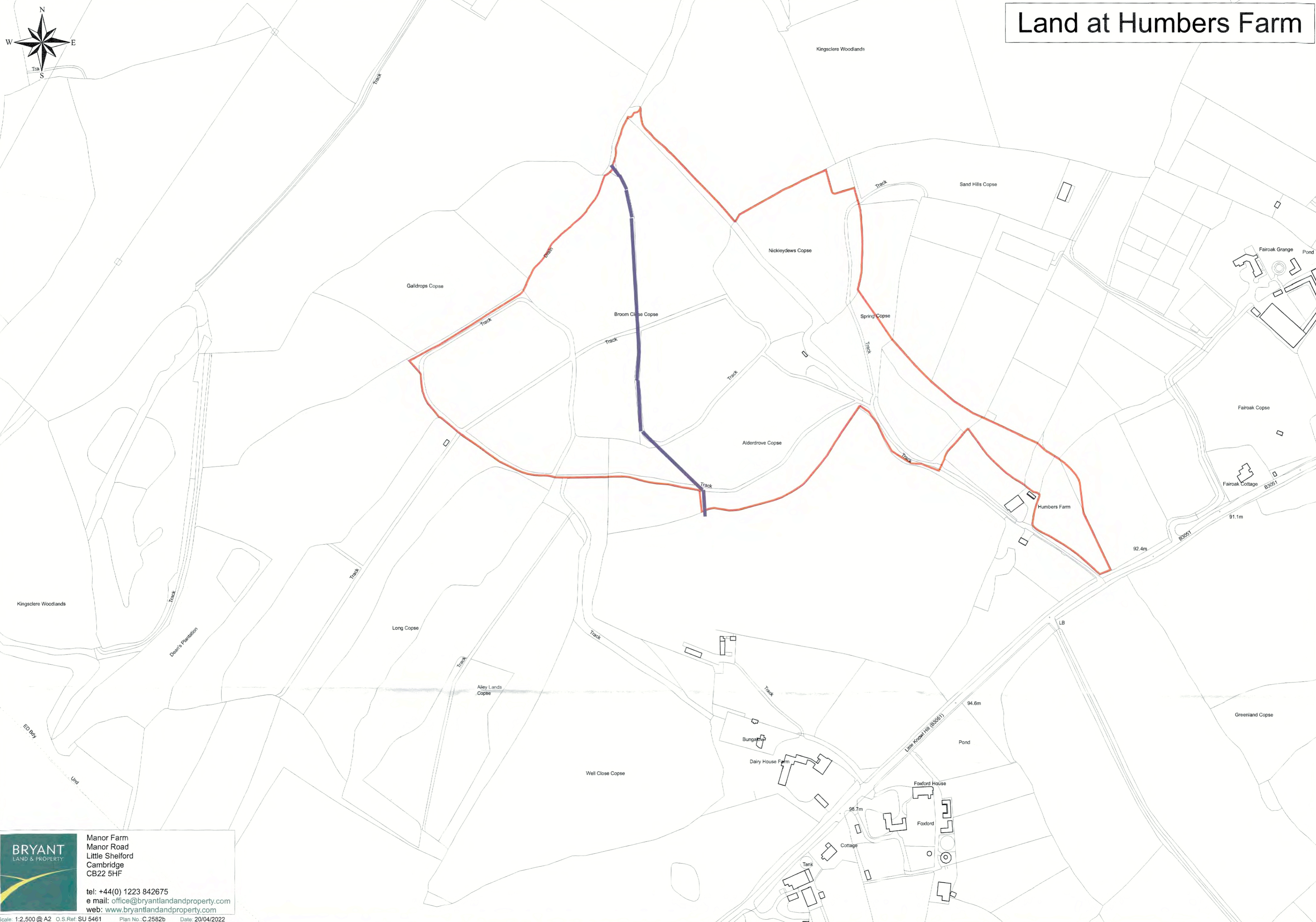

BRYANT
LAND & PROPERTY

Manor Farm
Manor Road
Little Shelford
Cambridge
CB22 5HF

tel: +44(0) 1223 842675
e mail: office@bryantlandandproperty.com
web: www.bryantlandandproperty.com

Scale: 1:2,500 @ A2 O.S.Ref: SU 5461 Plan No.: C.2582b Date: 20/04/2022
© S. Licence No. E810048270 This plan is based on Ordnance Survey data with sanction of the controller of Her Majesty's Stationery Office. Crown Copyright Reserved

Landowner Deposit 674 Land at Humbers Farm and Land at Dairy House

1:5,000



RIGHTS OF WAY OFFICE

- Footpath —
 - Bridleway —
 - Restricted Byway - - - -
 - Byway Open to All Traffic —
 - Parish Boundary (O.S. data) • • • •
- One or more of these line notations will appear on the map

© Crown copyright and database rights 2022 Ordnance Survey [100019180]. You are permitted to use this data solely to enable you to respond to, or interact with, the organisation that provided you with the data. You are not permitted to copy, sub-licence, distribute or sell any of this data to third parties in any form.

