

Icknield School
10 pupil place expansion and facilities upgrade

Special School - Ages 3-19 (78)

Proposed Site Plan

Key:

- 1. Reception & Waiting
- 2. General Office
- 3. Head Teacher
- 4. Staff Room
- 5. WCs
- 6. Kitchen & Servery
- 7. Plant & Non-teaching Stores
- 8. Hall
- 9. Classrooms - Nursery / Reception
- 10. Classrooms - General
- 11. Learning Resource / Library
- 12. Specialist Practical
- 13. Studio/ Small Hall/ Music & Drama
- 14. Small Group Room (SEN)
- 15. ICT Suite
- 16. Car Park
- 17. Play Equipment
- 18. Hard Play
- 19. Soft Play
- 20. Habitat
- 21. Pitch

■ General Teaching - New Build

■ General Teaching - Refurb.

■ Non-Teaching - New Build

■ Non-Teaching - Refurb.

■ Circulation

 Landscape Alterations

▶ Existing Pedestrian Access

▶ Existing Vehicular Access

 Site Boundary

North



0 25 M

1:500 @ A3

P12690.SK.05 Rev D

September 2020

Notes

1 This drawing is © copyright Hampshire County Council 2020. No unauthorised reproduction permitted. All rights reserved.

2 No dimensions are to be scaled from this drawing

3 This map is reproduced from Ordnance Survey material with the permission of Ordnance Survey on behalf of the controller of Her Majesty's Stationery Office © Crown Copyright. Unauthorised reproduction infringes Crown Copyright and may lead to prosecution or civil proceedings. (100019180), (2020)

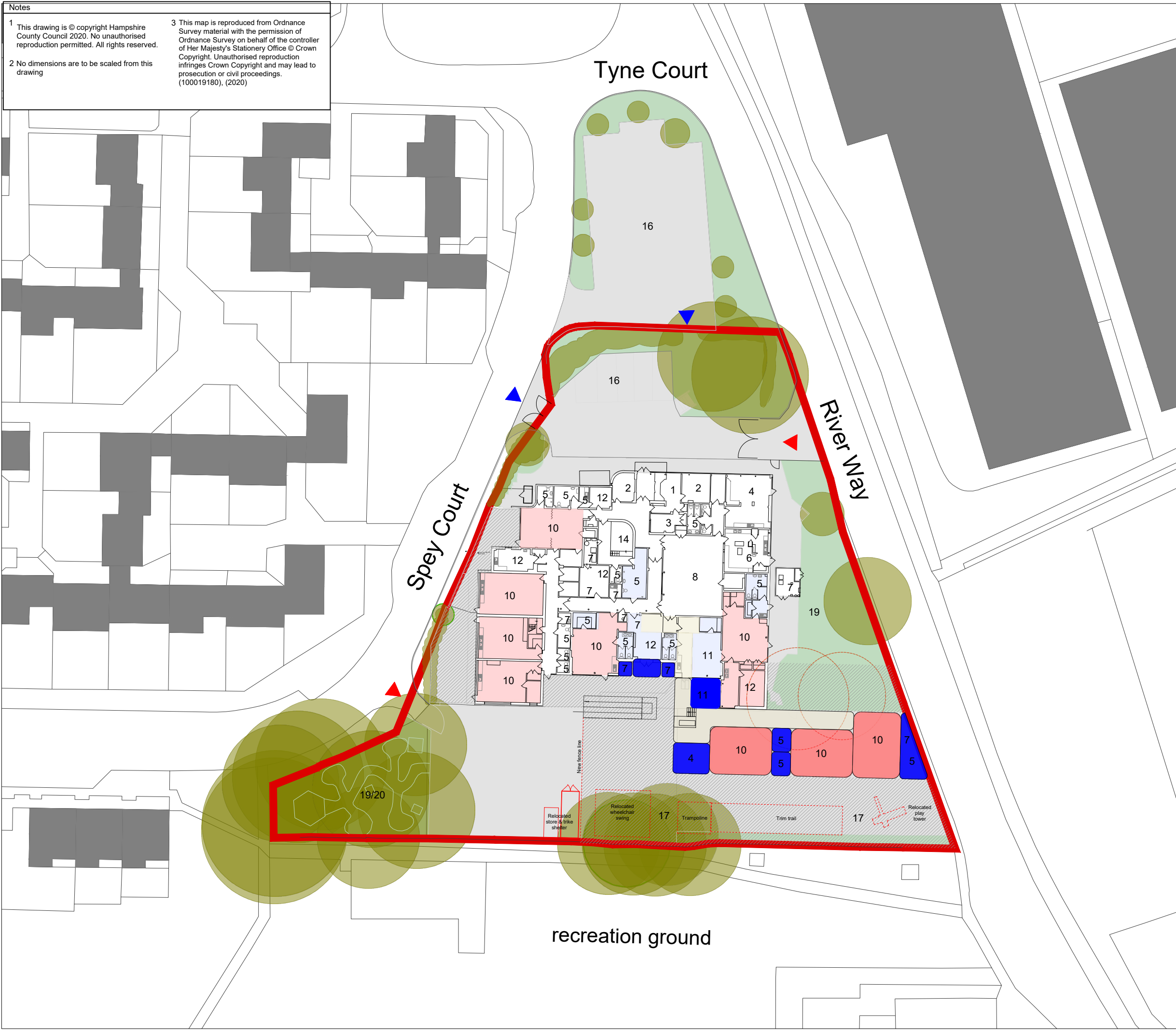

recreation ground