



## Basingstoke Canal Dry Dock - Information Pack



## Introduction

Basingstoke Canal Authority have 1 dry dock facility available on the canal, which is available to hire for short term boat maintenance.

## Location

Adjacent to Frimley Top Lock (number 28), Deepcut, Camberley, Surrey GU16 6RR

Link to view on Google maps: <https://maps.app.goo.gl/Q8ac1x6GYFWQ4YHF7>

## Fees

Dry dock hire: £56.50 per day

Key to electricity cupboard and upper paddle: £25.00 per hire period – returnable on completion of hire

Visiting boats - Navigation fee: £58.00 for 8 days or £84.00 for 11 days, inclusive of lock use

All payments are due in full at the time of booking. Please refer to Terms & Conditions for further details

The navigation fee is applicable for boats arriving from the Wey, transiting to the Dry Dock and back. Navigation days exclude the days booked in the Dry Dock.

Alternatively, for boats moored on the Canal below Lock 15 (who have not opted for annual lock usage) must book passage, and pay a lock usage fee.

## Health and Safety

It is the responsibility of every individual carrying out work in the dry dock to assess the risks associated with their activities. It is the hirer or user of this docks responsibility to carry out a risk assessment, and to ensure all necessary precautionary measures are in place for their activities.

Be aware of:

- Unprotected edges and falls from height
- Slip, trip and fall hazards

Ensure:

- Personal protective equipment is used at all times
- All work equipment is fit for use
- When lifting, correct manual lifting techniques are used

A useful guide can be downloaded from the Canal and Rivers Trust with further information: [0189917e-e90a-714e-ab14-fb3c6503ac7c.pdf](#)

Facilities available	Description	Restrictions	User requirements
<b>Dry dock</b>	Gate width: 13.50 ft Width of lock chamber: 18.05 ft Length of lock chamber: 72.10 ft	Request for bookings made via the website: <a href="#">Dry Dock   Things to do in Hampshire   Hampshire County Council</a>	Ladders and work platforms are not provided – users to supply their own.  Copies of certificate of insurance and boat safety certificate essential and must be emailed at time of booking.
<b>Lock gates</b>	Once the vessel is in position and the user has emptied the Dry Dock, the lock gates will be caulked up to prevent water leaking, thus providing the user with a Dry Dock.	A member of the Basingstoke Canal Authority’s (BCA) team will arrange to meet users on the first day of hire, but please note this may not be immediately after the boat has entered the dock.	A key can be hired (for £25) that will enable the user to open the upper paddle in the Dry Dock.
<b>Polytunnel cover</b>	There is a cover over the Dry Dock. However, it is only of a plastic “poly tunnel” material. <b>Please note this is not fully waterproof.</b>	Users must be extremely careful if welding on the top of boats as stray sparks could puncture the cover. Similarly, <b>solid fuel stoves must not be lit when the boat is in the Dry Dock.</b>	
<b>Electricity supply</b>	A thirteen amp (240-volt) electric supply is located in a galvanised metal cabinet (on your immediate left as looking at the Dry Dock)	<b>Only</b> a 110-volt supply may be used The cabinet is accessible via a key, which can be hired for £25 for the duration of the hire period.	Users <b>must</b> supply their own 110-volt transformers and suitable tools, leads etc. If possible, please use battery tools.

Facilities available	Description	Restrictions	User requirements
<b>Water taps</b>	Two available		Users to supply their own buckets, hose pipes etc.
<b>Supports</b>	The Dry Dock floor has supporting flat I-beams to allow access under a vessel. Flat bottom and U-shaped hulls will rest on these. Please see page 11 and 12 for details.	Vessels with V-shaped hulls will require additional supports.	If your vessel has a V shaped hull you will need to provide your own timbers or props to support the vessel safely when the Dry Dock is drained.
<b>Access</b>	Access is via the MOD road, secured with a locked barrier, accessible via a combination code padlock. Please see the maps on page 10 and 11.	This track is a shared access so due care and attention should be exercised when passing oncoming traffic and pedestrians.	Please observe a speed limit of 10mph on this track
<b>Parking</b>	There is a small area where a maximum of two vehicles can be parked adjacent to the Dry Dock.		Please be mindful of the pedestrian access route when parking vehicles

## Terms and Conditions

### Accessing the Dry Dock:

Hire time starts on the day of entry into the Dry Dock and ends of the day of exit, regardless of the time of entry and departure.

### Booking:

Payment is required in full along with the completed application form (and accompanying paperwork) at the time of booking. Please note the first day's hire is a non-refundable booking fee.

If there are multiple boats included in one booking, a booking form must be completed for each boat. The hirer must also give a minimum of 24 hours' notice to the Canal Office (during office hours) to arrange for the caulking up of the Dry Dock when the second boat goes in.

### Key deposit:

- **Picking up of key**

A key may be collected from the Canal Office by pre-arranged appointment. A refundable deposit of £25 must be provided when the key is collected. We can currently only accept cash deposits.

- **Returning of key**

- The key must be returned on the day of departure from the Dry Dock or the following day.
- If the key is being returned out of office hours, it can be posted through the letterbox (located on the front door of the Canal Centre). This is only possible if the deposit was paid by card (refunds can be issued over the phone on the next working day). The key must not be returned by mail. Deposits can only be collected from the Canal Office by pre-arranged appointment.

- **Non return of key**

If the key is not returned by the following day, then this may result in the loss of the £25 key deposit.

### Cancellation/Refunds:

Cancellations made and received at least 28 days in advance, a full refund less a non-refundable booking fee will be offered. For 2 weeks' notice a 50% refund less the non-refundable booking fee will be offered. Notice of less than 2 weeks will result in a loss of the whole booking fee. A full

refund will be offered if the BCA cancels the booking. Cancellations must be in writing.

### **Penalties:**

Hirers are required to vacate the Dry Dock promptly at the end of their booked period. For boats which are watertight / with dry paint below waterline then, taking due care and attention, the BCA may refill the Dry Dock and remove the boat so that the next hirer can access the facility. The boat removed will be moored on the towpath side and the Boat Owner will be expected to return it to its home mooring (or off canal as appropriate) within 72 hours. Where BCA staff exercise due care, the BCA are not liable for damages caused to the boat including to incomplete works caused by the boats' condition. Where the BCA have to remove a boat at the end of a hire, we reserve the right to charge the overstaying hirer the cost of cleaning the Dry Dock of their debris prior to refilling (staff or contractor time plus waste disposal costs), plus a penalty of 3 x a day's hire.

Where incomplete works do not allow a boat to be removed from the Dry Dock at the end of a booked period a penalty will be incurred by the hirer where a boat has to remain in the Dry Dock beyond the end of their booking. For each additional day the hirer remains in the Dry Dock after the end of their booking a charge of 3 times the daily rate will be applied per any part of an additional day used, PLUS a penalty equivalent to 3 x a days' hire.

Where a following hirer is affected by such a delay the next hirer affected will receive a refund for the equivalent days that affects their hire plus a nominal sum for inconvenience paid from the late hirer's penalty charges.

The BCA are not liable for any costs incurred by hirers arising from their use of the Dry Dock facility.

### **Boating Terms and Conditions:**

Visiting boats using the Dry Dock are deemed to have read and accepted the Basingstoke Canal Boating Terms and Conditions. This covers areas such as licensing, boat safety and insurance.

### **Biosecurity:**

Visiting boaters and canal annual licence holders must check and fully clean their weed hatch and rudder for all plant matter before proceeding west of Lock 7 (St Johns). This is to stop the spread of the invasive plant floating pennywort.

During operations to clean and repair a boat hull in the Dry Dock, the Boat Owner must notify the BCA duty ranger immediately if they find invasive species such as Zebra Mussel adhering to the hull. These must be carefully removed, bagged, and disposed of in an appropriate manner as advised by the Duty Ranger; **under no circumstances may they be flushed through the Dry Dock sluice.**

### **Working time restrictions:**

Any noisy activities in the Dry Dock are to be restricted as follows; Monday through Friday 9am – 4pm and Saturday morning 9am – 1pm. No noisy activities are allowed outside these hours. (In addition, Noisy activities are not allowed on Sundays or Bank Holidays. Non noisy activities (such as painting, mechanical repairs) can be carried out at all other times.

### **Noisy Activities:**

Noisy activities can be considered as anything that creates a sound more than 5db above background sound levels, recorded at the nearest neighbouring property. Sound readings have shown this to include:

- Angle Grinding
- Banging of metal hull and metal fabrication, also mechanical works requiring banging, such as freeing of seized bolts
- Electric Sanders and use of other electric tools.
- Pressure washing
- Use of a generator
- Angle Grinding and Hull banging are particularly noisy. These activities should be restricted to a 15-minute period during any one hour.

These actions will only take place during the “Noisy Activity” times described above.

### **Nature of work:**

BCA will ascertain the nature of work intended by each user booking the Dry Dock. Any work planned over and above the typical sand down and repainting with minor repairs will be assessed for its ability to cause noise disturbance. In these instances, the BCA will work with users to develop a reasonable and practicable work plan.

### **Use of equipment:**

The use of any radios or other similar musical equipment will be allowed but should only be at a volume that is not audible from the Canal towpath opposite. Particularly, equipment should not be turned up, so it is audible above the noise of power tools etc.

The BCA will retain the right to carry out or authorise noisy activities in the Dry Dock at other times when repairs are required for emergency reasons.

**Cleaning Up:**

When emptied, the Dry Dock sluice ejects all the water plus anything else in the Dry Dock into the canal, below Lock 28. Likewise, when you re-flood the Dry Dock to leave, anything you left behind will go straight into the Canal. The Canal is a designated SSSI, and it is against the law to pollute it. Therefore, all your oil and paint spills, shot-blasted paint and other detritus must be cleared and swept up before you leave. You must take your waste away with you.

**Behaviour:**

The BCA will not tolerate any abusive or aggressive behaviour to staff, volunteers, or members of the public from the Boat Owner and/or designated skipper or any person associated with the boat.

**Breach of terms and conditions:**

Any individual found to be breaching these conditions (and our Boating Terms and Conditions) will have to stop work immediately, ejected from the premises and will be banned from any future use of the Dry Dock.

Failures in relation to noise and pollution may result in a regulator (Environment Agency, Guildford Borough Council) fining the hirer.

# Access map for vehicles to Dry Dock

Scale: 1:5,000

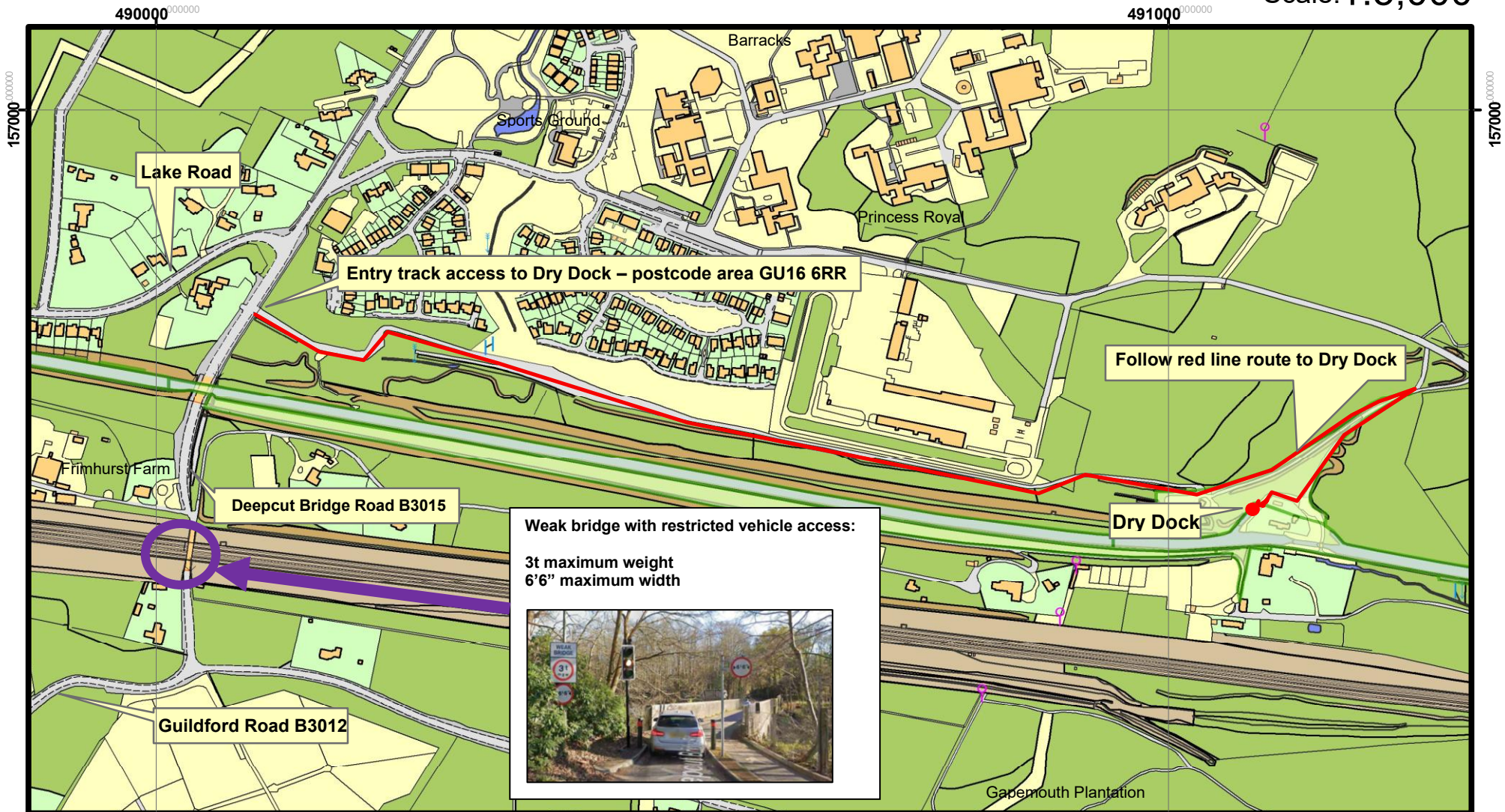

This map is reproduced from Ordnance Survey material with the permission of Ordnance Survey on behalf of the Controller of Her Majesty's Stationery Office © Crown copyright. Unauthorised reproduction infringes Crown copyright and may lead to prosecution or civil proceedings. HCC 100019180 2009



491000<sup>000000</sup>

Prepared by: L Cottrell  
 Basingstoke Canal Authority  
 Date: 09/02/2023

# Dry Dock: Detailed map

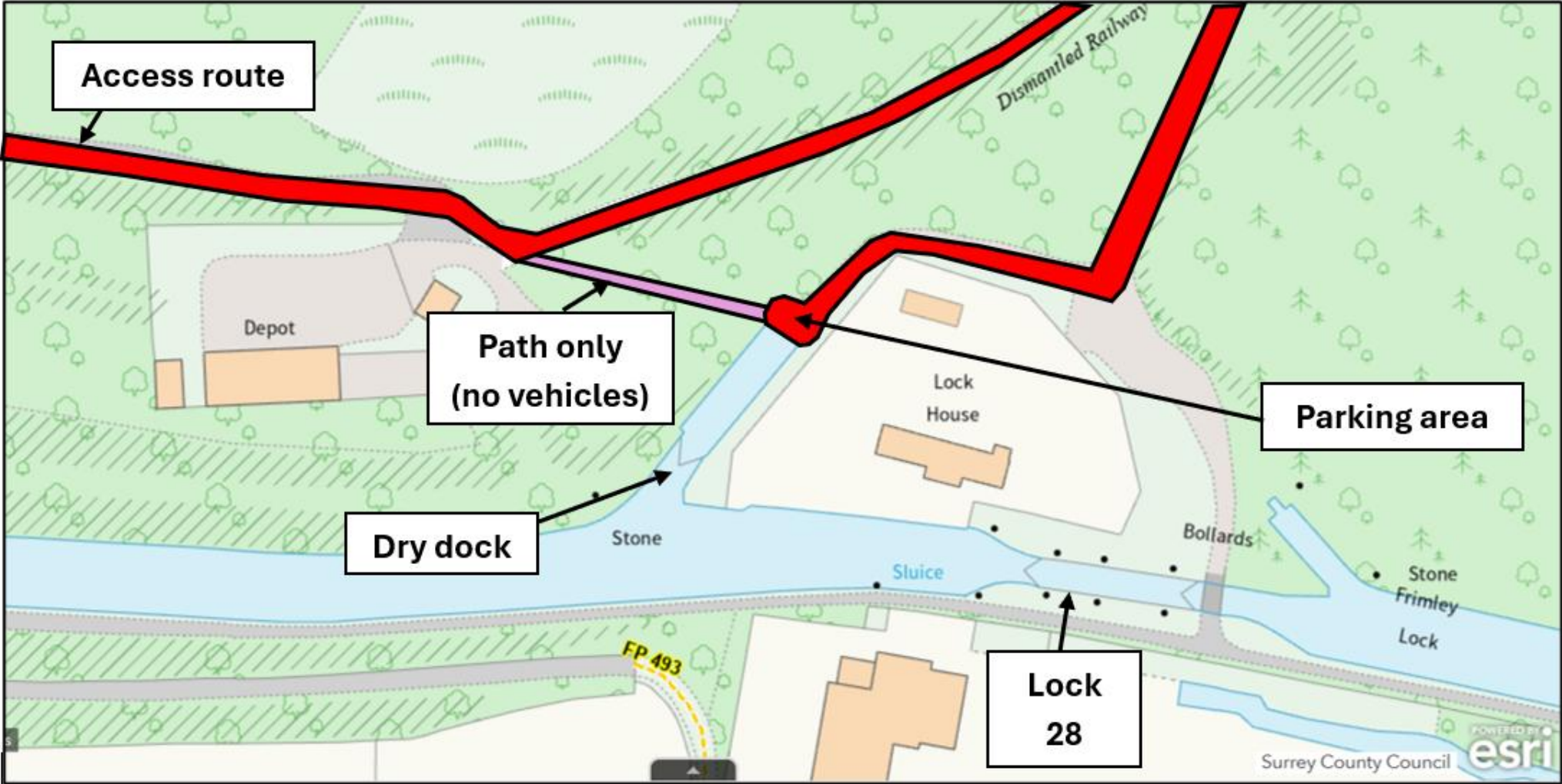

**Dry Dock – view from the bankside, looking along the length of the chamber to the lock gates and canal**



## Dry Dock – dimensions and supports

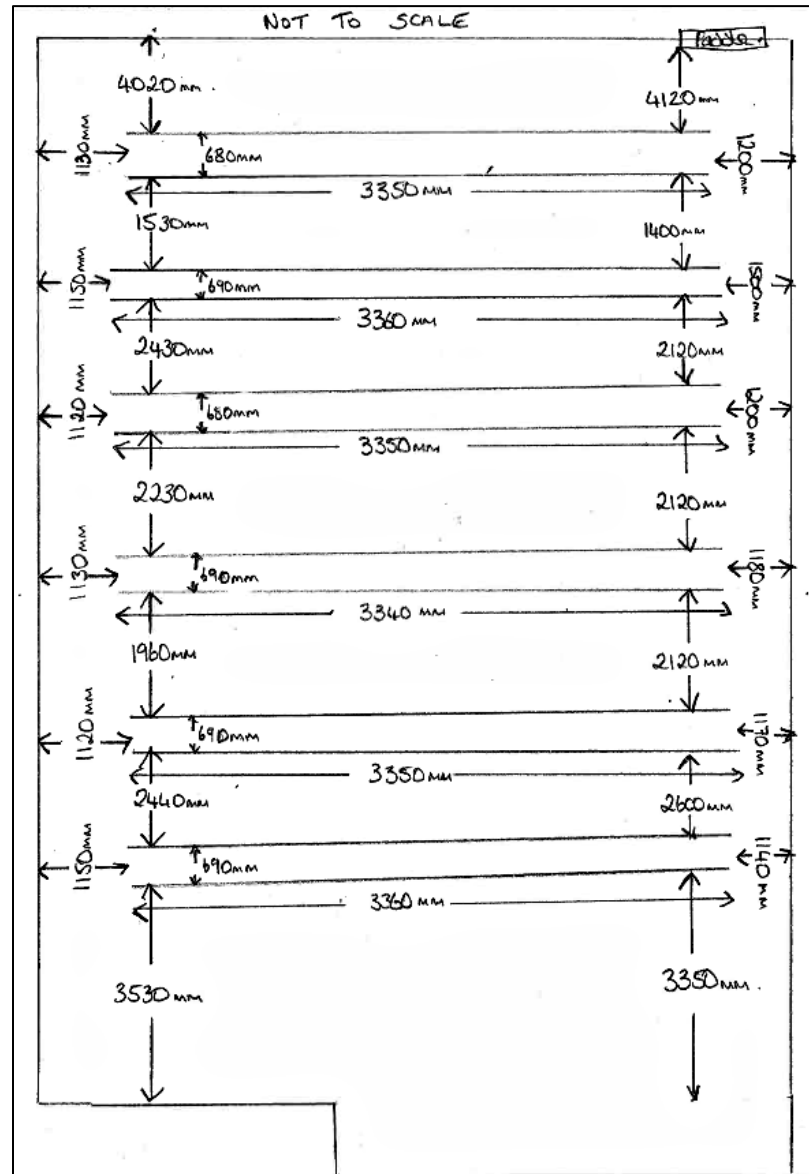

**Width of lock chamber:**  
**18.05 ft**  
**5,639 mm**

**Length of lock chamber:**  
**72.10 ft**  
**21,976 mm**

**Gate width:**  
**13.50 ft**  
**4,115mm**

If you have any questions, please contact the Canal Office:

**Canal Office hours:**

**Monday to Friday  
09:00 – 16:30**

**In person visits by prior arrangement only**

To book a passage call the Canal Office on 01252 370073 by 3.00pm on the day prior to your intended travel. Please note the lock operation times below. We are unable to open the flights of locks outside of this timetable. Please note the Canal Office is no longer open at weekends, so you must book by 3pm on Friday if you wish to travel through the locks at the weekend.

Canal Centre  
Mytchett Place Road  
Mytchett  
Surrey  
GU16 6DD

Tel: 01252 370073

E-mail: [info@basingstoke-canal.co.uk](mailto:info@basingstoke-canal.co.uk)

*This page  
is left  
intentionally  
blank.*